

Proposed site section

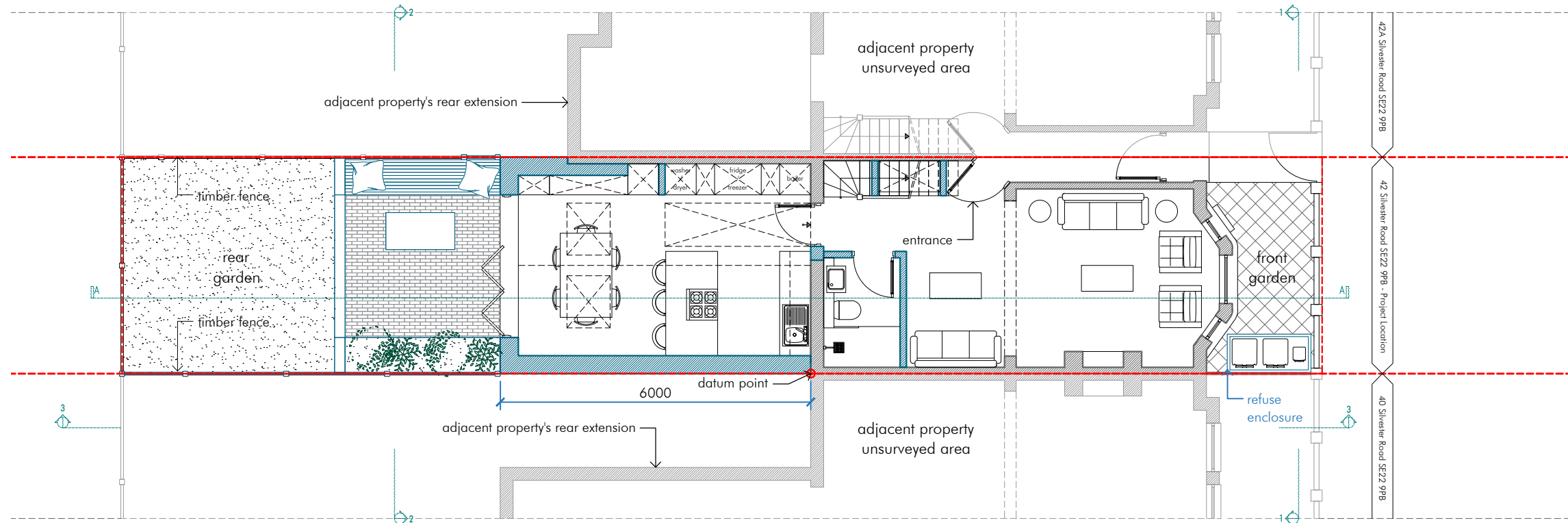

Proposed site plan

1:100



SIA Design Build

Studio 536, Salisbury House, London Wall
London, EC2M 5SQ
telephone: 07917206767
email: antonio@siadesignbuild.com
www.siadesignbuild.com

Client
Mrs Christie Hunter

Project address:
42 Silvester Road,
SE22 9PB, London, UK
Design commencement
October, 2023

Scale: 1:100@A3
Drawn: AK
Date: 24/12/23

Drawing name
GA-100-00

Drawing description
Proposed site plan

Issued for

client approval
planning
building regulation approval
tender
construction

NOTES:

- SIA DESIGN BUILD RETAIN COPYRIGHT OF DESIGN, SCHEME & OWNERSHIP OF DRAWINGS.
- DRAWING SHOULD BE READ IN CONJUNCTION WITH STRUCTURAL ENG.'S DRAWINGS.
- ANY OMISSION TO BE REPORTED TO AND CLARIFIED WITH CLIENT PRIOR TO COMMENCEMENT.
- VERIFY DIMENSIONS, LEVELS AND EXISTING STRUCTURE, ETC ON SITE PRIOR TO COMMENCEMENT.
- ALL WORKS TO COMPLY WITH CURRENT REGULATIONS, BRITISH STANDARDS ETC.
- PLEASE NOTE THAT BEFORE BUILDING WORKS COMMENCES IT IS THE RESPONSIBILITY OF THE BUILDER OR OWNER TO SERVE PARTY WALL NOTICES TO ALL NEIGHBORS.
- INITIAL DRAWINGS SUBMITTED TO BUILDING CONTROL ARE SUBJECT TO ADDITIONAL INFORMATION REQUIRED BY BUILDING CONTROL /NHBC, WHICH COULD HAVE SIGNIFICANT COST/ OR ADDITIONAL WORKS TO BE DONE ON SITE.
- ALL WORKS COMMENCED ON SITE PRIOR TO OBTAINING FULL BUILDING CONTROL APPROVAL WILL BE CARRIED OUT AT YOUR OWN RISK.