

proposed first floor. 1:100.

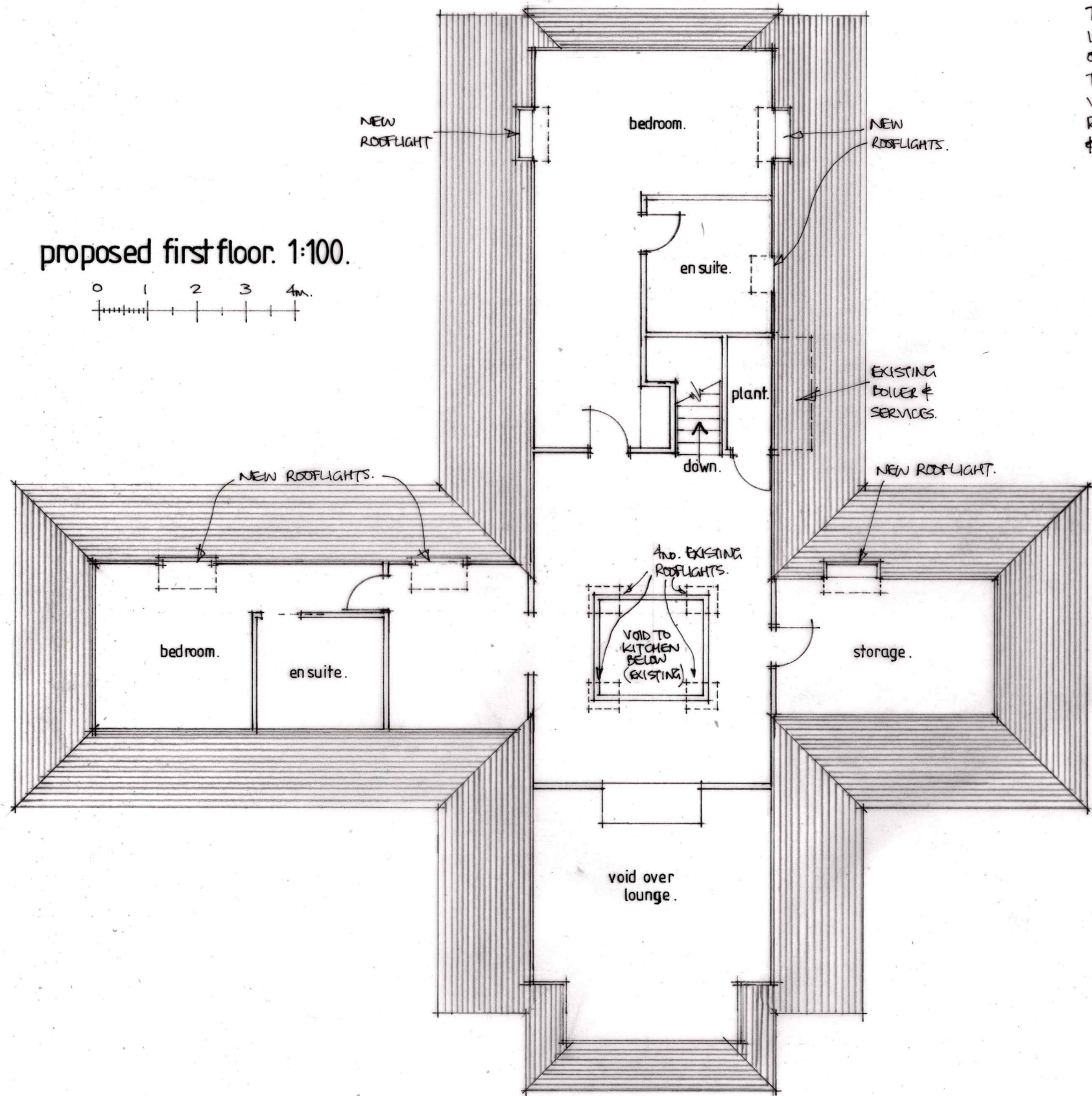
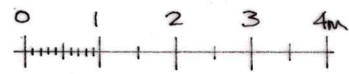

THE WHOLE OF THE ROOF STRUCTURAL FORMAT IS EXISTING. THERE WILL BE NO EXTENSION OF THE EXISTING ROOF VOLUME. THE PROPOSAL IS TO ADAPT THE EXISTING LOFT VOID AS INDICATED AND PURELY ADD NEW ROOFLIGHTS (6ND.) TO PROVIDE NATURAL LIGHTING & VENTILATION.

TREVOR J. BELL. ARCHITECTURAL SERVICES. 01420 473131.
3 CHURCH COTTAGES, BLACKMOOR, LISS, HANTS. GU33 6BW.

Alterations at Hunters Place,
Brighton Road, Medstead, Alton
GU34 5NE

T741/403. DATE: JANUARY 2024.
SCALE: 1:100 (@A3 SIZE.)