

Tawny Cottage

Summers

EI Sub Sta

A 247

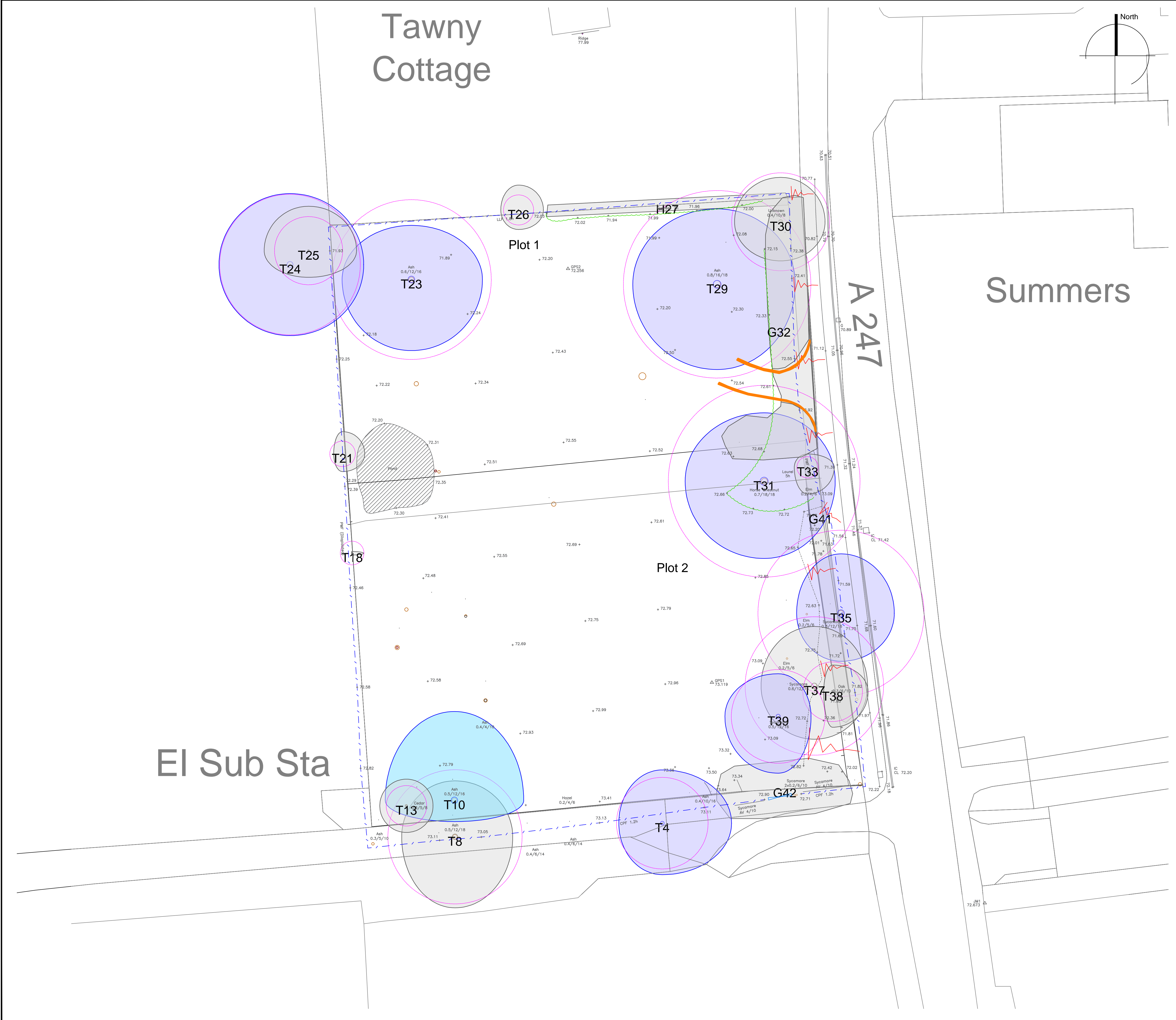

BS5837:2012 Tree Categorisation

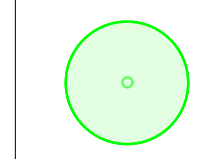
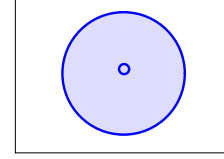
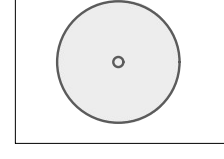
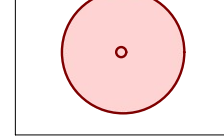
-  **A Category**
Trees of high quality with an estimated remaining life expectancy of at least 40 years
-  **B Category**
Trees of moderate quality with an estimated life expectancy of at least 20 years
-  **C Category**
Trees of low quality with an estimated life expectancy of at least 10 years, or young trees with a stem diameter below 150mm
-  **U Category**
Those in such a condition that they cannot realistically be retained as living trees in the context of the current land use for longer than 10 years

Key

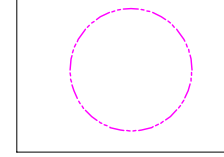
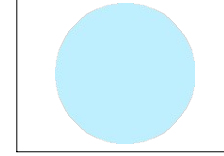
-  **Root Protection Area (RPA)**
The minimum area around a tree deemed to contain sufficient roots and rooting volume to maintain the trees viability. Where the tree is ancient the RPA follows Natural England Standing Advice 2018.
-  **Tree Proposed for removal (s 211 notification)**

Do not scale from this drawing, tree positions and dimensions should always be checked on site. The original of this drawing is in colour, do not rely on monochrome versions. This drawing is copyright Tracy Clarke Tree Consultancy Ltd ©

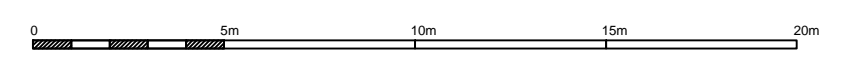

Oct 2023	B	Updated following approved s211 works
15/09/2022	A	Tree Positions updated to topographical survey
Date	Revision	Description

Title
Tree Survey for s211 Notification

Client
Dr Jeremy Harris

Site
Land South of Tawny Cottage, The Street, West Clandon, GU4 7SX

Ref: TCTC-18294-C-01	Rev: B	Scale: 1:200 @ A1
Status: Planning	Date: August 2023	Drawn By: KM



TRACY CLARKE
TREE CONSULTANCY

 01371 811831  info@tracyclarke.co.uk  www.tracyclarke.co.uk