

**Notes:**

- All work is to be carried out to the latest current British standards Codes of Practice and recognised working practices.
- All work and materials should comply with Health and Safety legislation and to be approved by the Local Authority Planning / Building Control Officer.
- All dimensions are in millimetres unless where explicitly shown otherwise.
- The contractor should check and clarify all dimensions as work proceeds and notify the design team of any discrepancies.
- Do not scale off the drawings, if in doubt ask.
- Avalon Chartered Town Planning are not liable for work undertaken prior to Full Planning Consent and/or Building Regulations Approval

- KEY :-**
- Acoustic fence
  - Stone wall and railings
  - timber privacy fence

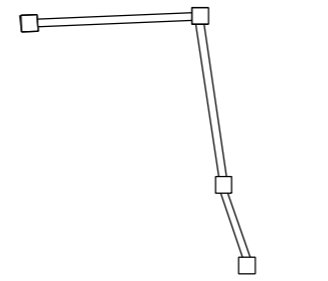
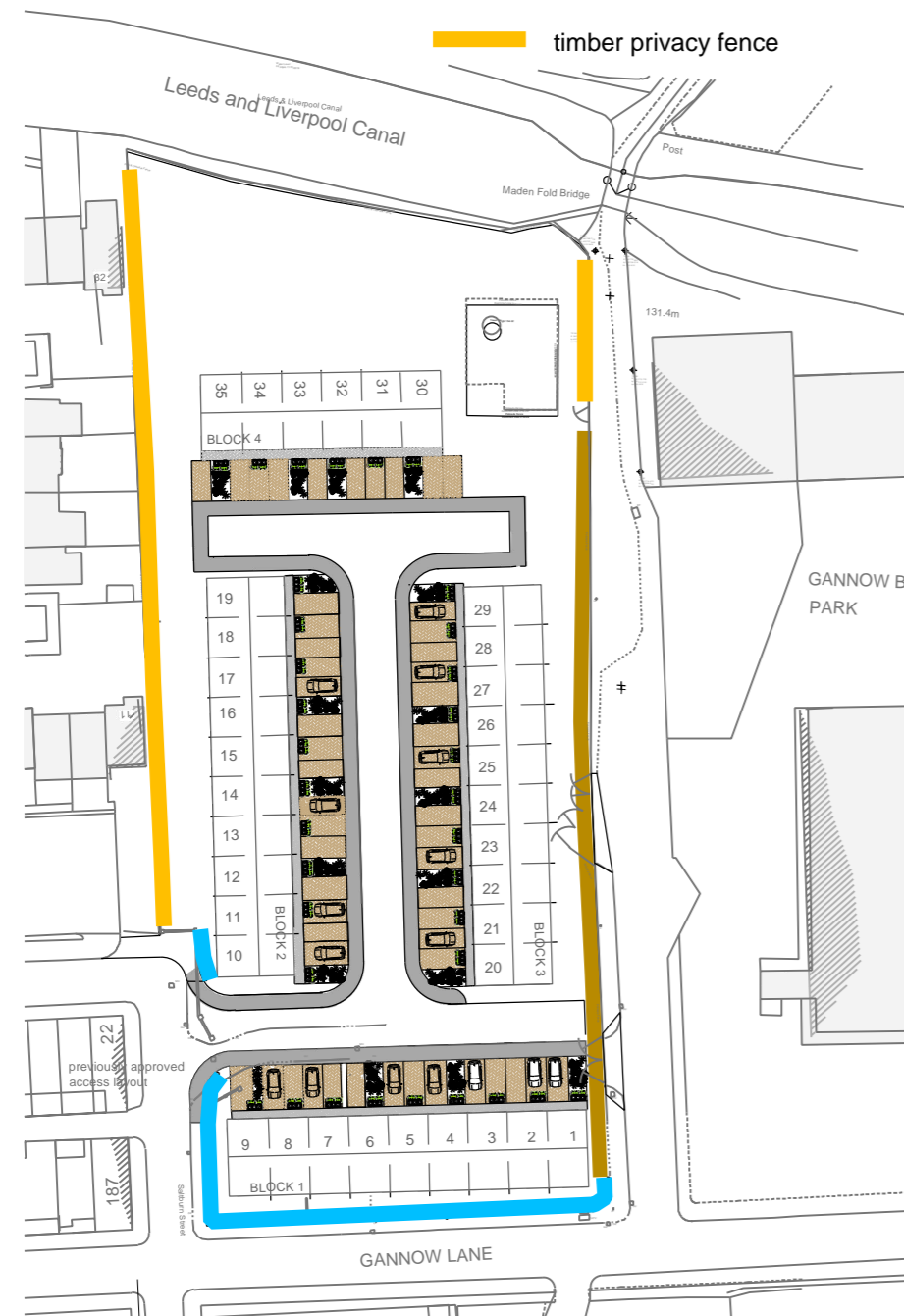

Saltburn Street elevation

Site access



Saltburn Street elevation

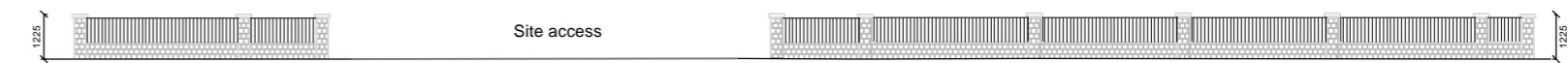

Gannow Lane elevation

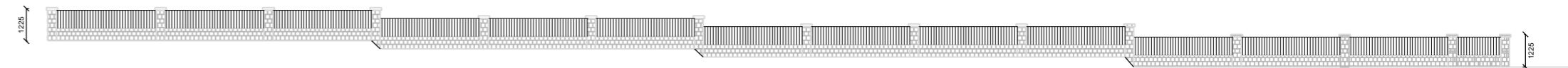

TYPICAL STONE WALL AND RAILINGS DETAIL - 1:200

Saltburn Street elevation

TYPICAL TIMBER PRIVACY FENCE DETAIL - 1:100

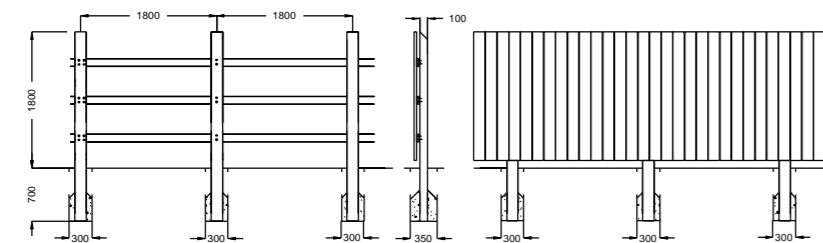

- NOTES**
- ALL TIMBER IS TO BE APPROVED SOFTWOOD SAWN OR BORED AS SPECIFIED UNLESS OTHERWISE TREATED.
  - ALL NAILS SHALL BE 100 x 3 OR 90 x 4 B.C.20. 100 SPECIFIED.
  - POSTS SHALL BE 100 x 100 x 2000 AT A MAXIMUM OF 1000mm CENTRES. WITH WEATHERED TOP. SET VERTICALLY IN GROUND. MINIMUM 100mm HALF FILLED WITH 1:3 CONCRETE AND BARRING. OVERHANGING BACKFILL REMOVED WITH SOIL AND SAND.
  - SHALL BE 100 x 100 BUTT JOINTED ON CENTRE LINE OF POST. JOINTS STAGGERED AS SHOWN. TWO TIMBER NAILS PER STATION DIVISION. THE SPUR POSTS SOUTH SHALL BE POINTED.
  - WEATHERED TOP TO POSTS SHALL BE CUT ACCURATELY AND NAILS TO BE FREE FROM SPITS, SPOONED AND SPLIN. 100mm (100) CHAIN SAWS SHALL NOT BE USED.
  - FACE TO 100 x 100 x 22 SOFTWOOD BOARD ARRANGED VERTICALLY AND FIXED WITH NAILS TO WALL.
  - FENCE SHALL BE ERRECTED TRUE TO LINE AND THE LEVEL SHALL FOLLOW THE PROFILE OF THE GROUND.

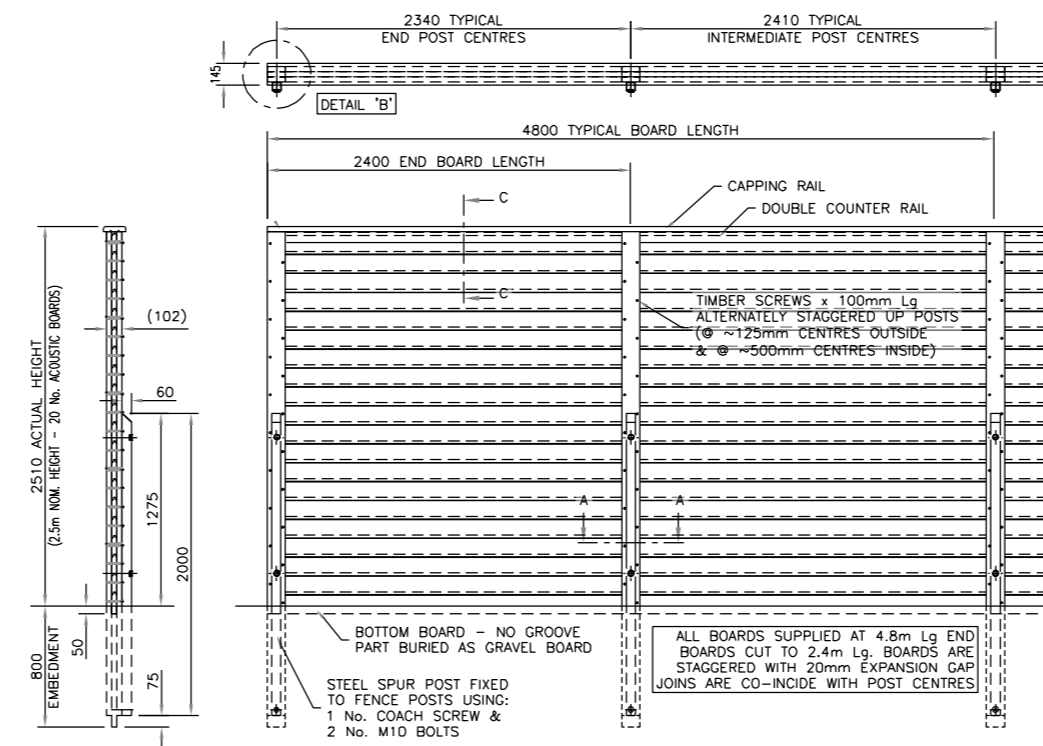

JAKOUSTIC FENCE - 2.5m HIGH

**Avalon**

Architectural Design & Planning

Town Planning - Architectural Design - Building Regulations

Office Suite 4A, Ribble Court, 1 Mead Way, Shuttleworth Mead Business Park, Padiham, Burnley, BB12 7NG

**BOUNDARY TREATMENT PLAN**

Site: Former Dexter paints Site  
Gannow Lane  
Burnley

Client: J & P Nixon Builders Ltd

Date: 15.12.23 Scale: 1:1000; 1:200 & 1:50 @ A2

Project No: NIX 09 - 13 Boundary Plan Drawn: BS

Amendments: