

PROPOSED FRONT ELEVATION (SIGN A)

1:20 @ A3

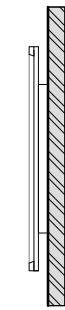

PROPOSED SECTION (SIGN A)

1:20 @ A3

Detail 01
dwg. 13002

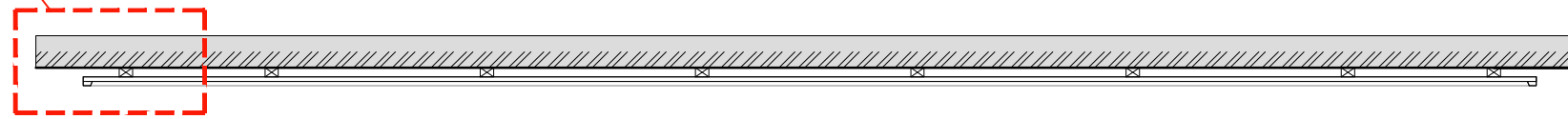

PROPOSED PLAN (SIGN A)

1:20 @ A3



KEY ELEVATION (WEST FRONT)

1:100 @ A3

Existing wall light to remain as present.
Location of new Sign A

12mm thick external grade (Class-3) plywood sign edging, feat. chamfered inner corner. Painted finish, colour Brown Grey (RAL 7013).

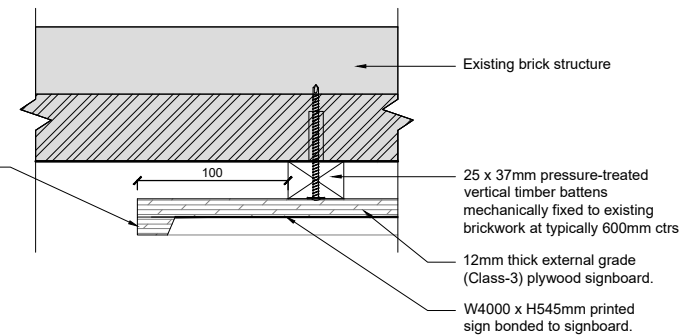

PROPOSED PLAN DETAIL 01 (SIGN A)

1:5 @ A3

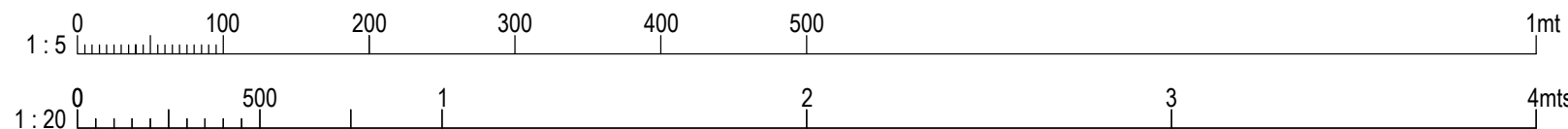

NOTES
-Do not scale from this drawing, except for planning purposes.
-Check all dimensions on site.
-Subject to survey.
-Subject to site inspection.
-Site boundary lines are indicative only.

Rev	Date	By	Description
A	26.01.2024	DC	Various minor amendments

Revision Schedule

project
ALTERATIONS:
Cafe St Paul's
12 Saint Paul's Lane
Lincoln, LN1 3AL

title
Proposed Details: Sign A

drawing status		scale	
PLANNING		As stated @ A3	
contract no.	-	client ref.	Mr G. Reeves
drawn by	DC	date	22.01.2024
checked by	HC	drawn by	DC

drawing number
10103-SD-XX-XX-DR-A-13002
originalator-zone-level-type-role-sheet number



Simons Design Ltd
architects
Newland House, The Point, Weaver Road, Lincoln,
Lincolnshire, LN6 3QN
T: +44 (0) 1522 815 114
E: info@simons-design.co.uk
www.simons-design.co.uk