

PROPOSED GROUND FLOOR
GENERAL ARRANGEMENT PLAN

1:50 @ A1

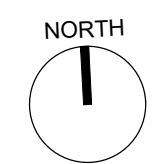

ST PAULS LANE

New Door Schedule

D001 = Type B
D002 = Type C
D003 = Type D
D004 = Type E
D101 = Type A
D102 = Type A
D103 = Type A (Handed)

NOTES

- Do not scale from this drawing, except for planning purposes.
- Check all dimensions on site.
- Subject to survey.
- Subject to site inspection.
- Site boundary lines are indicative only.

Works Key

- Existing polycarbonate roof to be removed. New glazed lean-to roof to be installed.
- Existing entrance ramp to be retained in-situ. Existing timber decking to be covered with 4mm thick plywood sheet and new slip-resistant vinyl floor finish.
- Existing timber balustrade to be removed and replaced with new timber square spindle balustrade with oak handrail and square newel posts.
- Existing decking area to be extended and altered to form new seating area with integrated planter.
- Existing late-C20th window opening to be bricked-up, feat. painted finish to match surrounding brickwork.
- New timber stud walls to be installed to form new Draught Lobby, featuring vertical fluted timber panels, colour Brown Grey (RAL 7013). New timber framed glazed panel doors to Draught Lobby.
- Existing door to Bin Store to be replaced with new door feat. vertical fluted timber panels, colour Brown Grey (RAL 7013).
- Existing Bin Store and Beer Store to be retained.
- Existing bar servery to be repositioned within cafe room as shown.
- New stud wall acoustic lining installed to existing party wall.
- New timber stud walls to be installed to former bar servery openings and made good as necessary.
- Existing kitchen access / fire door to be retained.
- Existing concrete parapet coping wall to be altered to accommodate new glazed lean-to roof.
- Existing mineral felt roof coverings to be replaced with new GRP coverings, colour Mouse Grey (RAL 7005).
- Existing roof eaves to be altered to accommodate new GRP valley gutter, colour Mouse Grey (RAL 7005). Remainder of existing pantile covered roof slope to be retained.
- Collected surface rainwater to lead to and discharge into new sump, connected to existing rainwater downpipe and gully below at ground floor level.
- Existing late-C20th timber doors to be replaced with new timber framed glazed panel doors. Painted finish colour Mouse Grey (RAL 7005).
- Existing late-C20th timber doors to be replaced with new timber framed glass panel doors, feat. painted finish colour Brown Grey (RAL 7013). New increased glazing to doors to maximize views to castle wall. New doors to be inward-opening. Existing door openings to be retained.
- Existing temporary seating and tables to be replaced with new fixed units featuring integrated planters.
- Existing late-C20th doors and side screens to be removed. New hold-open glass panel fire door to be installed.
- New wall mounted air-conditioning heat pump unit for cellar cooler unit for Beer Store.

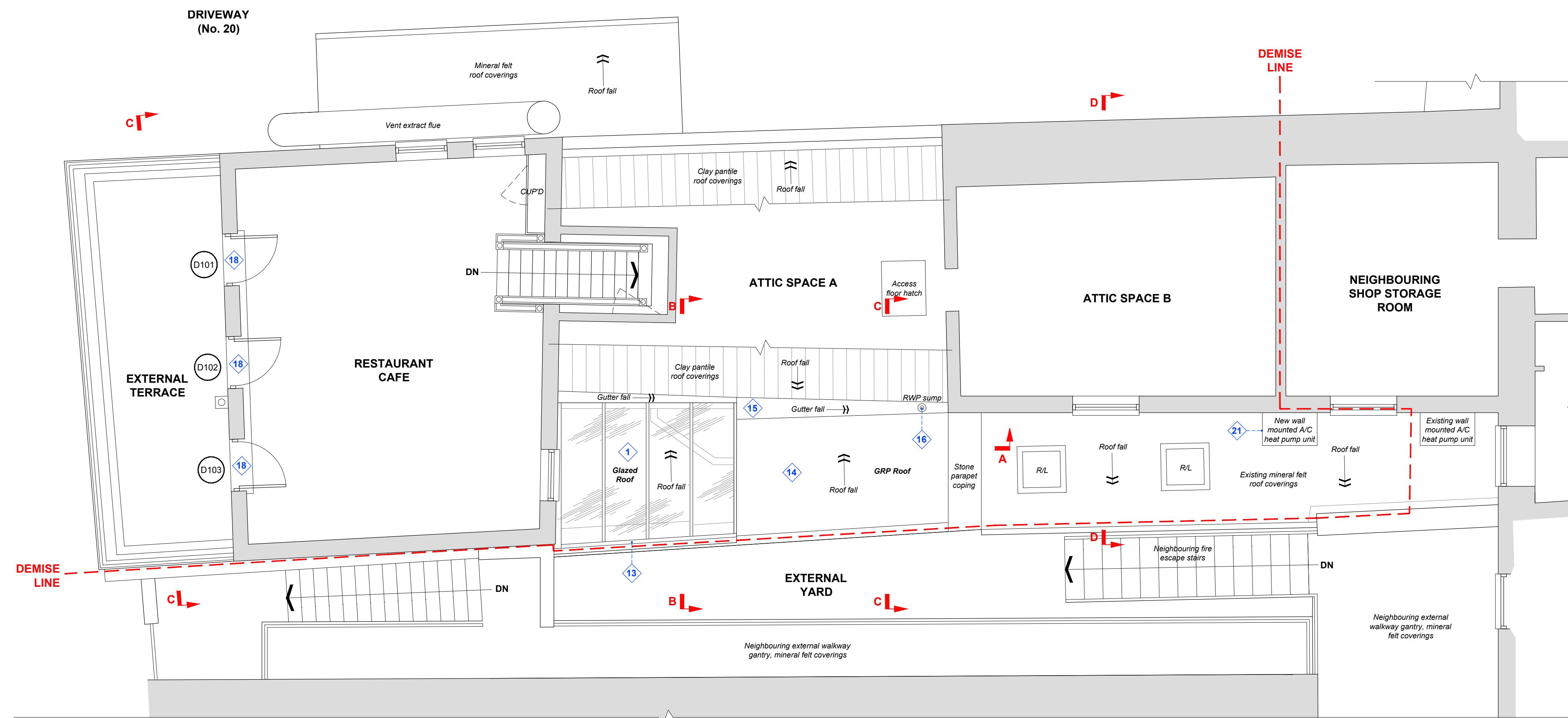

PROPOSED FIRST FLOOR
GENERAL ARRANGEMENT PLAN

1:50 @ A1

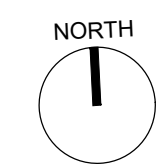

Rev	Date	By	Description
D	28.01.2024	DC	Added Cellar Cooler heat pump unit
C	28.01.2024	DC	Amended Door D1004
B	24.01.2024	DC	Various minor amendments
A	19.12.2023	DC	Various minor amendments

Revision Schedule

project
ALTERATIONS:
Cafe St Paul's
12 Saint Paul's Lane
Lincoln, LN1 3AL

title
**Proposed Ground and First Floor
GA Plans**

drawing status
PLANNING

contract no.	scale
-	1:50 @ A1
client ref.	date
Mr G. Reeves	11.12.2023
drawn by	checked by
DC	HC

drawing number	revision
10103-SD-XX-XX-DR-A-11001	D



Simons Design Ltd
architects
Newland House, The Point, Weaver Road, Lincoln,
Lincolnshire, LN6 3QN
T: +44 (0) 1522 815 114
E: info@simons-design.co.uk
www.simons-design.co.uk