

This drawing is not to scale. The architect is to be informed of any errors before work proceeds. The general contractor is responsible for checking all dimensions.

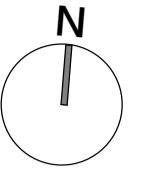

Notes

Drawings to be read and printed in colour.

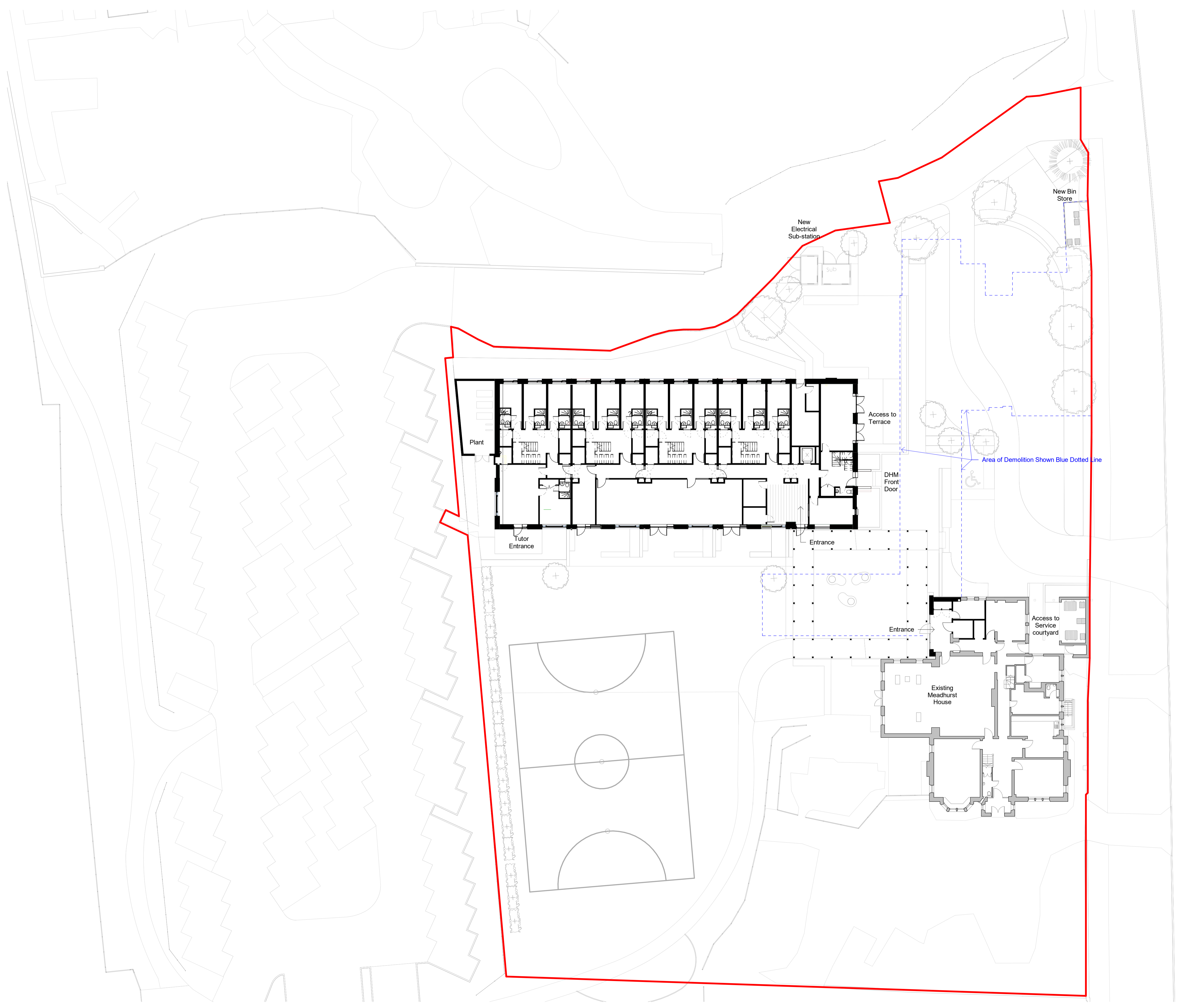

Ayston Road (A6003)

Rev	Date	Description	Drawn
P9	29.01.2024	Planning issue	AC
P8	25.01.2024	Updated	KD
P7	24.01.2024	Draft Planning Issue	KD
P6	23.01.2024	Updated Colonnade	KD
P5	18.01.2024	Design development	KD
P4	08.12.23	Design development	AD
P3	10.11.23	Updated	AD
P2	17.08.23	PreApp Issue	AD
P1	16.08.23	First Issue	AD

rhp r h partnership architects
94 Chesterton Road Cambridge CB4 1ER
T 01223 316309
www.rhpartnership.co.uk
cambridge@rhpartnership.co.uk

Project
**Uppingham School
Meadhurst New Build**

Drawing
Proposed Site Masterplan

Project originator volume level type note number revision
P1299-RHP-MS-00-DR-A- 1000 P9

Scale(s) RHP Project First issued Drawn Client
As indicated@A1 P1299 24/07/23 AA AD

Status
Planning

