

Do not scale from this drawing.

**SAFETY HEALTH AND ENVIRONMENTAL INFORMATION**

IN ADDITION TO THE HAZARD/RISKS NORMALLY ASSOCIATED WITH THE TYPES OF WORK DETAILED ON THIS DRAWING, NOTE THE FOLLOWING RISKS AND INFORMATION:

RISKS LISTED HERE ARE NOT EXHAUSTIVE. REFER TO DESIGN ASSESSMENT FORM DDD NO. 01/108537/06

**CONSTRUCTION**

- Site is adjacent to B1278 highway & John Walker Road.
- Residential areas near to the site boundary - the reduction of dust & noise during construction works should be carefully considered.
- Ground conditions - Refer to the Geo-Environmental Interpretative Report - D/J/108537/09.
- Asbestos contamination is located in various site areas.
- Buried services - Contractor to carry out site scan prior to dig.

**DEMOLITION**

FOR INFORMATION RELATING TO USE, CLEANING AND MAINTENANCE SEE THE HEALTH AND SAFETY FILE

IT IS ASSUMED THAT ALL WORKS WILL BE CARRIED OUT BY A COMPETENT CONTRACTOR WORKING, WHERE APPROPRIATE, TO AN APPROVED METHOD STATEMENT.

**DESIGN IS SUBJECT TO:**

- CONFIRMATION OF ALL INTERNAL FOUL BELOW GROUND DISCHARGE POINTS.
- NWL APPROVAL TO CONNECT THROUGH A "SECTION 106 APPLICATION FOR CONNECTION TO A PUBLIC SEWER."

This drawing represents the "As Designed" details of the civil engineering solutions proposed by Fairhurst. To the best of our knowledge it incorporates any modifications carried out during the construction period. However, modifications made by third parties may not be included.

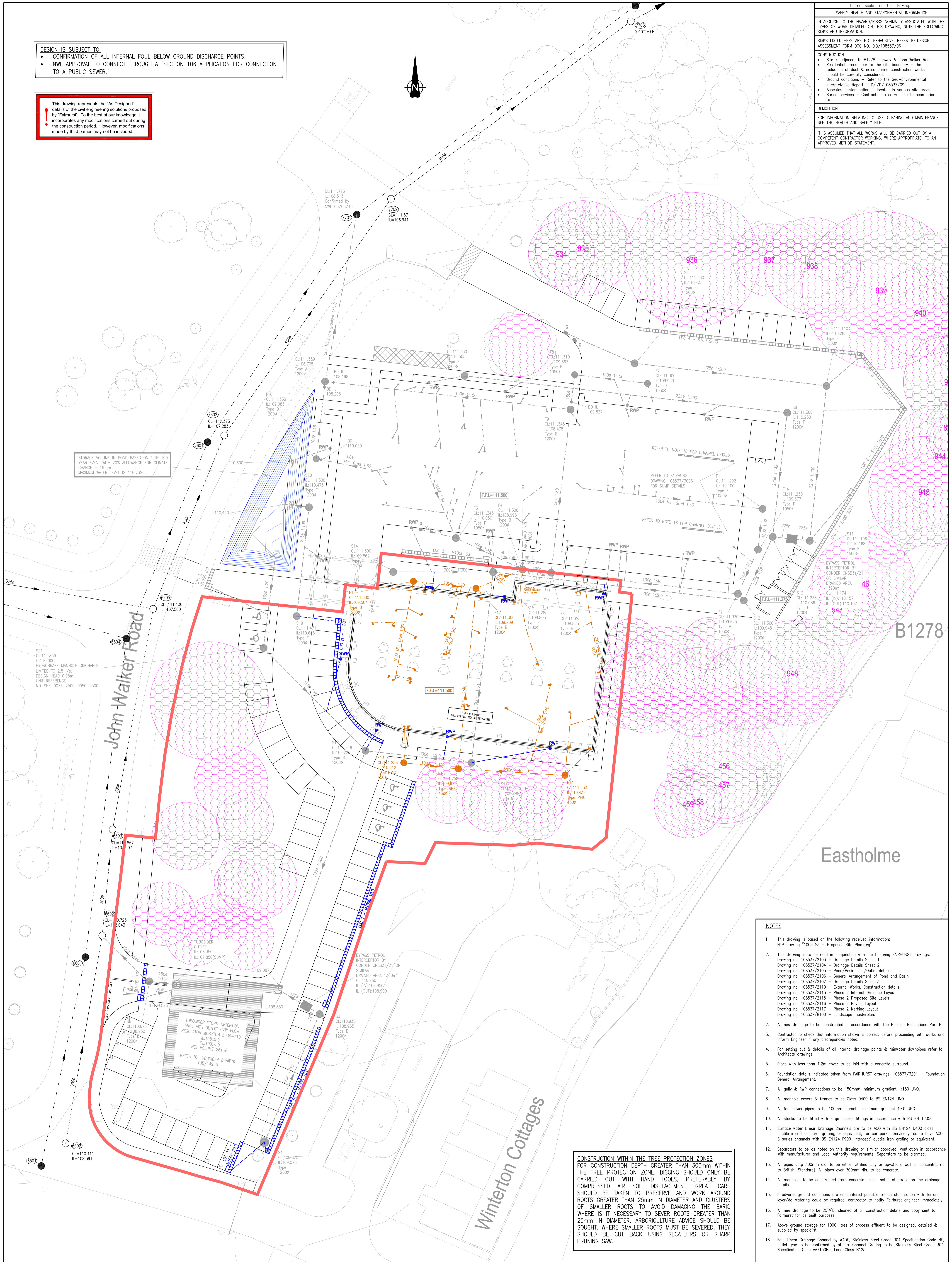

STORAGE VOLUME IN POND BASED ON 1 IN 100 YEAR EVENT WITH 20% ALLOWANCE FOR CLIMATE CHANGE = 19.2m<sup>3</sup>.  
MAXIMUM WATER LEVEL IS 110.722m.

**CONSTRUCTION WITHIN THE TREE PROTECTION ZONES**

FOR CONSTRUCTION DEPTH GREATER THAN 300mm WITHIN THE TREE PROTECTION ZONE, DIGGING SHOULD ONLY BE CARRIED OUT WITH HAND TOOLS, PREFERABLY BY COMPRESSED AIR SOIL DISPLACEMENT. GREAT CARE SHOULD BE TAKEN TO PRESERVE AND WORK AROUND ROOTS GREATER THAN 25mm IN DIAMETER AND CLUSTERS OF SMALLER ROOTS TO AVOID DAMAGING THE BARK. WHERE IS IT NECESSARY TO SEVER ROOTS GREATER THAN 25mm IN DIAMETER, ARBORICULTURE ADVISE SHOULD BE SOUGHT. WHERE SMALLER ROOTS MUST BE SEVERED, THEY SHOULD BE CUT BACK USING SECATEURS OR SHARP PRUNING SAW.

- NOTES**
- This drawing is based on the following received information:  
HLP drawing "1003 53 - Proposed Site Plan.dwg".
  - This drawing is to be read in conjunction with the following FAIRHURST drawings:  
Drawing no. 108537/2103 - Drainage Details Sheet 1  
Drawing no. 108537/2104 - Drainage Details Sheet 2  
Drawing no. 108537/2105 - Pond/Basin Inlet/Outlet details  
Drawing no. 108537/2106 - General Arrangement of Pond and Basin  
Drawing no. 108537/2107 - Drainage Details Sheet 3  
Drawing no. 108537/2110 - External Works, Construction details.  
Drawing no. 108537/2113 - Phase 2 Internal Drainage Layout  
Drawing no. 108537/2115 - Phase 2 Proposed Site Levels  
Drawing no. 108537/2116 - Phase 2 Paving Layout  
Drawing no. 108537/2117 - Phase 2 Kerbing Layout  
Drawing no. 108537/8100 - Landscape masterplan.
  - All new drainage to be constructed in accordance with the Building Regulations Part H.
  - Contractor to check that information shown is correct before proceeding with works and inform Engineer if any discrepancies noted.
  - For setting out & details of all internal drainage points & rainwater downpipes refer to Architects drawings.
  - Pipes with less than 12m cover to be laid with a concrete surround.
  - Foundation details indicated taken from FAIRHURST drawings; 108537/3201 - Foundation General Arrangement.
  - All gully & RWP connections to be 150mm, minimum gradient 1:150 UNO.
  - All manhole covers & frames to be Class D400 to BS EN124 UNO.
  - All foul sewer pipes to be 100mm diameter minimum gradient 1:40 UNO.
  - All stacks to be fitted with large access fittings in accordance with BS EN 12056.
  - Surface Water Linear Drainage Channels are to be ACO with BS EN124 D400 class ductile iron 'Intergrated' grating, or equivalent, for car parks. Service yards to have ACO S series channels with BS EN124 F500 'Intercept' ductile iron grating or equivalent.
  - Separators to be as noted on this drawing or similar approved. Ventilation in accordance with manufacturer and Local Authority requirements. Separators to be slatted.
  - All pipes up to 300mm dia. to be either vitrified clay or upvc/solid wall or concentric rib to British Standard. All pipes over 300mm dia. to be concrete.
  - All manholes to be constructed from concrete unless noted otherwise on the drainage details.
  - If adverse ground conditions are encountered possible trench stabilisation with Terram layer/de-watering could be required, contractor to notify Fairhurst engineer immediately.
  - All new drainage to be CCTV'd, cleaned of all construction debris and copy sent to Fairhurst for as built purposes.
  - Above ground storage for 1000 litres of process effluent to be designed, detailed & supplied by specialist.
  - Foul Linear Drainage Channel by WADE, Stainless Steel Grade 304 Specification Code NE, outlet type to be confirmed by others. Channel Grating to be Stainless Steel Grade 304 Specification Code AA715085, Load Class B125

Rev.	Date	Description	Drawn	Checked	Approved
H	28/10/18	UPDATED AS DESIGNED ISSUE	JH	JM	JC
C	18/09/18	COURTYARD LAYOUT UPDATED.	JH	JM	NB
F	09/02/18	SLAB PENETRATIONS AMENDED TO SUIT LATEST HL DRAWING 16129/1500/0211 RECEIVED 08/02/18. MH F13 ADDED TO PICK UP SVP	AC	JM	NB
E	07/02/18	MH's F16 & F17 REVISED TO 1200mm DIA. MH'S 14 & 15 REVISED TO 450mm DIA. MH F13 REMOVED TO SUIT SURGO TO'S RECEIVED 06/02/18	AC	JM	NB
D	24/11/17	INTERNAL DRAINAGE CONNECTION POINTS UPDATED FOLLOWING RECEIPT OF LATEST ARCHITECTS BUILDING LAYOUT. CONSTRUCTION ISSUE	JH	JM	NB
C	13/06/17	PHASE 2 SITE BOUNDARY ALTERED AS INDICATED	DH	HB	JC
B	07/06/17	PHASE 2 SITE BOUNDARY UPDATED. LINEAR DRAINAGE CHANNELS ALTERED TO PHASE 2 WORKS	DH	JM	SB
A	10/02/17	DRAWING AMENDED IN ACCORDANCE WITH ARCHITECTS REVISED GROUND FLOOR PLAN.	JH	JM	NB

**KEY**

**EXISTING**

- Surface Water sewer with manhole
- Foul sewer with manhole
- NWL manhole reference
- Existing trees to be retained with minimum extent of root protection shown

**PROPOSED**

- Phase 2 site boundary
- Surface water drainage with manhole
- Surface water manhole with backdrop
- Surface water rodding eye
- Foul drainage with manhole
- Foul drainage manhole with backdrop
- RWP (Exact locations TBC by HLP)
- SVP (Exact locations TBC by HLP)
- Surface Water Linear Drainage Channel with sump
- Surface Water headwall
- Surface Water gully

**NOTE:**  
PHASE 1 WORKS ARE REPRESENTED IN GREY

Client: **NETPARK, SEDGEFIELD NCHP BUILDING**

Project Title: **NETPARK SEDGEFIELD PHASE 2 DRAINAGE**

Scale: 1:200

Drawn: JH, Checked: JM, Approved: NB

Date: 02/02/17, Issue: 07/02/17, Date: 27/02/17

Drawing No: **108537/2114**

Revision: **H**

**FAIRHURST**  
1 Angrove Court, Barrow Road, Newcastle-upon-Tyne, NE4 6BB  
Tel: 0191 231 0206 Fax: 0191 281 4412