

05.12.24 10:15:11 AM

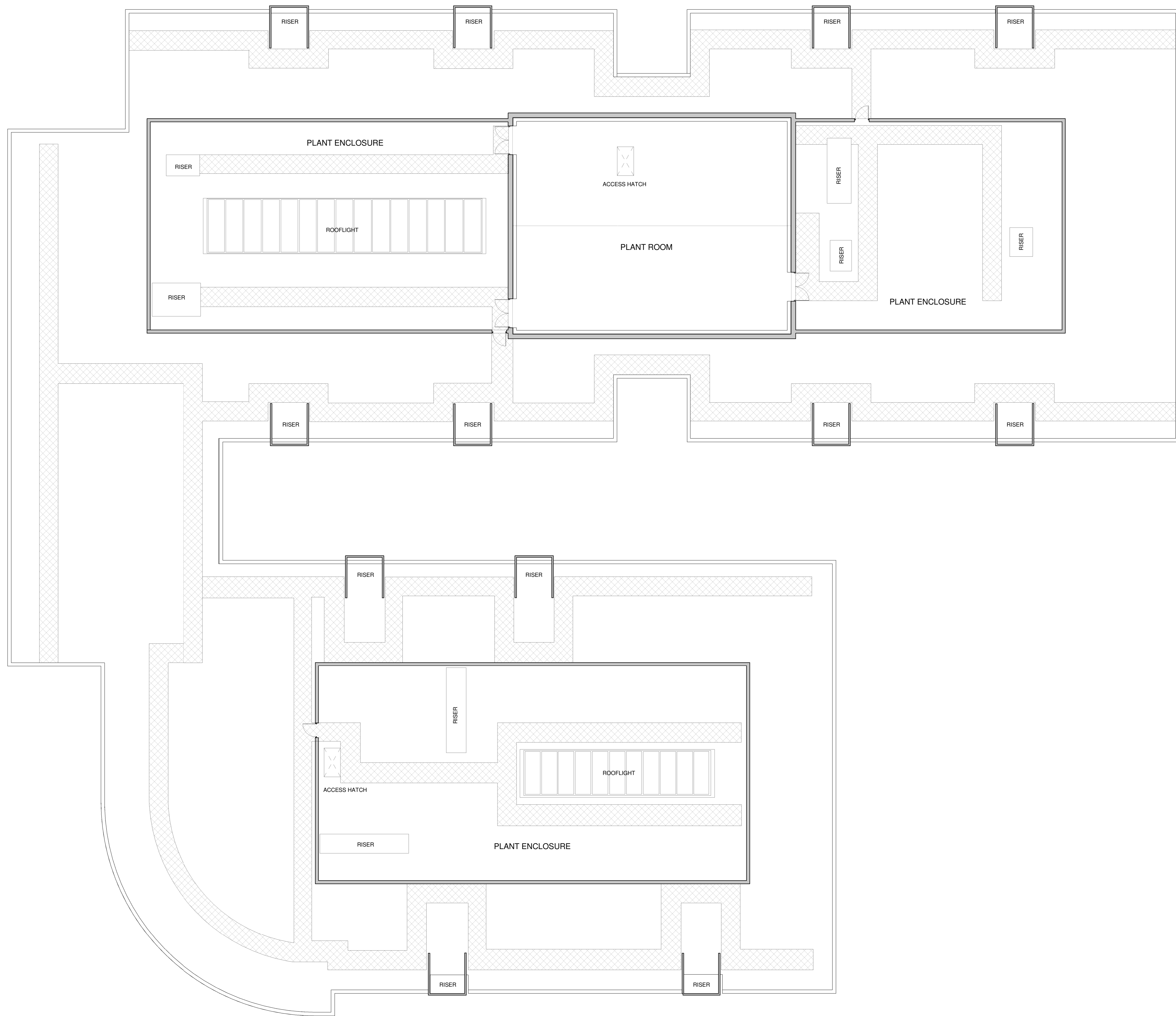

ROOF PLAN - EXISTING  
SCALE: 1 : 100

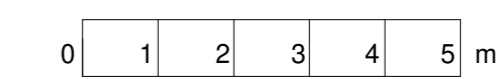

THIS PLAN IS PREPARED FROM RECORD DRAWINGS SUPPLIED BY CPI AND HAS NOT BEEN VERIFIED BY SITE MEASUREMENT OR SURVEY  
WALLS, DOORS AND STAIRS AND SOME GLAZING IS INCLUDED - BUT NOT ALL EXISTING ELEMENTS (SUCH AS GLAZING) ARE SHOWN

DATE	REVISION	REV	DR	CH
06.06.23	Preliminary Stage 3 Issue	P01	sm	sm
12.09.23	Issued for Planning Approval	P02	sm	sr

This drawing has been prepared solely for the use of CPI (Centre for Process Innovation) and there are no representations of any kind made by NORR Consultants Limited to any party with whom NORR Consultants Limited has not entered into a contract. This drawing must not be used, reproduced or revised without written permission.

This drawing shall not be used for construction purposes until a "As-APPROVED FOR STAGE x" status appears under the Sheet Status.

Constructors must only work to figured dimensions which are to be checked on site. Do not scale from hard copy drawings.

Keyplan



North Arrow

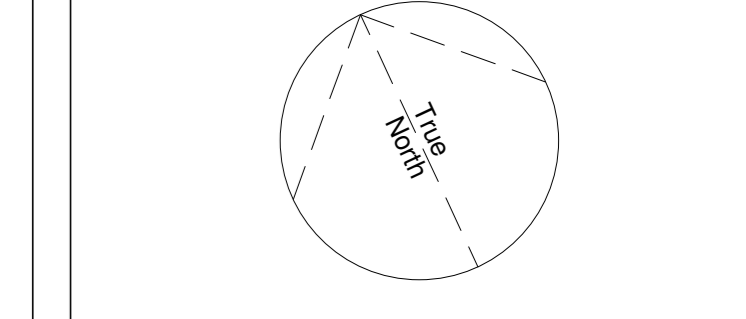

Consultants

**NORR**  
NORR Consultants Limited.  
An Ingenium International Company  
Percy House, 8th Floor Percy Street,  
Newcastle, NE1 4PW  
England, UK  
norrr.com

**NORR**  
NORR Consultants Limited.  
An Ingenium International Company  
Percy House, 8th Floor Percy Street,  
Newcastle, NE1 4PW  
England, UK  
norrr.com

Drawn SM Date 06.06.23

Checked SM Date 06.06.23

Scale 1 : 100 @ A0

Client

CPI (Centre for Process Innovation)

Project

ICDDC Intracellular Drug Delivery Centre

Drawing Title

ROOF PLAN - EXISTING

Sheet Status

SS - FOR REVIEW

Project No. | ANC21-0110

Drawing No. | ICDDC-NOR-XX-RF-DR-A-27010 | P02

Rev.