

Copyright:
 This drawing is the sole copyright of brown + company any reproduction in any form is forbidden unless permission is granted in writing.
 Do not scale from this drawing, any discrepancies on site should be brought to the attention of brown + company
 Work and materials must comply with the current building regulations and any relevant codes of practice, and must be read in conjunction with the building specification and any other consultants or sub-contractor information.

Notes

== == == To be demolished
 [Red hatched area symbol]

Existing ground floors: existing ground floors to be removed, unless otherwise stated. Existing floor finishes to be retained and reused where possible

Existing first floors: existing modern chipboard timber floor covering to be removed, timber structure to be retained. Where lime ash floor is present, lime ash to be retained.

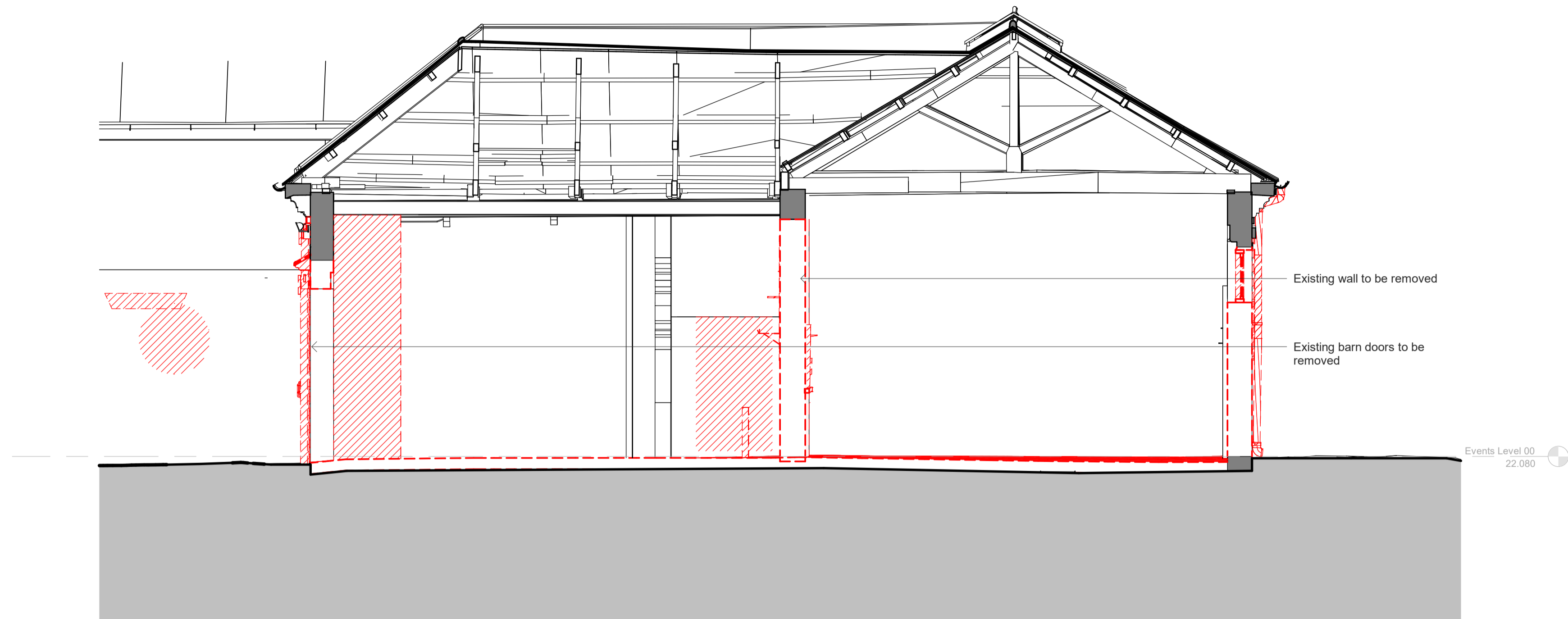

Section 10 - Demolitions
 1 : 50

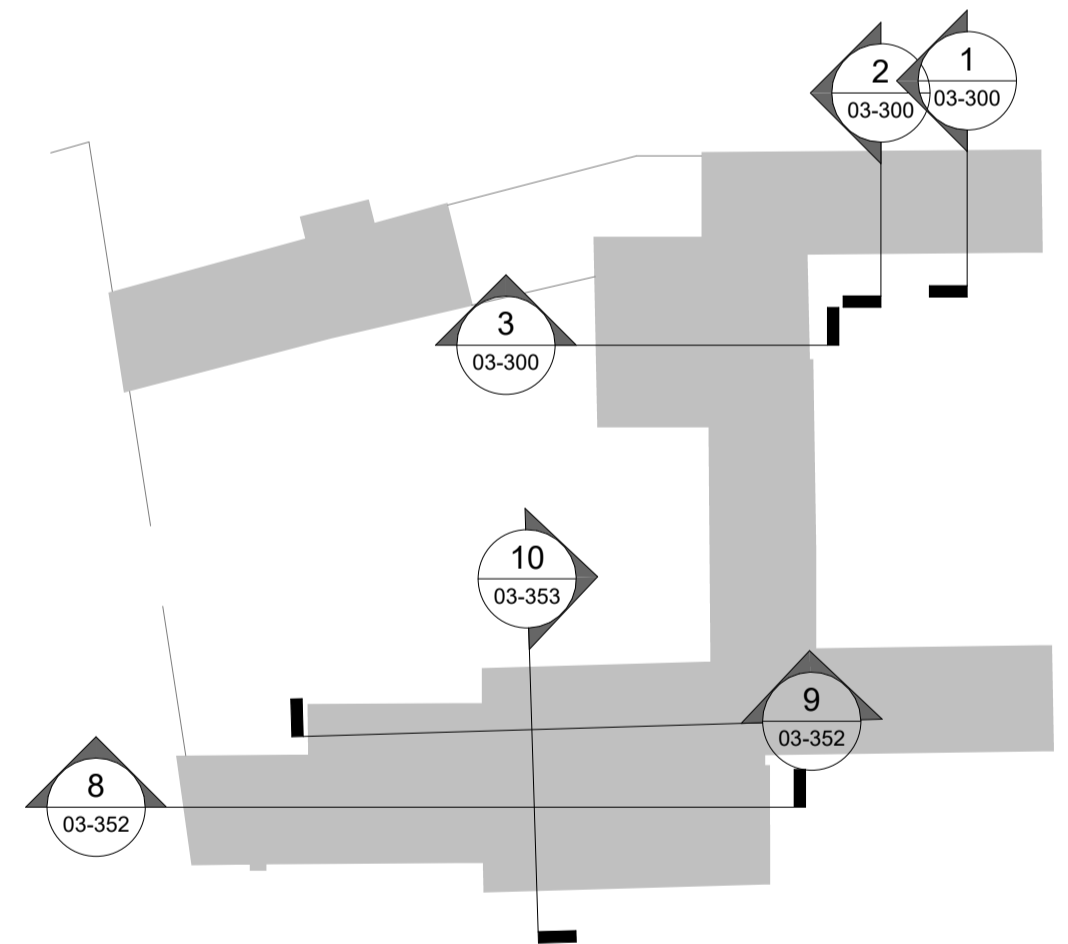

revision	date	description	drawn	checked
P01	15.12.23	Issued for planning	RM	NB

brown + company

project:
 Hotham Hall Estate
 Hotham, York YO43 4UA
 drawing:
 Event Space - Sections Demolitions

status:
 Existing

scale:
 1:50
 Sheet size:
 A1



job number	author	zone	level	type	role	drawing number	revision
23039	BC	Z1	XX	DR	A	03-303	P01