

**Typical Ground Floor Upgrade Detail**  
 1 : 5

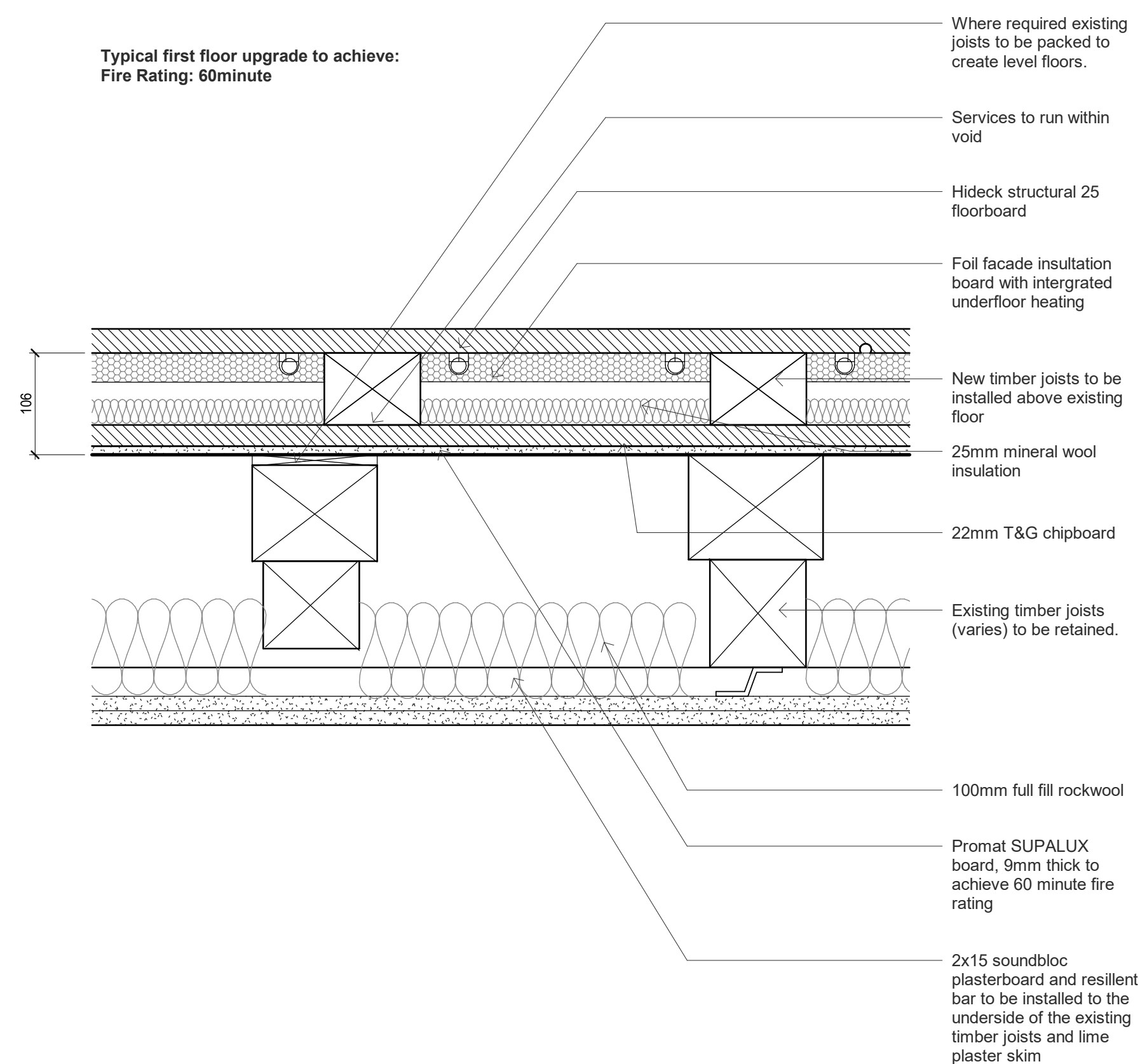

**Typical First Floor Upgrade Detail**  
 1 : 5

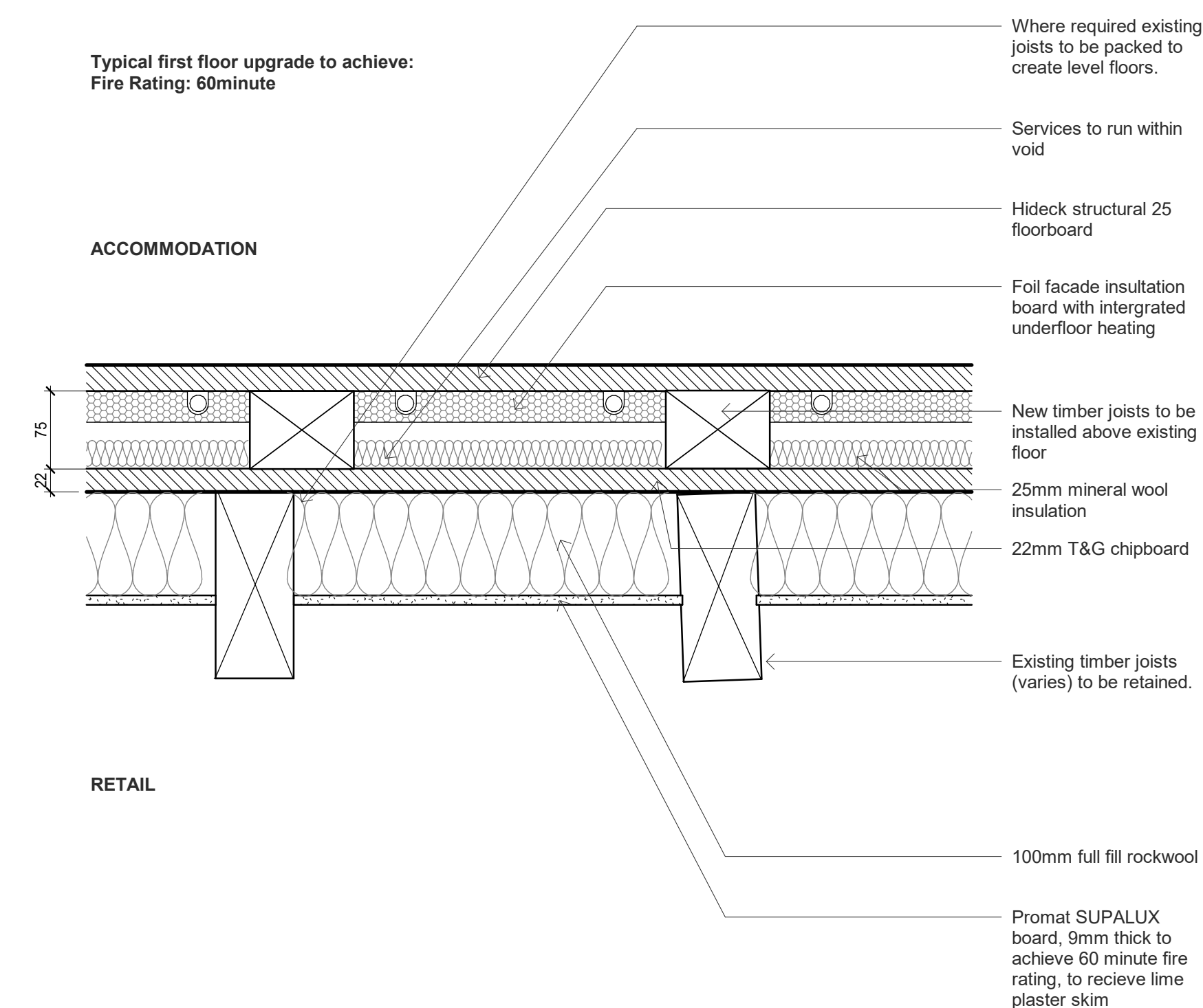

**First Floor Update Detail - Retail Unit**  
 1 : 5

revision	date	description	drawn	checked
P01	15.12.23	Issued for planning	RM	NB

**brown + company**

project:  
 Hotham Hall Estate  
 Hotham, York YO43 4UA

drawing:  
 Internal Details - Floor Upgrades

status:  
 Planning

scale:  
 1:5  
 Sheet size:  
 A1



job number	author	zone	level	type	role	drawing number	revision
23039 - BC - Z1 - XX - DR - A - 03-511							P01