

SCALE OF METRES - 1:50

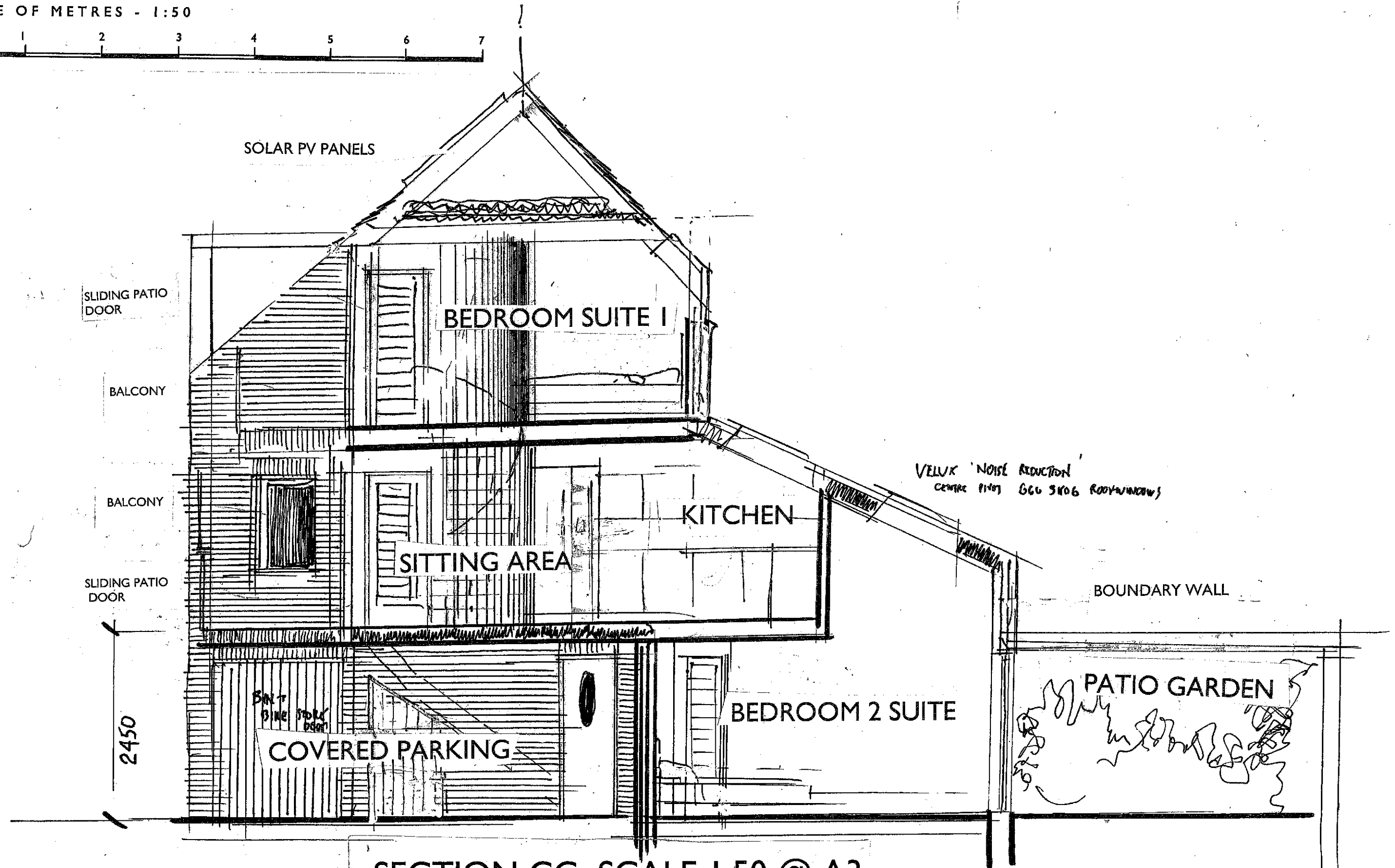

SECTION CC SCALE 1:50 @ A3

**PROPOSED APARTMENT TO REAR OF 1 NORTH BAR WITHIN: CROSS KEYS MEWS,
BEVERLEY HU17 8AP**

June 2023

Job No. 2594

Drawing No. 12

Jonathan S. Hobson R.I.B.A

Ingleby and Hobson Architects RIBA

FIRST FLOOR, 28 LAIRGATE, BEVERLEY, E. YORKSHIRE, HU17 8EP

Tel: 01482 868690

email inghob@gmail.com

Note this drawing is Copyright & shall not be reproduced or made use of without the authority of Ingleby & Hobson Ltd Architects

P121