

**PROPOSED APARTMENT TO REAR OF 1 NORTH BAR WITHIN: CROSS KEYS MEWS,
BEVERLEY HU17 8AP**

June 2023

Job No. 2594

Drawing No. 1-2

Jonathan S. Hobson R.I.B.A

Ingleby and Hobson Architects RIBA

FIRST FLOOR, 28 LAIRGATE, BEVERLEY, E. YORKSHIRE, HU17 8EP

Tel: 01482 868690

email inghob@gmail.com

Note this drawing is Copyright & shall not be reproduced or made use of without the authority of Ingleby & Hobson Ltd Architects

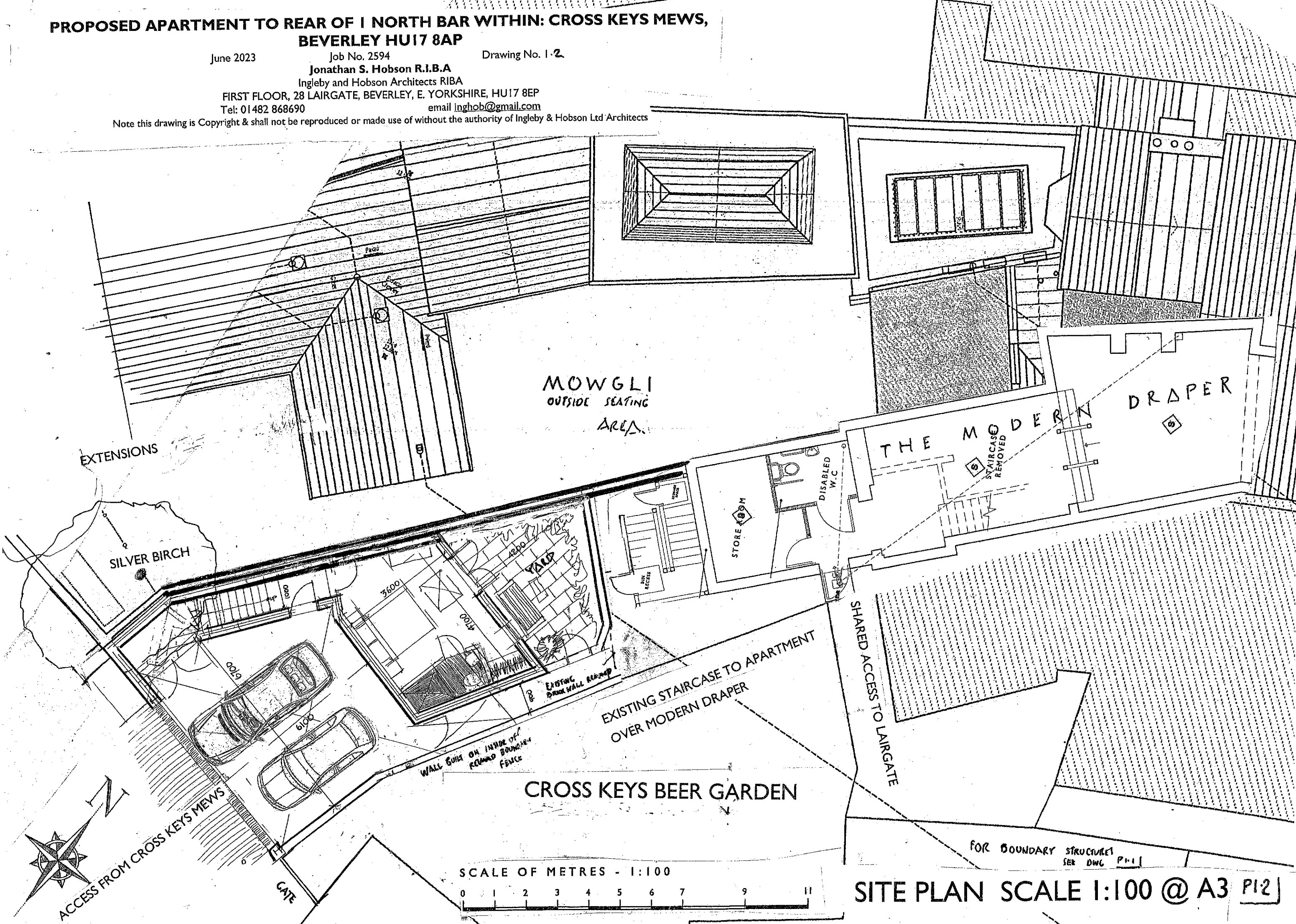

MOWGLI
OUTSIDE SEATING
AREA

EXTENSIONS

SILVER BIRCH

THE MODERN
STAIRCASE
REMOVED

DRAPER

STORE ROOM

DISABLED
W.C.

EXISTING STAIRCASE TO APARTMENT
OVER MODERN DRAPER

SHARED ACCESS TO LAIRGATE

CROSS KEYS BEER GARDEN

SCALE OF METRES - 1:100

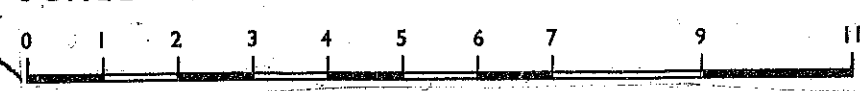

SITE PLAN SCALE 1:100 @ A3 P12

FOR BOUNDARY STRUCTURE
SEE DWG P11

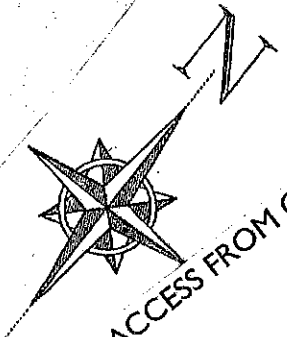

ACCESS FROM CROSS KEYS MEWS

GATE

WALL BUILT ON INSIDE OF
REAR BOUNDARY
FENCE

EXISTING
DRINK WALL REMOVED

6000

6000

3600

4700

4200

4200

4200

4200

4200

4200

4200

4200

4200

4200

4200

4200

4200

4200

4200

4200

4200

4200

4200

4200

4200

4200

4200

4200

4200

4200

4200

4200

4200

4200