

**NOTES:**

1. Levels are related to Ordnance Datum Newlyn
2. Grid is related to Ordnance Datum North
3. Drainage pipe sizes are estimated from the surface
4. Tree sizes are measured 1m from the ground

**KEY**

AV AIR VALVE	OL OUTSIDE LIGHT
BB BELISHA BEACON	LV LOW VOLTAGE
BH BOREHOLE	MH MANHOLE COVER
BOL BOLLARD	MK MARKER
BM BENCH MARK	MKE MARKER ELECTRIC
BS BUS STOP	MKFH MARKER FIRE HYDRANT
BT BRITISH TELECOM COVER	MKSV MARKER SLUICE VALVE
B-W BARBED WIRE	MKT MARKER TELEPHONE
CB CONTROL BOX	MKW MARKER WATER
C-B CLOSE BOARDED	NB NOTICE BOARD
CL COVER LEVEL	NP NAME PLATE
C-L CHAIN LINK	PO POST
CP CATCH PIT	PP PETROL PUMP
CPS CONCRETE PAVING SLABS	P&R POST & RAIL
CTV CABLE TV COVER	P&W POST & WIRE
DP DISTRIBUTION POST	RE RODDING EYE
EOT END OF TRACE	RP REFLECTOR POST
EP ELECTRIC POLE	RS ROAD SIGN
ER EARTH ROD	SP SIGN POST
FH FIRE HYDRANT	STP STAND PIPE
FHT FENCE HEIGHT	SV SLUICE VALVE
FL FLOOR LEVEL	SW SURFACE WATER
FW FOUL WATER	SY STAY
G GULLY	TBM TEMPORARY BENCH MARK
GP GATE POST	TCB TELEPHONE CALL BOX
GAS GAS VALVE	TL TRAFFIC LIGHT
HH HEDGE HEIGHT	TM TICKET MACHINE
HV HIGH VOLTAGE	TP TELEPHONE POLE
IC INSPECTION COVER	UTT UNABLE TO TRACE
IL INVERT LEVEL	UTL UNABLE TO LIFT
I-R IRON RAILING	WH WALL HEIGHT
KO KERB OUTLET	WM WATER METER
LP LAMP POST	WO WASH OUT
	VT VENT

**LINETYPE MENU**

Top Bank	-----	Telephone	-----
Bottom Bank	-----	Low Voltage	-----
Building	-----	Water line	-----
Foliage	-----	Gas line	-----
Hedge	-----	Ducting	-----
Pipe	-----	Tree	-----
Verge	-----	Spread/Dia/Height	-----
Wall	-----	Manhole/	-----
Kerb	-----	Inspection	-----
Fence	-----	cover	-----
Overhead Cable	-----	Unknown	-----
Drop Kerb	-----	General Coms	-----
Depth Burial	0.56m	Foul Water	-----
High Voltage	-----	Surface Water	-----
Fibre Optics	-----	Grid Cross	-----
Cable TV	-----		-----

POINT DATA				
POINT NUMBER	EASTING	NORTHING	LEVEL	DESCRIPTION
1	410148.723	201249.702	96.892	STN
2	410151.907	201265.569	96.984	STN
3	410137.232	201245.566	96.750	STN
4	410135.032	201235.397	96.650	STN
5	410148.238	201228.006	96.598	STN

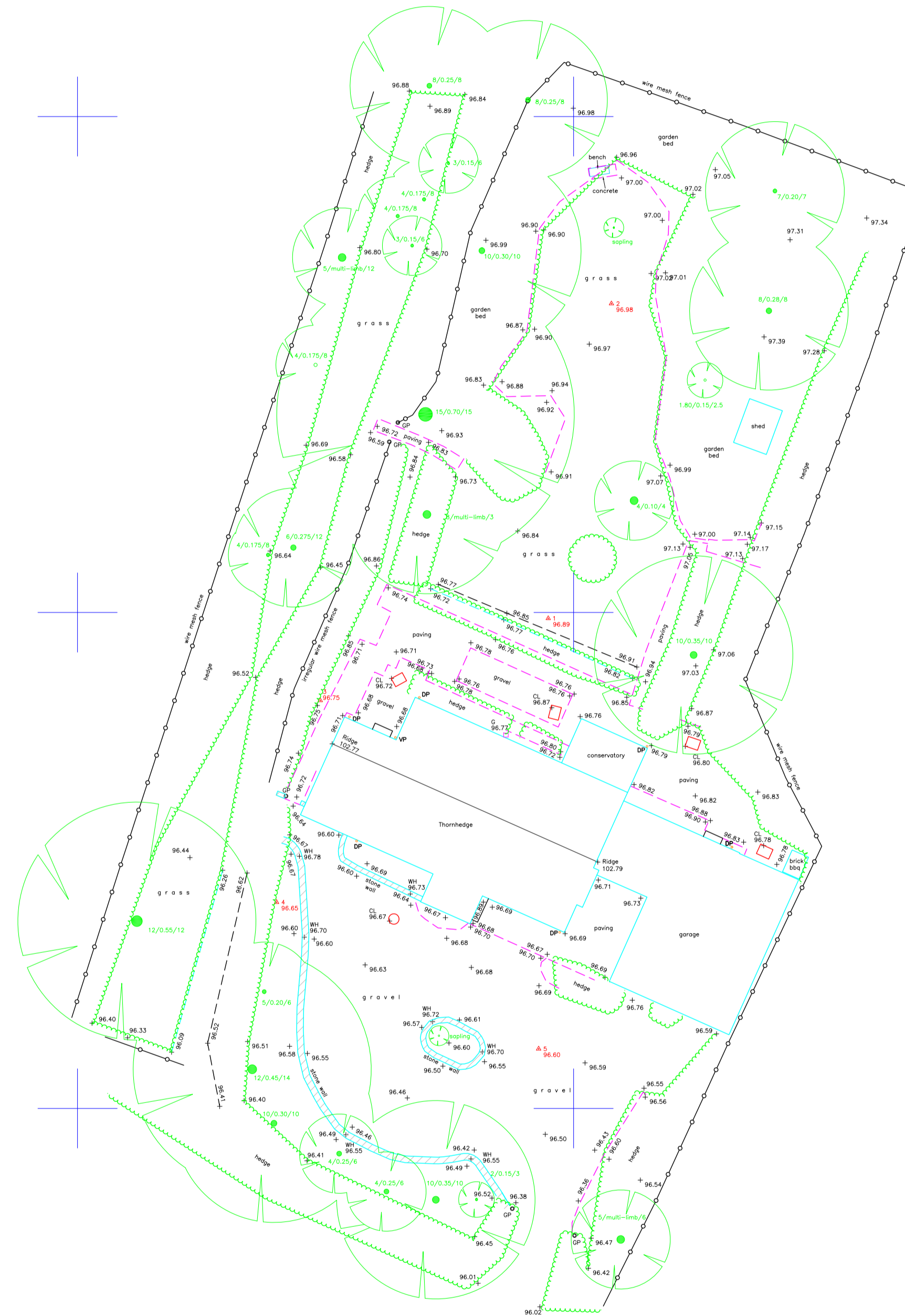

Rev	Date	Details Of Issue	Initials

Status

**Topo & Building Survey**

44B Nailsworth Mills Estate  
Avening Road  
Nailsworth  
Glos  
GL6 9ES  
Tel: 01453 833116  
email: info@geomaptd.co.uk  
www.geomaptd.co.uk

This document and all information herein is confidential and the intellectual property of Geomap Ltd. It is disclosed in confidence on terms that it will not be disclosed to any third party, used, sold, loaned, licensed, or reproduced in whole or in any part in any manner or form for manufacturing, tendering or for any other purpose without the written permission of Geomap Ltd. The copyright is retained by Geomap Ltd until the final invoice is paid in full.  
© Geomap Ltd.

Client **Harries**

Project **Thornhedge, Poulton**

Title **Topographical Survey 2D**

Drawn **MB** Date: **06/06/23** Scale (at A1) **1:200**

Dwg no. **JH-THGE-0606/23/04** Revision No. **1 of 1**