

Location Plan 1:1250

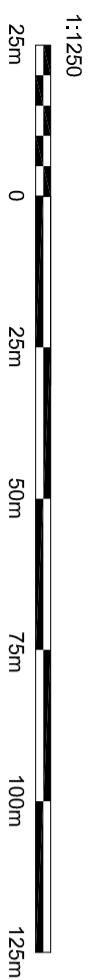

Existing Site Plan 1:500

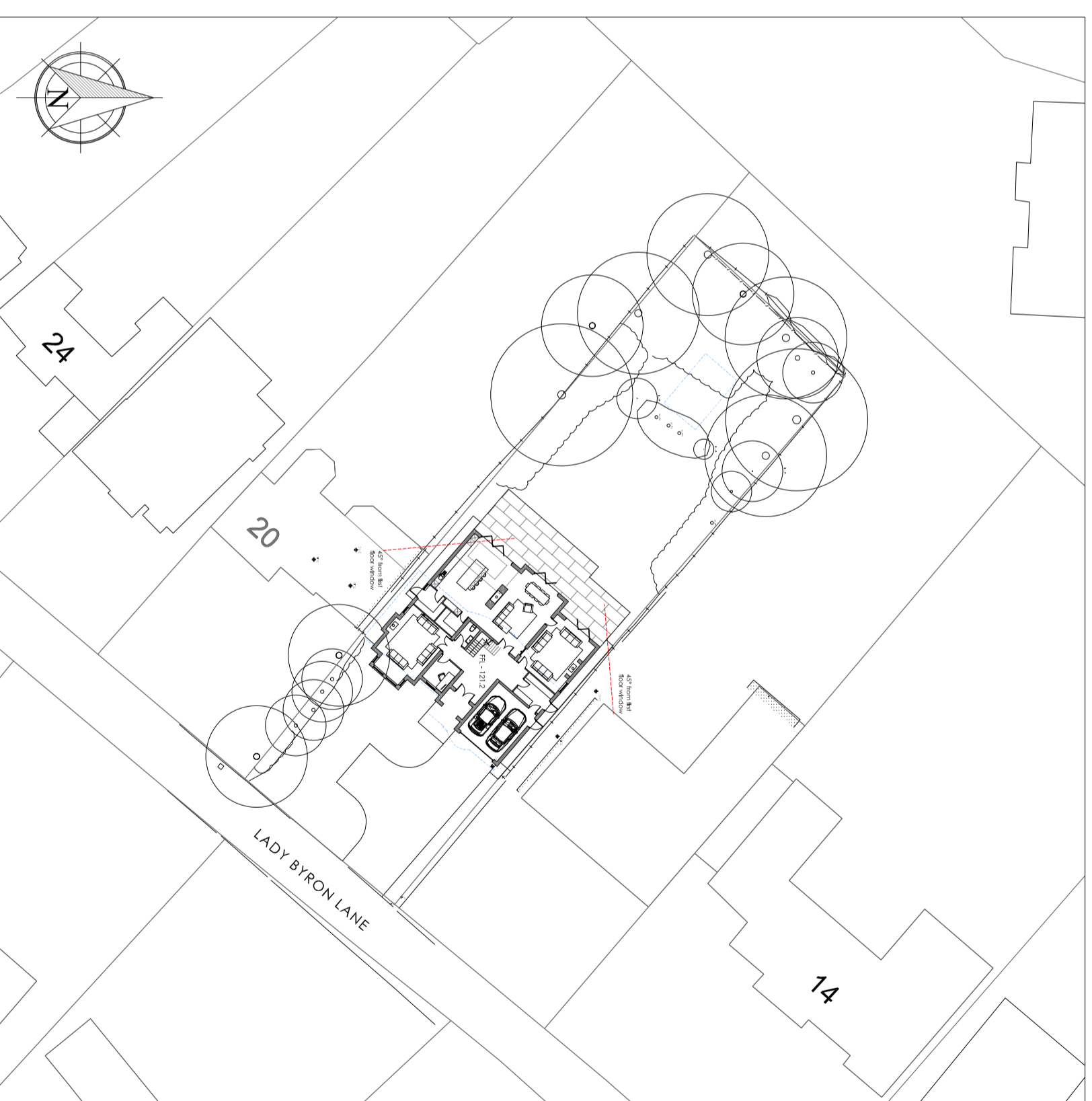
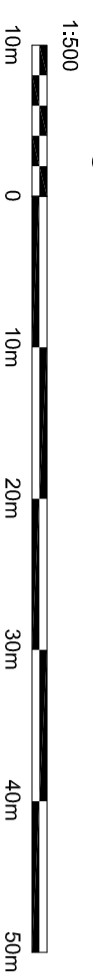

Proposed Site Plan 1:500

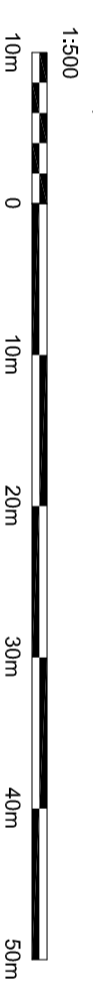

Blue dashed line denotes demolition

The contractor is to check and verify all site and boundary lines and levels and to report any discrepancies prior to commencement of the works.
The contractor must comply in full with all current planning and building regulations, including but not limited to Building Regulations etc., whether or not specifically stated on this drawing.
This drawing is not intended to show foundation details, ground conditions or ground contamination. The contractor must investigate each area of land to be built upon and provide a suitable method of foundation design and construction for existing ground conditions. Any suspect fluid ground, contaminants on or within the ground, or any other conditions which may affect any earthwork constructions shown indicate typical slopes for guidance only and should be further investigated by a suitable expert.
Where existing trees are shown to be retained they should be subject to a full Arboricultural Inspection for safety.
All trees are to be planted so as to ensure they are a minimum of 5 metres from buildings and 3 metres from drainage and services. A suitable method of tree protection is to be provided in order to accommodate the proposed tree planting.

REVISIONS

--	--

neil boddisson associates ltd



architecture planning land

TRAFALGAR HOUSE, 20A, MARKET STREET
NICHFIELD, B613 3AH
WEB: WWW.NB-A.CO.UK TEL: 01543 262444

CLIENT:

Mr Heaven

PROJECT:

18 Lady Byron Lane
Knowle
Sollihull
B93 9AU

DRAWING TITLE:

Location Plan
Existing and Proposed Site Plan

PLANNING DRAWING

SCALE	SHEET
AS SHOWN	A2
DATE	DRAWN BY
November 2023	DH

DRAWING NO	REV.
31156	01

This drawing and the building works depicted are the copyright of Neil Boddisson Associates Ltd and may not be amended or reproduced without the written consent of Neil Boddisson Associates Ltd. Any alterations made by others.