

Arboricultural Impact Assessment & Method Statement  
The Old Inn, Green Ore

8<sup>th</sup> January 2024

**Client:**

Mr & Mrs Friend

**Site:**

The Old Inn  
Roemead Road  
Green Ore  
BA5 3ES  
homelands.focal.widget

**Client Agent:**

Nick German  
DB+ Paul Architects  
01749 677149  
[nick@dbpaul.co.uk](mailto:nick@dbpaul.co.uk)

**Authors:**

I.M Chedgy: *BSc (Hons), M Arbor A, AI Hort*

**The Arborist, Wells**

136a High Street  
Street, Somerset BA16 0ER  
07866 761029  
[imc@arborista.co.uk](mailto:imc@arborista.co.uk)

[Arb Association Membership No. PRO2047](#)

[Royal Forestry Society Membership No. 19278](#)



Arboricultural Impact Assessment & Method Statement  
The Old Inn, Green Ore

8<sup>th</sup> January 2024

**Contents:**

Contact Sheet...	page 1
Section 1.0 – Scope of the Report...	page 3
Section 2.0 – Arboricultural Impacts Assessment (AIA)...	page 3
Section 3.0 – Arboricultural Method Statement (AMS)...	page 4
Section 4.0 – Construction Exclusion Zone Statement...	page 6
Section 5.0 – AMS Summary...	page 7
Appendix 1 – Tree Protection Plan ...	page 8



## 1.0 Scope of The Report

1.1 *Instruction:* e-mail instruction from Nick German of DB & Paul 6/12 to prepare an Arboricultural Impact Assessment (AIA) to BS5837:2012 section 5.4 for trees likely to be a constraint to development at The Old Inn. The AIA is to include an Arboricultural Method Statement (AMS – section 3.0) that details mitigation recommendations to allow for the proposed development of the site while safely retaining selected trees.

1.2 *Tree identification:* The trees are those detailed in The Old Inn BS5837 Tree Survey dated 7<sup>th</sup> January 2024, the Tree Protection Plan (Appendix 2) and Drawing No. 7608W-05 dated 2/12/23 (Appendix 1).

1.3 Prioritising – recommendations made in the AIA/AMS are prioritised as:

- D – Desirable – for the general long-term benefit of the trees
- E – Essential – to ensure the compliance with the AIA/AMS

## 2.0 Arboricultural Impacts Assessment

2.1 The tree surveyed is within the bounds of the site, development is unlikely to encroach tree protection zones (TPZ). Low to moderate likelihood of canopy damage through development:

- Roots and Rhizosphere – low likelihood of damage through compaction and root severance
- Stem – low potential for impact damage
- Canopy – moderate potential for impact damage

2.2 *Site access* – the site will be accessed from the from the existing entrance off the B3135 Roemead Road, no impact on retained trees.

2.3 Arboricultural Supervision – wherever trees on or adjacent to the site have been identified within the tree protection process, there should be an auditable system of Arboricultural site monitoring and supervision (BS5837 section 6.3)

*Recommend (1) – the Project Arboriculturalist to deliver a prework toolbox talk to contractors, inspect and approve all pre-development tree works, the installation of tree protection fencing, excavations within 5m of TPZ's. Compliance with the requirements for Arboricultural supervision and monitoring shall be confirmed in-writing to the LPA Tree Officer at pre-commencement and on-going through the individual key stages of the project within 72 hours of each site visit:*

- *Pre-commencement tree work*
- *Pre-commencement installation of fencing, signage*
- *Pre-commencement toolbox talk with the appointed building contractors*
- *Supervision of groundworks/foundation installation and below ground services*
- *Certificate of conformance to confirm discharge of Arboricultural conditions*

**3.0 Arboricultural Method Statement**

**3.1 Tree Protection Fencing** – retained trees should be protected by temporary, fixed barriers (BS5837 section 6.2.2 Figure 1 below). The TPZ beyond the barriers should be considered sacrosanct, once installed the barriers should not be removed or altered without consultation with the Arboriculturist. Construction work, excavations or storage of materials should not take place within the TPZ. Extent of TPZ's set out in Table 2 below.

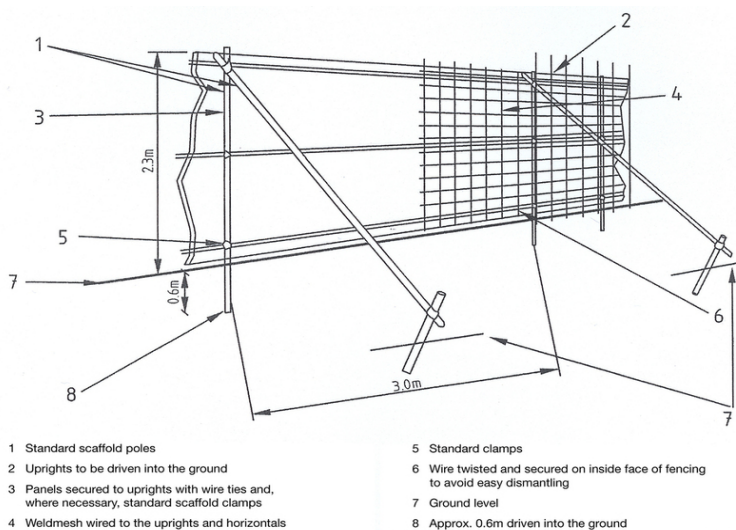

Figure 2. – Protective fencing for RPA

Tree protection fences should be clearly signed with all-weather notices stating:



**3.2 Tree Protection Zones** - trees and hedges selected for retention should be protected within a Tree Protection Zone (TPZ). This must be a construction exclusion zone of temporary fixed fencing (*BS5837 section 6.2.2 Figure 2 as appropriate*) that provides for a minimum RPA for each tree as Table 1 below (from BS5837 Annex D, table D1).

Tree No.	DBH (mm)	Radius of TPZ (m)	RPA (m <sup>2</sup> )
1	1060	12.6	499

Table 1 (*BS5837 Table D.1*)

**3.3 Access Facilitation** – moderate likelihood of lower branch damage through impact by construction machinery and delivery vehicles to retained trees.

*Recommend (2) - raise low canopies over the site to 3.6m prior to the commencement of works, cutting to natural target pruning points limiting cuts to 50mm diameter as practicable (ref: BS3998). Access facilitation pruning works to be supervised by the Arboriculturist (E).*

**3.4 Special Measures for Ground protection** – the root zone and its associated rhizosphere is a complicated and fragile place. Many complex interactions take place here that have far reaching effects on the health and wellbeing of trees. Trees may have root zones extending many metres beyond the canopy. These zones are vulnerable to damage from, but not limited to, compaction (foot fall, vehicles, rain), nitrification (*fertilizer application, slurries & farm waste, compost heaps*), soil disturbance (*excavation, burrowing*), water logging and pollution. Damage to the rhizosphere though apparently minor may take many years to manifest and be of great consequence.

*Recommend (3) - where pedestrian access or construction work is required adjacent to the TPZ ground protection is recommended. Ground protection should take the form of a temporary surface to reduce ground compaction (Fig 2). This should take the form of a multi-layered protective barrier as Fig 2 below (BS5837.2012 Section 6.2.3) as follows (D):*

- Base Layer – Undisturbed soil containing tree roots.*
- Layer 1 – 50 -100mm compressible material such as woodchip*
- Layer 2 – Geo-textile membrane (e.g., Terram 1000)*
- Layer 3 – 8' x 4' ply-wood boards*

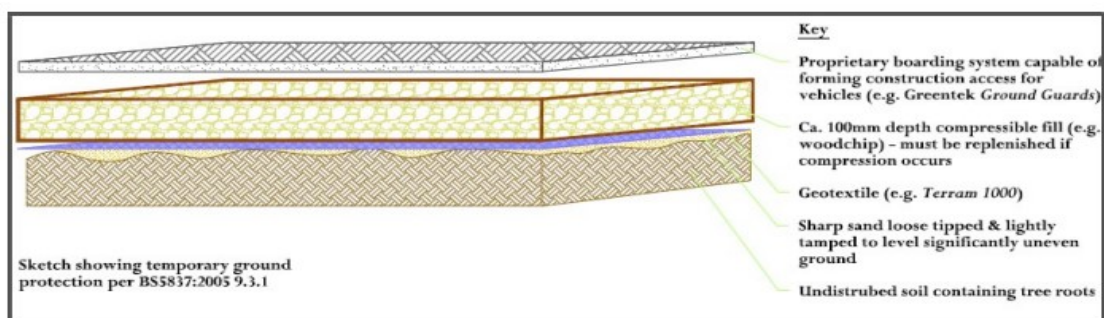

#### **4.0 Construction Exclusion Zone Statement**

It is the responsibility of everyone engaged in the construction process to respect the tree protection measures and observe the necessary precautions within and adjacent to the retained trees. Inside the exclusion zone, the following shall apply:

- No mechanical excavation whatsoever without LPA approval & Arboricultural supervision
- No excavation by any other means, to include hand digging, without a written method statement having first been approved by the Project Arboriculturalist
- No lowering of levels for any purpose (except removal of grass sward using hand tools)
- No storage of plant or materials
- No storage or handling of any chemical including cement washings
- No vehicular access
- No fires

In addition to the above, further precautions are necessary adjacent to all site trees:

- No substances injurious to tree health, including fuels, oil, bitumen, cement (including cement washings), builder's sand, concrete mixing and other chemicals shall be stored or used directly adjacent to the retained trees
- No fire shall be lit such that flames come within 10m of tree foliage.

**There will be no variation in tree protection measures unless approved by the Local Authority.**

**5.0 Arboricultural Method Statement Summary (Table 2)**

<i>Tree Identification</i>	<i>Impact</i>	<i>Management Proposals</i>
T1 Copper beech	High value, mature tree to be retained	Install protection fencing as Section 3.2 & Appendix 1 Fig 3
Arboricultural Works	Direct damage to canopies	Access facilitation pruning as Section 3.3
Post construction	Improve rooting environment post development	Remove ground protection Mulch site with 50mm composted bark mulch as practicable Treat rhizosphere with a single dose of beneficial fungi <i>Trichoderma sp.</i> trade name Avengulus as manufacturers recommendations <a href="https://mycosolutions.ch/produkte/avengulus/">https://mycosolutions.ch/produkte/avengulus/</a>
Site Monitoring	Potential damage to retained trees through inappropriate pruning works, incorrect position of barriers, encroachment into TPZ or excavation works	The Project Arboriculturist to carry out site visits to monitor tree works, installation of barriers & excavation works reporting satisfactory conformance to the LPA by email within 72 hours of each visit (as Section 2.3 above). Site visits scheduled at: <ol style="list-style-type: none"> <li>1. <i>Pre-commencement tree work</i></li> <li>2. <i>Pre-commencement installation of tree protection fencing, signage, and ground protection</i></li> <li>3. <i>Pre-commencement toolbox talk with the appointed contractors</i></li> <li>4. <i>Supervision of groundworks, foundation installation and below ground services</i></li> </ol>

Appendix 1 – Indicative Tree Protection Plan from drawing no. 7608W-05 (2/12/23)

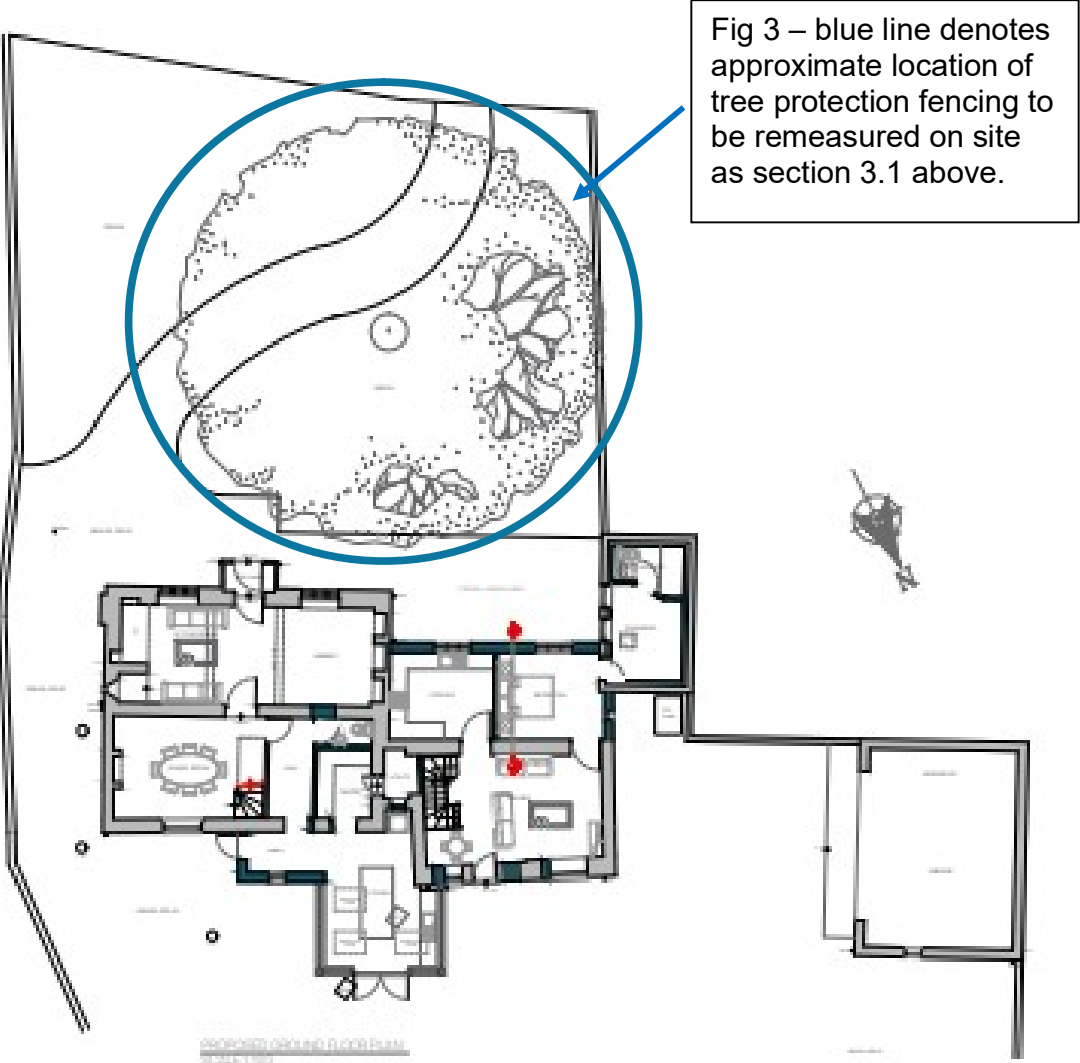



Arboricultural Impact Assessment & Method Statement  
The Old Inn, Green Ore

8<sup>th</sup> January 2024