

# Arboricultural Report; Paragraphs relevant to BS: 5837:2012, 2024 application, Valley View, Roydon Road, Harlow

## 4.5 See Tree Survey Sheet Diagram ARB01 Topographic Survey

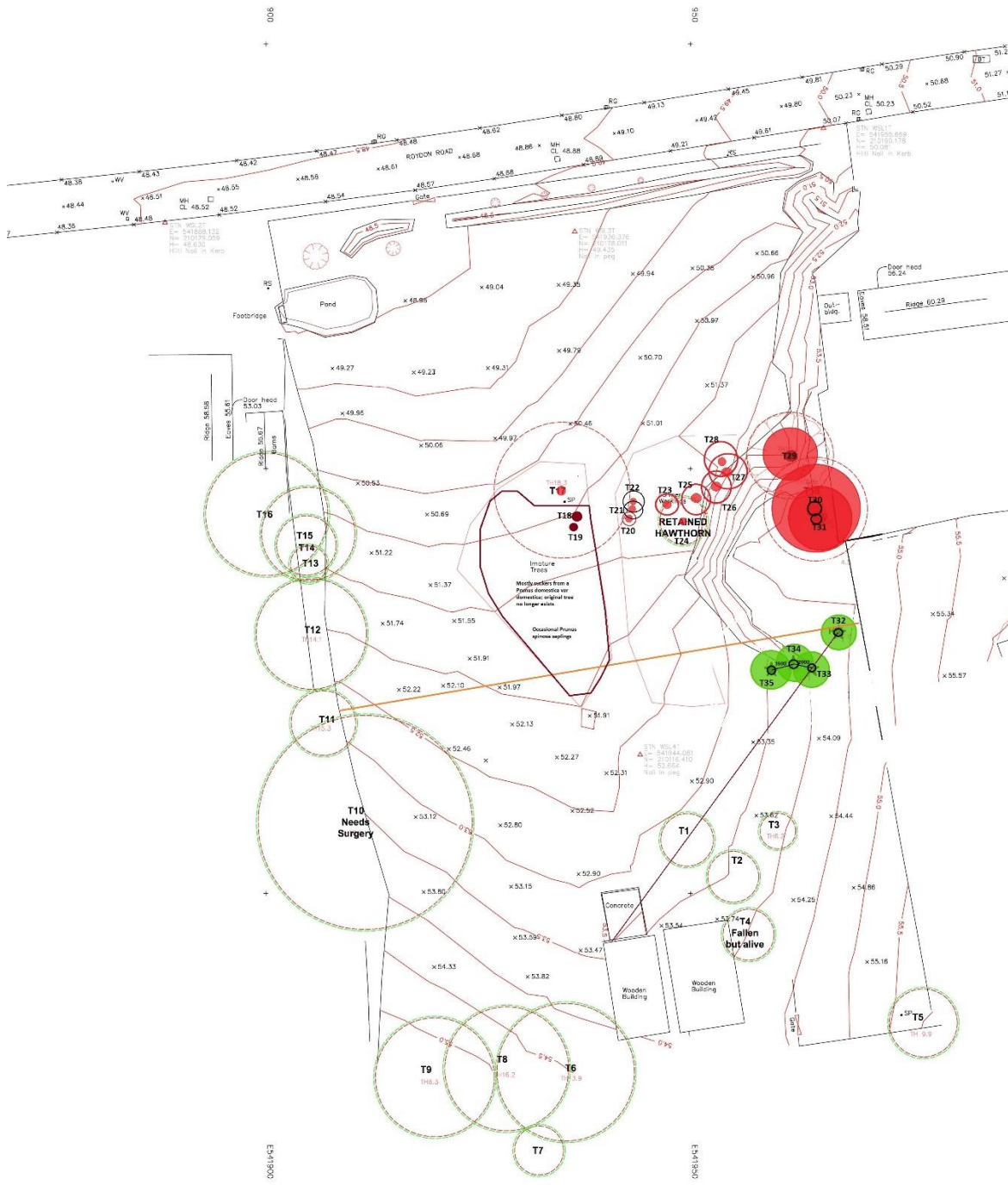

SITE PLAN - ROYDON ROAD, HARLOW

ISSUE	DESCRIPTION	DATE	BY

<small>14th Floor, 200, The Quadrant, Canary Wharf, London E14 4EU                  Tel: 020 7494 4000 Fax: 020 7494 4100                  Email: info@pellam.co.uk Website: www.pellam.co.uk</small>	
Project Name: Roydon Road	
Date: 12/02/2024	ARB Plan
Drawn: JAO	Checked: 16/02/2024
Title: ARB01	Scale: 1:100

Drawing ARB01 original tree plan prior to any planning consent; showing contours.

Proposed application.

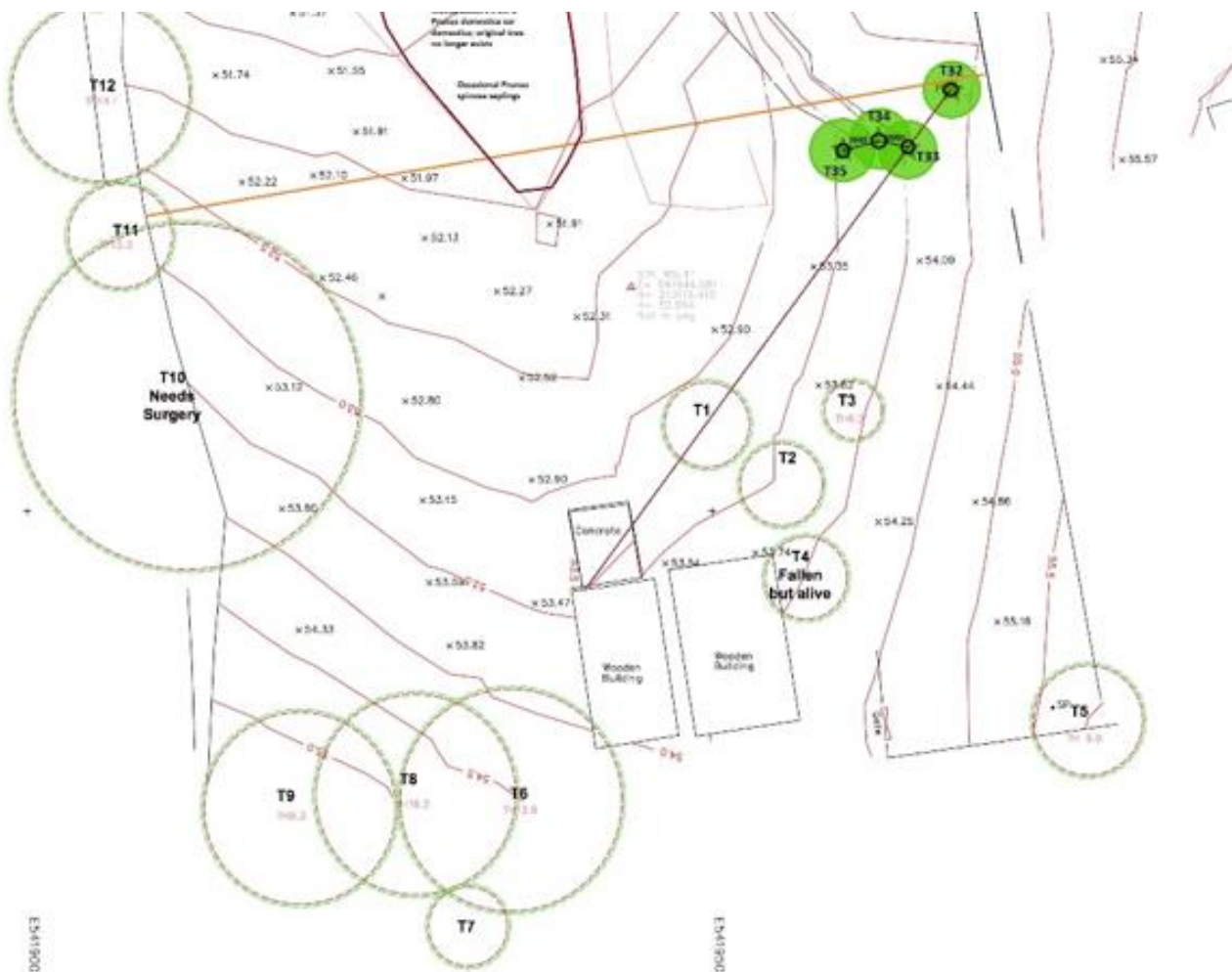

Tree Data Sheet for this application site, the original numbering has been retained.

Tree	Species	English	N	E	S	W	Height	Diameter	RPA	Condition	Comments	
											To be	
T1	Malus domestica	Cultivated apple	4000	3000	3000	3500	6500	180,180,170	3100	B1	Removed	
T2	Malus domestica	Cultivated apple	3500	5000	5000	5000	8000	220,200	3000	B1	Removed	
T3	Malus domestica	Cultivated apple	2000	2000	3000	3000	5500	160,130	2100	B1	Removed	
T4	Malus domestica	Cultivated apple	N/A	N/A	N/A	N/A	N/A	N/A	N/A	U Fallen	Removed	
T5	Crataegus monogyna	Hawthorn	5000	5000	5000	5000	10000	320,170,150,100	4000	A1	Retained	
T6	Carpinus betulus	Hornbeam	8000	9500	9500	8500	13000	500,500,400	8100	B1	Retained	
T7	Ulmus sp.	Elm	0	0	4000	5500	11000	240	2880	A1	Retained	
T8	Acer pseudoplatanus	Sycamore	8500	5500	5500	6500	14000	540,300,300,250	7300	B1	Retained	
T9	Corylus avellana	Hazel	8000	8000	8000	8000	7500	24 stems 220-120 #	7000#	A1	Retained	
T10	Acer pseudoplatanus	Sycamore	12000	12000	12000	12000	16000	1,050	12600	A1	Retained	
T11	Acer pseudoplatanus	Sycamore	2500	2500	0	2500#	9000	220,200,140,140,120	3800	B2	Retained	
T32	Acer pseudoplatanus	Sycamore	6000	6000	6000	6000	16000	330,320,280,260,170 ,(150 gone)	6200	B2	Retained	
T33	Acer pseudoplatanus	Sycamore	6000	3000	7000	6000	17000	400 + 400 + 260	6200	B1	Retained	
T34	Acer pseudoplatanus	Sycamore	6000	6000	7000	6000	17000	620	7440	A1	Retained	
T35	Acer pseudoplatanus	Sycamore	0	200	7000	3000	15000	360 + 250	4400	B2	Retained	
H1	Cupresso x leylandii	Leyland Cypress	480	20 trees mostly <300 in diameter but most southerly tree = mostly <300 diameter;					most southerly tree = 480	5800 line from hedge		Retained
	Numerous suckers from Prunus domestica ssp domestica with the occasional Prunus spinosa / Prunus x fruticans removed								Height 3500 mm		To be	

# Proposed site layout

rm



# Tree protection and construction plan

rm

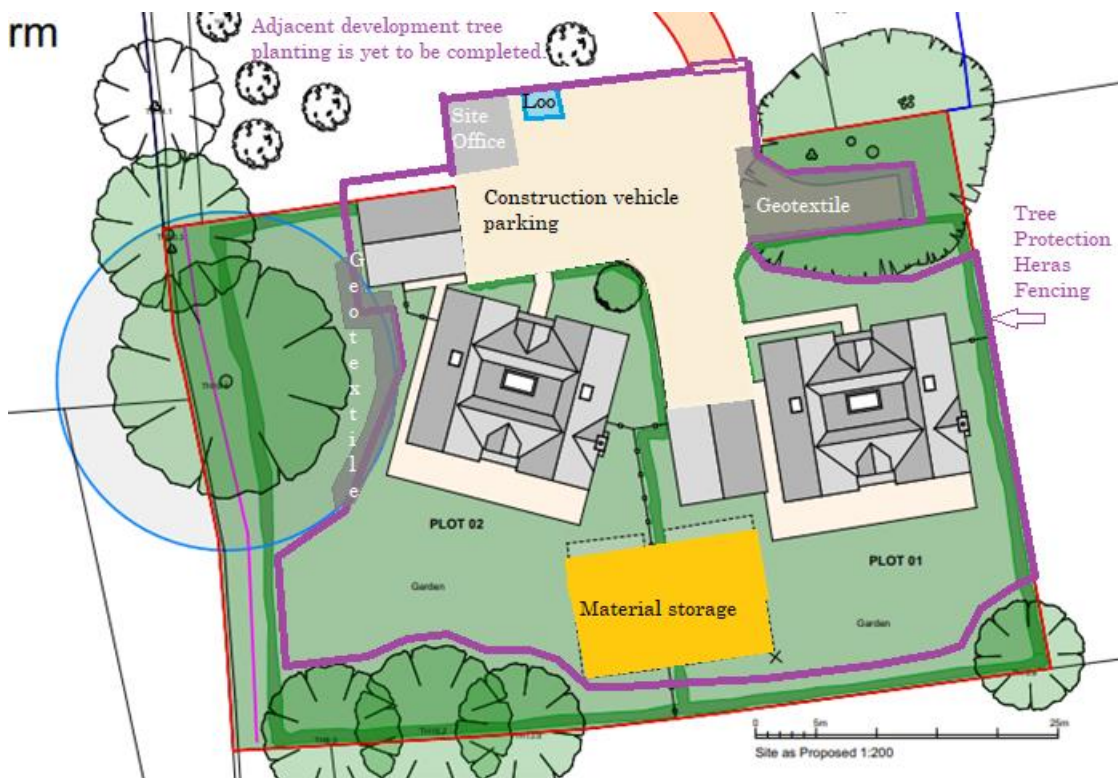

# Biodiversity enhancement plan



Tree No	Species	English	Rootstock	Height
T1a	<i>Corylus avellana</i>	Hazel	Bare root	150/200
T1b	<i>Syringa vulgaris</i>	Lilac	Container	Half standard
T1c	<i>Corylus avellana</i>	Hazel	Bare root	150/200
T1d	<i>Sobus torminalis</i>	Wild Service Tree	Container	Half standard
T1e	<i>Prunus padus</i>	Bird Cherry	Container	Half standard
T2a	<i>Syringa vulgaris</i>	Lilac	Container	Half standard
T2b	<i>Syringa vulgaris</i>	Lilac	Container	Half standard
T2c	<i>Corylus avellana</i>	Hazel	Bare root	150/200
T2d	<i>Corylus avellana</i>	Hazel	Bare root	150/200
T2e	<i>Betula pendula</i>	Silver Birch	Container	Half standard
T2f	<i>Betula pendula</i>	Silver Birch	Container	Half standard
T2g	<i>Corylus avellana</i>	Hazel	Bare root	150/200
Hedge H1	<i>Crataegus monogyna</i>	Common Hawthorn	Bare root	600 mm
	<i>Ligustrum vulgare</i>	Wild Privet	Bare root	600 mm
	<i>Carpinus betulus</i>	Hornbeam	Bare root	600 mm
	<i>Corylus avellana</i>	Hazel	Bare root	600 mm
	<i>Lonicera periclymenum</i>	Honeysuckle	2 litre pot	300 mm

Hedge H2	<i>Crataegus monogyna</i>	Common Hawthorn	Bare root	600 mm
	<i>Carpinus betumus</i>	Hornbeam	Bare root	600 mm
Hedge H3	<i>Crataegus monogyna</i>	Common Hawthorn	Bare root	600 mm
	<i>Ligustrum vulgare</i>	Wild Privet	Bare root	600 mm
	<i>Carpinus betulus</i>	Hornbeam	Bare root	600 mm
	<i>Lonicera periclymenum</i>	Honeysuckle	2 litre pot	300 mm
Hedge H4	<i>Carpinus betulus</i>	Hornbeam	Bare root	600 mm

Hedge 1	Species	English	Length	Height	%	Planting
	<i>Crataegus monogyna</i>	Common Hawthorn	88000	1500	40	Double row 5 plants per metre
	<i>Ligustrum vulgare</i>	Wild Privet			20	
	<i>Carpinus betulus</i>	Hornbeam			20	
	<i>Corylus avellana</i>	Hazel			15	
	<i>Lonicera periclymenum</i>	Honeysuckle			5	

Hedge 2	Species	English	Length	Height	%	Planting
	<i>Crataegus monogyna</i>	Common Hawthorn	26000	1200	50	Single row 3 plants per metre
	<i>Carpinus betumus</i>	Hornbeam			50	

Hedge 3	Species	English	Length	Height	%	Planting
	<i>Crataegus monogyna</i>	Common Hawthorn	29000	1800	40	Single row 3 plants per metre

	Ligustrum vulgare	Wild Privet			20	
	Carpinus betulus	Hornbeam			35	
	Lonicera periclymenum	Honeysuckle			5	
Hedge 4						
	Carpinus betulus	Hornbeam	24000	1500	100	Single row
						3 plants per metre 1

A. R. A. 31<sup>st</sup> January 2024