

12242 O/A LENGTH

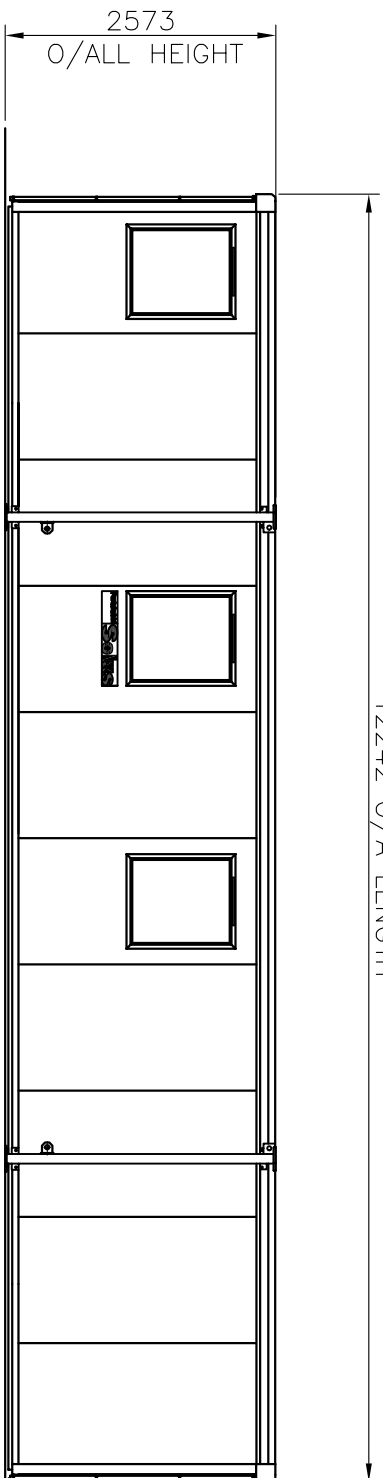

REAR ELEVATION

3398 O/ALL WIDTH

3266 *

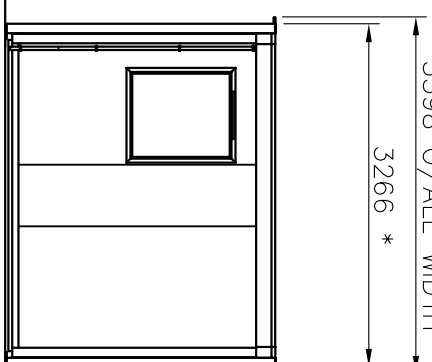

END ELEVATION

* NOTE O/ALL WIDTH FOR CONTINENTAL EUROPEAN BUILDINGS

DOOR & WINDOW POSITIONS MAY BE DIFFERENT TO THOSE SHOWN ON SPECIFIC CONTRACT DRAWINGS

STANDARD COLOURS

- External : Wall Cladding, Fascia, Corner & Bottom Wall Trims
- Sales & Scottish Divisions – Albatross nearest BS ref. 18 B 17
 - Hire & European Divisions – Goosewing Grey nearest BS ref. 10 A 05
 - Sales & Scottish Divisions – Britannia Blue nearest BS ref. 18 E 58
 - Hire – Merlin Grey nearest BS ref. 18 B 25
 - Portalo & Events – Poppy Red nearest BS ref. 04 E 53
 - European Division – Goosewing Grey nearest BS ref. 10 A 05
 - Silver Anodised Aluminium.
 - Manhattan Grey NCS S 2502-Y RAL-DS 080 70 05.
 - Sales & Scottish Divisions – Britannia Blue nearest BS ref. 18 E 58
 - Hire – Grey nearest RAL 7042
 - Portalo & Events – Blue Grey nearest BS ref. 18 B 29
 - European Divisions – Blue Grey nearest RAL 5011
 - White nearest BS ref. 00 E 55
 - Grey to BS4800 ref. 10 A 05
 - Hot dipped galvanised
- Door Frame
Door Furniture
Windows
- Hire nearest RAL 7042
 - Manhattan Grey NCS S 2502-Y RAL-DS 080 70 05.
 - Sales & Scottish Divisions – Britannia Blue nearest BS ref. 18 E 58
 - Hire – Grey nearest RAL 7042
 - Portalo & Events – Blue Grey nearest BS ref. 18 B 29
 - European Divisions – Blue Grey nearest RAL 5011
 - White nearest BS ref. 00 E 55
 - Grey to BS4800 ref. 10 A 05
 - Hot dipped galvanised
- Roof
Outer Legs
Inner Legs

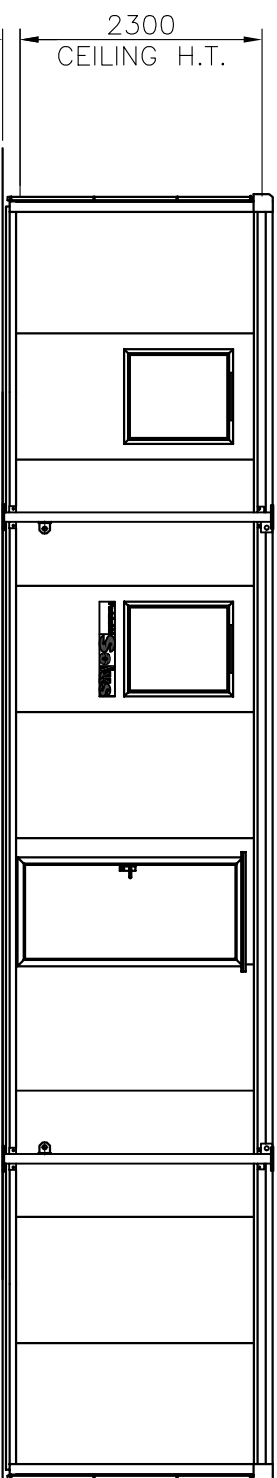

FRONT ELEVATION

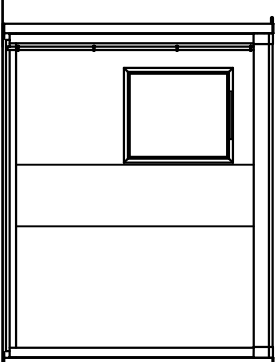

END ELEVATION

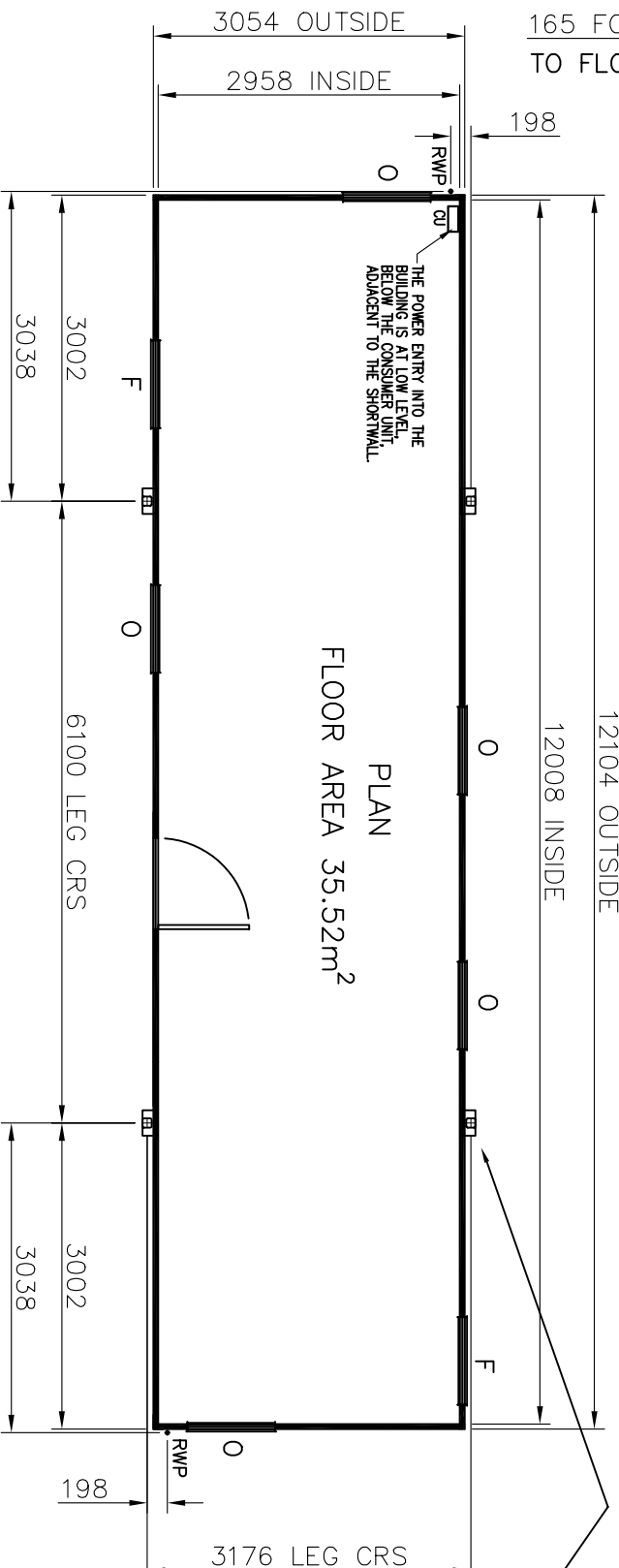

FLOOR AREA 35.52m²

LEG BASEPLATE DETAIL

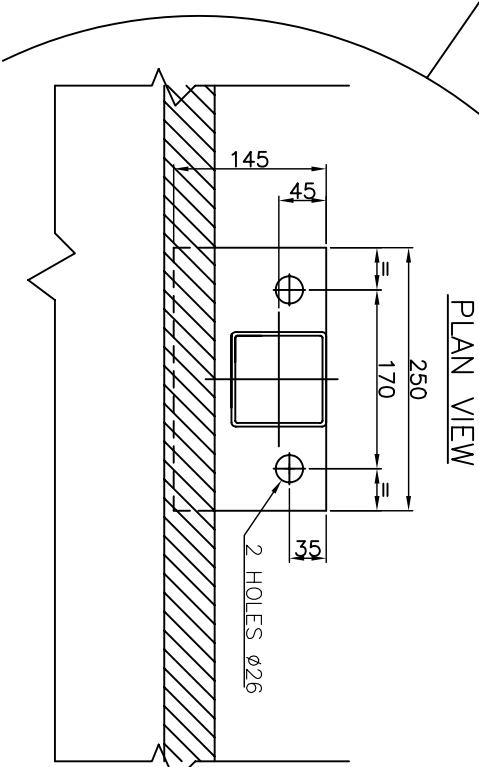

FOUNDATIONS

Simple foundations of level hardstandings are required to be capable of taking the foundation design load at each foot position of 42kN, which includes the dead weight of the building, imposed floor load of 3kN/m², imposed roof load of 0.75kN/m², and a basic wind speed to meet the requirements of BS6399: Part 2.

The foundations are to be designed in accordance with BS8004 with level tops of a tolerance of ±3mm.

The area of ground under the building, plus a surrounding 500mm must be no higher than 50mm below the tops of the building foundations.

KEY

- O OPEN WINDOW
- F FIXED WINDOW
- RWP RAIN WATER PIPE
- CU CONSUMER UNIT



Portakabin Limited Huntington York YO32 9PT
Telephone 01904 611655 Fax 01904 611644

Project PORTAKABIN SOLUS

Client

Title	
SPECIFICATION DRAWING	
SL122	
L ODASTRUT LEG OPTION	
Date	Drawn
2.10.07	R.SCHOFIELD

Scale	
1:5 & 1:50	
Drng. No.	Rev.
DQ2697	C