





STANDARD FORM TREES		
	Girth size in cm	
Acer campestre	12-14cm	W.R.B
Betula pendula	12-14cm	W.R.B
Carpinus betulus	14-16cm	W.R.B
Sorbus aria	14-16cm	W.R.B
Tilia cordata	14-16cm	W.R.B

CONIFEROUS TREES		
	Size	
Pinus sylvestris	2-2.5m tall	W.R.B

FEATURE TREES AND TOPIARY		
	Size	
Box headed Carpinus betulus	2m clear stem, 1m	W.R.B
Taxus baccata domes	1.5m diameter	

NATIVE MIX HEDGEROW		
	% of mix	Size
Prunus spinosa	15	0.6-0.8cm
Crataegus monogyna	35	0.6-0.8cm
Ilex aquifolium	20	0.6-0.8cm
Viburnum opulus	10	0.6-0.8cm
Corylus avellana	10	0.6-0.8cm
Rosa canina	5	0.6-0.8cm
Sambucus nigra	5	0.6-0.8cm

ORNAMENTAL SHRUBS		
	Size in cm	Root Condition
SHRUBS		
Euonymus alatus 'Compacta'	30-40cm	10L
Choisya ternata 'Aztec Pearl'	30-40cm	10L
Cornus alba	30-40cm	10L
Euonymus 'Gaiety'	30-40cm	10L
Hydrangea arborescens 'Annabelle'	60-80cm	10L
Hydrangeaphum (Herbatafreude Group)	30-40cm	5L
Lavandula angustifolia 'Hidcote'	30-40cm	10L
Pieris 'Forest Flame'	30-40cm	5L
Pittosporum 'Tom Thumb'	30-40cm	5L
Rosmarinus officinalis	30-40cm	5L
Skimmia japonica 'Rubella'	40-60cm	10L
Skimmia x confusa 'Kew Green'	40-60cm	10L
Viburnum tinus	40-60cm	10L
Viburnum davidii	40-60cm	10L
HERBACEOUS PLANTS		
Agua reptans	N/A	3L
Astrantia major	N/A	3L
Bergenia cordifolia	N/A	3L
Geranium x oxonianum 'Wargrave Pink'	N/A	3L
Heuchera villosa 'Palace Purple'	N/A	3L
Liriope muscari	N/A	3L
Polystichum aculeatum	N/A	3L
Persicaria affinis	N/A	3L
Saxifraga x urbium	N/A	3L
Tiarella cordifolia	N/A	3L
Persicaria affinis	N/A	3L
CLIMBERS		
Hydrangea petiolaris	2m	10L
Hedera helix	2m	10L
Trachelospermum jasminoides	2m	10L

- Existing Trees
Refer to Arboricultural Report by ACS Consulting
- Root Protection Area
Refer to Arboricultural Report by ACS Consulting
- Trees to be Removed
Refer to Arboricultural Report by ACS Consulting
- Proposed Standard Form Trees
Refer to indicative schedule
- Proposed Coniferous Trees
Refer to indicative schedule
- Proposed Box Headed Trees
Refer to indicative schedule
- Proposed Mixed Native Hedgerow
Refer to indicative schedule
- Shrub Borders
Areas of proposed shrubs planting 450mm depth of 'As Dug' topsoil to BS.
- Proposed Topiary
Refer to indicative schedule
- Grass
- Wildflower and Grass Meadow Mix
- Existing & Proposed Buildings
See Plans by Henry Kennedy & Associates for details
- Stabilised Gravel Driveway
Loose gravel in stabilising grid
- Parking Bays
Demarcated with block units 'T' shape within the gravel surface
- Turning head and ambulance space
- Block paving footpaths
- Stone Sett Threshold
- Hoggin footpaths to garden
Self binding gravel
- Stone pave steps with Brick walls to grass embankments in garden
- Reinstated historic footpaths within woodland
Management of existing woodland and reinstate rides/service paths, to double up as recreational walking loops through the woods
- Existing and Proposed Levels

NOTES:

Preparation of Ground Flora Areas
Rubbish, concrete, metal, glass and decayed vegetation are to be removed and disposed of off site.
Stones with the largest dimension exceeding 75mm are to be removed from planting beds and disposed of off site.
Substances injurious to plant growth including subsoil, rubble, fuel and lubricants should be removed and disposed of off site.
Existing scrub and weed layer to be removed from site or chopped up to be incorporated during cultivation.
Move soil around site to create required levels. Levels to be agreed on site.
Control of weeds by repeated applications of a herbicide (e.g. glyphosate) over the growing season and/or repeated cultivation to exhaust weeds (following).
Unwanted vegetation can be cut back and removed from site or chopped up to be incorporated during cultivation.

Preparation of Planting Beds
Rubbish, concrete, metal, glass and decayed vegetation are to be removed and disposed of off site.
Stones with the largest dimension exceeding 75mm are to be removed from planting beds and disposed of off site.
Substances injurious to plant growth including subsoil, rubble, fuel and lubricants should be removed and disposed of off site.
Remove any existing weed growth.
Areas of large root are to be grubbed up without undue disturbance of surrounding soil and adjacent areas.
All site preparation, planting and maintenance to comply with BS 4429.

Mulch
At completion carefully spread a general purpose mulch prepared in accordance with PAS 100 - to an even depth of 5cm to all ornamental planted areas (sample supplier Green Tech Tel: 01423 332100)

Native Hedges and Woodland Planting
Native hedging and woodland whip plants to be protected from rabbits using rabbit guards.
To be kept free of weeds during establishment using secured mulch matting.
Bare root plants to be notch planted to depth of root collar in accordance with BS4429.
Container grown plants to be planted to depth of original root collar in accordance with BS4428.
All plants planted into mulch mats to be planted with appropriate long release fertiliser pellets (e.g. Comocote Tel: 01282 873333), applied in accordance with the manufacturer's recommendations and directions.
Selective thinning for long term management to be undertaken every 5 to 7 years until woodland structure attained.

Tree Stakes
Stakes to be 65mm diameter tanalised softwood and pointed at one end. Top of stake to be 600mm above ground level and fixed to tree with 1 No suitable rubber tie. Stake to be firm in ground, position stake at time of planting.

SCHEDULE OF IMPLEMENTATION
Note: sizes shown are minimum.
The landscape works shall be carried out within 12 months from the date when building works are complete.
Bare root and rootballed stock to be planted within the winter planting season (October to March).
Seeding to be undertaken in Spring.
Trees and large stock plants to be planted first.

Plants/Trees General
To be materially undamaged, sturdy, healthy and vigorous in condition.
To be of good shape without elongated shoots and characteristic of the species.
To be grown in a suitable environment in order to be fully hardy.
To be free from pests, discoloration, weeds and physiological disorders.
Budded or grafted plants to be bottom worked.
All trees, hedging, shrubs and plants to comply with BS 3098 specification for nursery stock.
Species will be true to name and of British origin/provenance where appropriate.
Do not substitute species, variety and form, or reduce the specified number/density of plants without prior agreement.
Read with drawings and reports by Arboricultural Consultant.
Do not plant within rainshadow under a roof overhang.
All planting to be watered as required immediately after planting.
All new trees to be positioned in accordance with the requirements of Table A.1, BS5837:2012.
All new turf to be fine quality e.g. Festival by AllTurf or equivalent and laid in accordance with BS 3099 1998 + A1:2013.
Any works to existing trees to be carried out in accordance with the guidance set out in BS3998:2010.

Unit 6, Longley Lane
Northenden, Manchester
M22 4WT

T: 0161 946 0808
E: design@barneswalker.co.uk
W: www.barneswalker.co.uk

DWG NO. M3551-PA-01-V4
CLIENT: Springcare Ltd
WORK STAGE: PLANNING
SCALE: 1:500@A1

DWG TITLE: LANDSCAPE LAYOUT
PROJECT TITLE: Hinton Hall, Tarporley Road
DATE: 10.2022
DRAWN BY: AC
CHECKED BY: MW

© This document, its graphics and its landscape works and ideas described therein remain the copyright of Barnes Walker Limited and may not be used, copied in whole or part, or amended without prior written consent. Figure dimensions to be followed in preference to scaled and all dimensions are to be checked on site and in the event of any discrepancy refer to Barnes Walker Limited.

1/2 - Amended driveway alignment_05.10.22_ac
V3 - Amended parking places_26.06.23_ac
V4 - Bin store and path added; road adjusted_23.06.23_ac

bw
BARNES WALKER

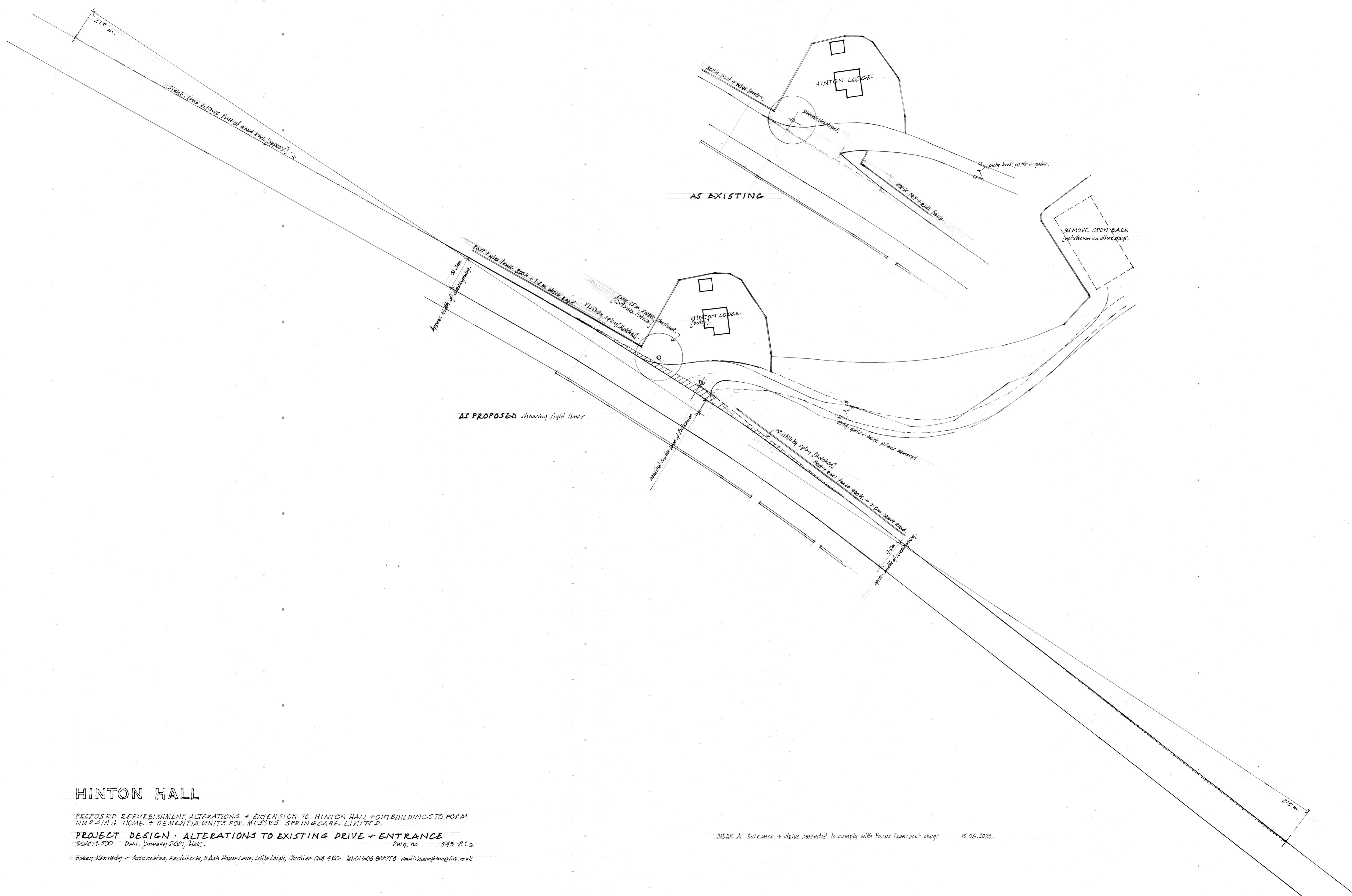

HINTON HALL

PROPOSED REFURBISHMENT, ALTERATIONS + EXTENSION TO HINTON HALL + OUTBUILDINGS TO FORM NURSING HOME + DEMENTIA UNITS FOR MESSRS. SPRINGCARE LIMITED.

PROJECT DESIGN - ALTERATIONS TO EXISTING DRIVE + ENTRANCE

Scale: 1:500 Dwn. January 2021, HEC.

Dwg. no. 543-21.a

Harey Kennedy + Associates, Architects, 3 Ash House Lane, Little Leigh, Chester CH6 4RG Tel: 01606 882758 email: harenkenn@live.co.uk

INDEX A Entrance + drive amended to comply with Focus Transport changes 15.06.2023.

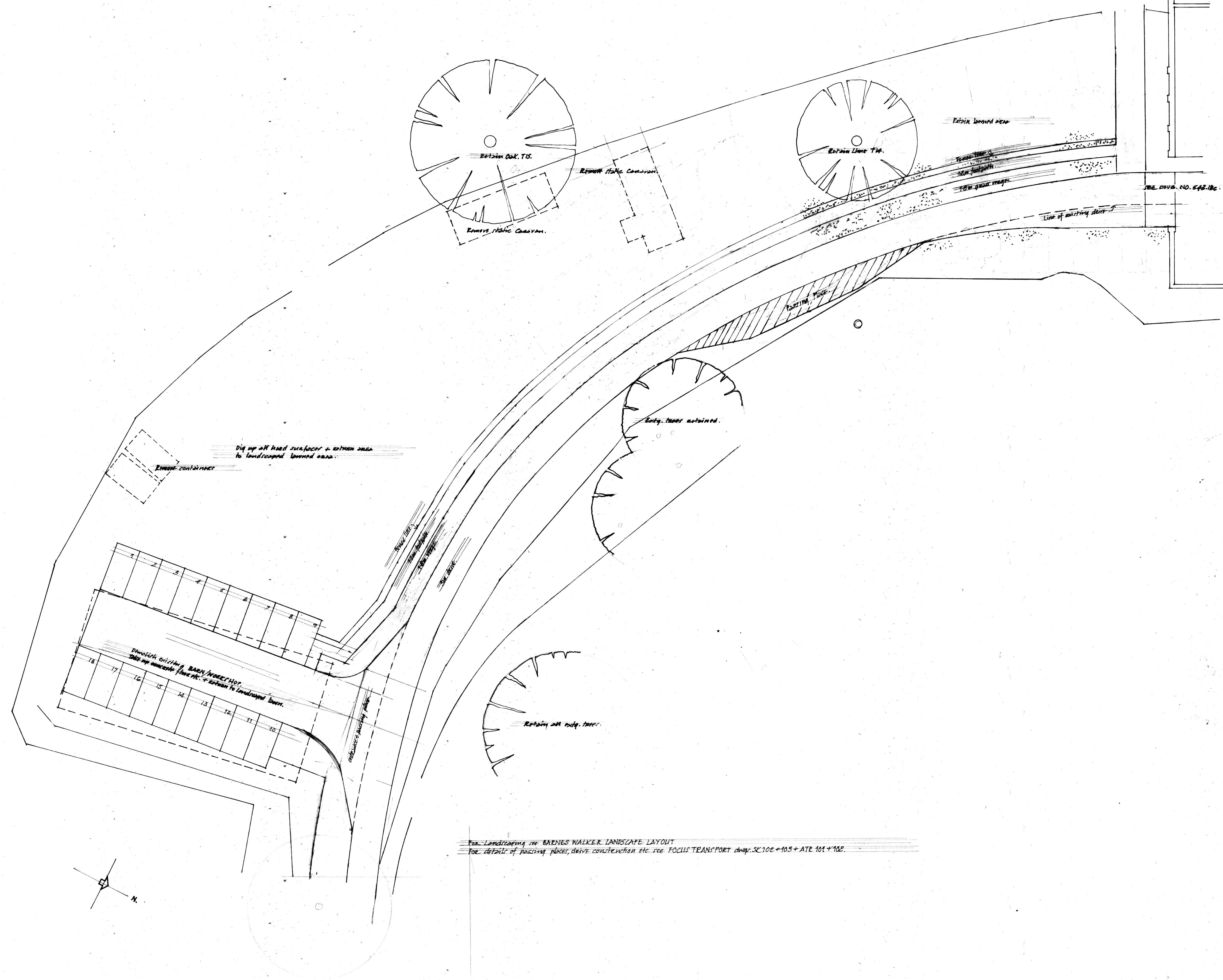

HINTON HALL

PROPOSED REFURBISHMENT ALTERATIONS + EXTENSIONS TO HINTON HALL + OUTBUILDINGS TO FORM NURSING HOME + DEMENTIA UNITS FOR MESSRS. SPRING CARE LIMITED

PROJECT DESIGN - LAYOUT PLAN 2.

Scale 1:200 DWG. July 2022/NAK.

Dwg. no. 545-22b.

Honey Kennedy + Associates, Architects, 5 Ash House Lane, Little Leigh, Cheshire CH14 2RS. Tel. 01806 892 753 email: hka@honeykennedy.co.uk

For Landscaping see BARNES WALKER LANDSCAPE LAYOUT
 For detail of parking places, drive construction etc. see FOCUS TRANSPORT DWG. SC 102 + 103 + ATE 101 + 102.