

No.	Description	Date
P01	Kitchen window and Sink location change	19/01/24
P02	Width increased 200mm	01/02/2024
P03	Postcode change	02/02/24

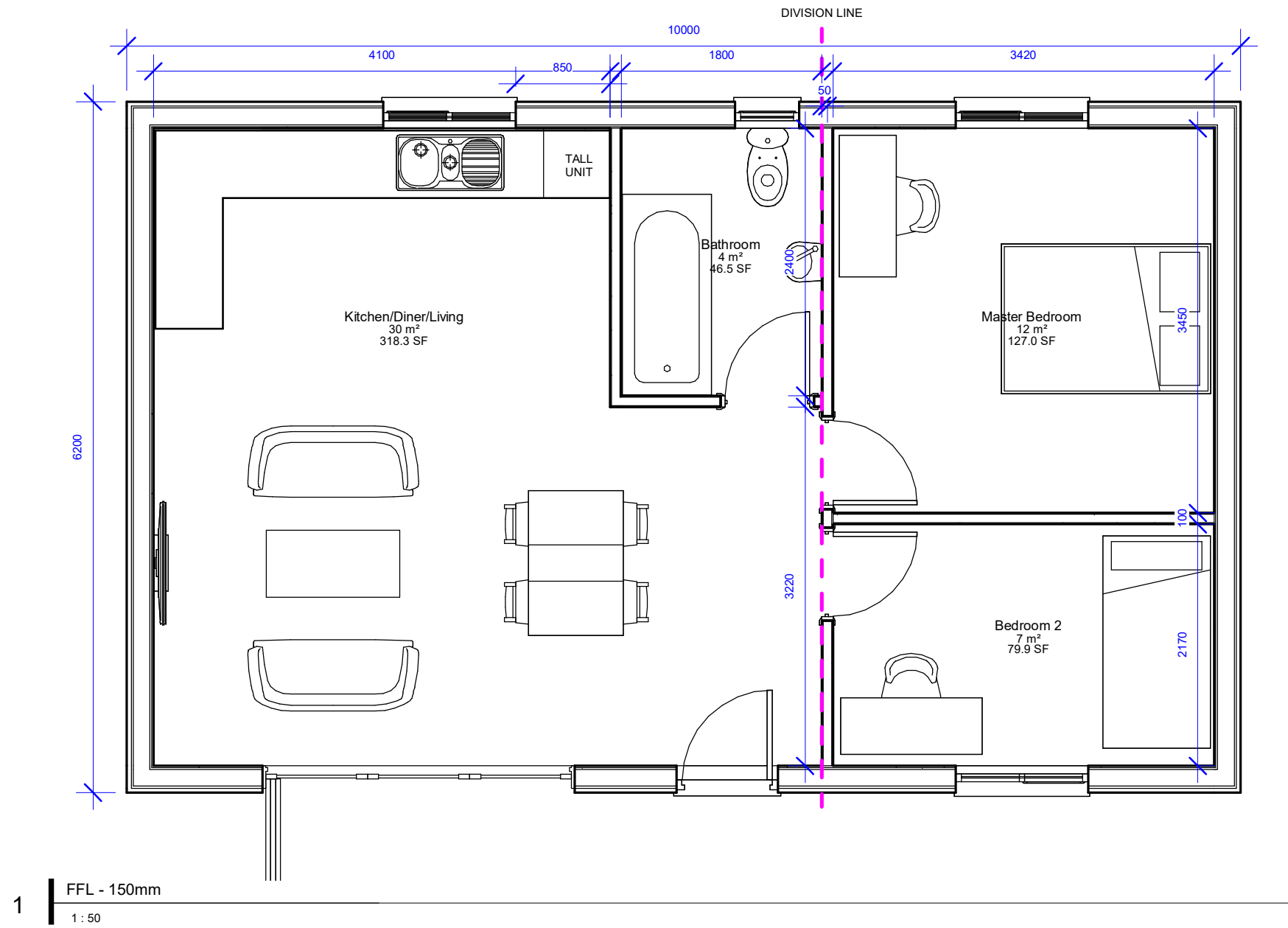

Note :  
 - Do not scale. Only use figured dimensions.  
 - All information contained within this drawing remains the copyright of ASM Architecture and must not be copied without written consent from the owner.

**ASM Architecture**  
 1 Sunningdale Grove, Heighington, Lincoln, Lincolnshire, LN4 1SP  
 T: (01522) 538026 M: 07804 895682  
 E: alex@asmarchitecture.co.uk W: www.asmarchitecture.co.uk

Family Annexe - 286 Old Worting Road,  
 Basingstoke, RG22 6PD  
 Proposed Floorplan

STATUS			
PLANNING			
Scale (@ A1) 1 : 50	Date 10/07/23	Drawn By JH	Chkd By ASM
1001			P03
DRAWING NUMBER			REV

Drawing