

**Digital Format Users:** Please note that drawing has been produced to a degree of accuracy commensurate with the scale and paper size indicated in the title panel below and any dimensions extracted should be treated as such. Only figured dimensions should be used.

**All users:** Where applicable, please use largest scale drawings / details available and refer to all relevant specifications and schedules.

**Survey Information:** All survey dimensions and information relating to the existing fabric have been taken and produced to a degree of accuracy commensurate with the scale indicated in the title panel below and any dimensions extrapolated should be treated as such. Measured surveys must not be relied upon by contractors for fabrication of critical elements and site check dimensions should be made by the contractor prior to manufacture of such items.

Survey Information provided by:  
TOPOGRAPHICAL SU2391\_2D-1

**CONSTRUCTION EXCLUSION ZONE**

**KEEP OUT!**

WITHOUT WRITTEN PERMISSION OF THE LOCAL PLANNING AUTHORITY:

- THE PROTECTIVE FENCING MUST NOT BE MOVED
- NO PERSON SHALL ENTER THE PROTECTED AREA
- NO MACHINE OR PLANT SHALL ENTER THE PROTECTED AREA
- NO MATERIALS SHALL BE STORED WITHIN THE PROTECTED AREA
- NO SPOIL HEAP SHALL BE DEPOSITED WITHIN THE PROTECTED AREA
- NO EXCAVATION SHALL OCCUR WITHIN THE PROTECTED AREA

A3 sign laminated all-weather material at 1.8m high on the protective fencing every 10m

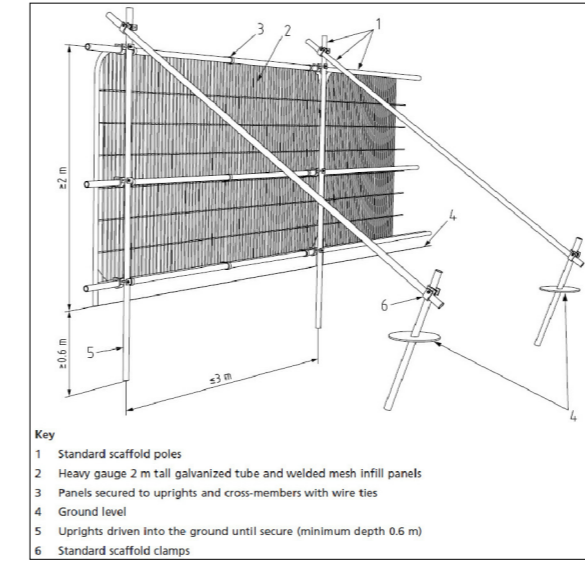

**A: Heras fencing Tree Protection as shown:**

**B: A3 notice to Tree Protection fencing**

**Drawing Permissions:**  
This drawing is intended only for use by the Client named below and only in relation to the Project detailed below and only for the purpose of:

**PLANNING APPLICATION**

Use by any other person and / or for any other use is not permitted without the express written permission of BWP Architects Ltd

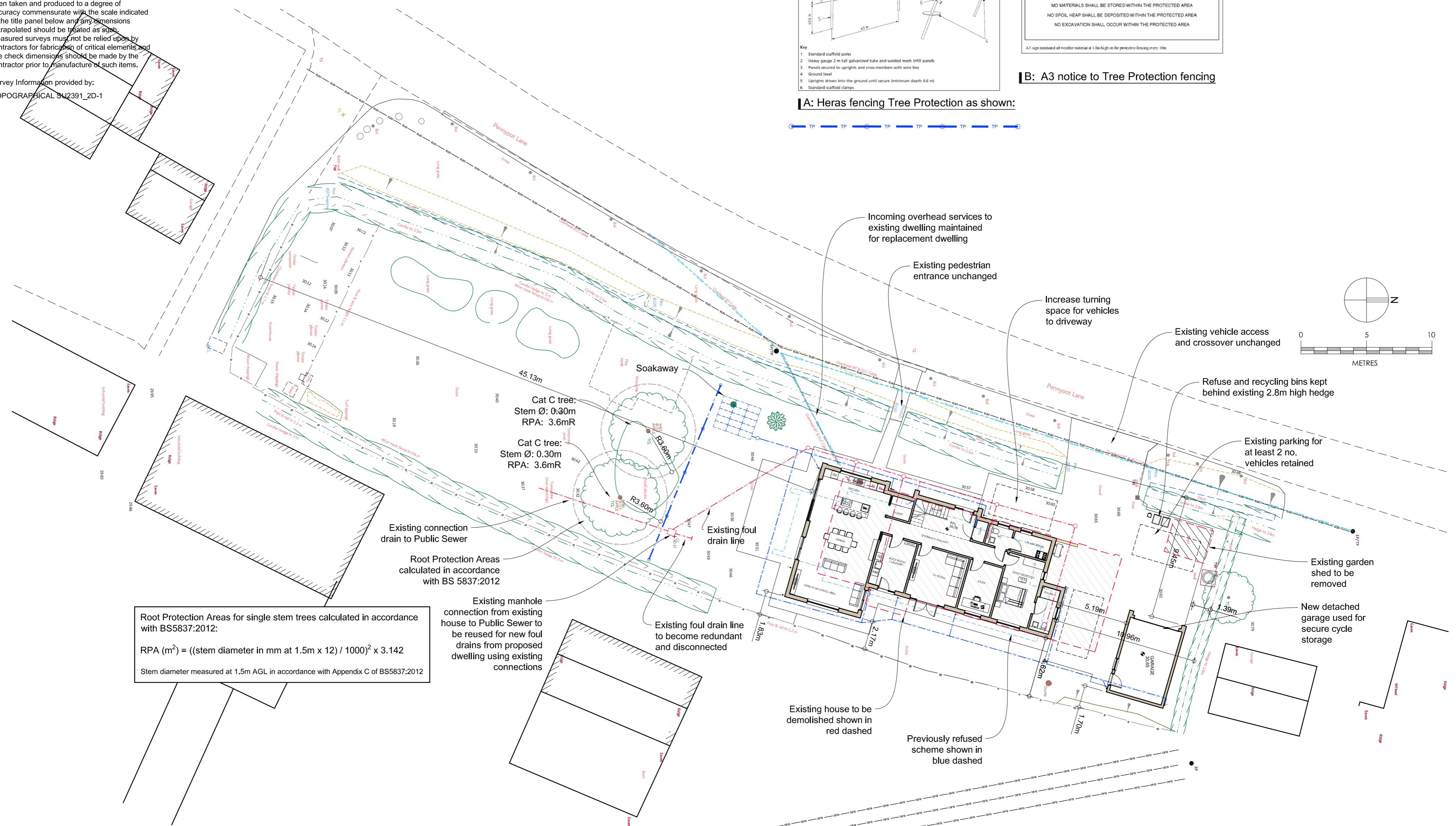

Root Protection Areas for single stem trees calculated in accordance with BS5837:2012:  
 $RPA (m^2) = ((\text{stem diameter in mm at } 1.5m \times 12) / 1000)^2 \times 3.142$   
 Stem diameter measured at 1.5m AGL in accordance with Appendix C of BS5837:2012

**REPLACEMENT DWELLING AND DETACHED GARAGE, FAIRFIELDS, PENNYPOT LANE, CHOBHAM, GU24 8DJ**

FOR  
I. DALTON & H. BLAKELEY  
SITE PLAN

PROJECT No.: FPL2012  
DRAWING No.: PL01 / B  
SCALE @ A2: 1:200

