

NOTE: this drawing is to be read in conjunction with the Engineers Structural Calculations

G. R. Sexton C.Eng., MICE

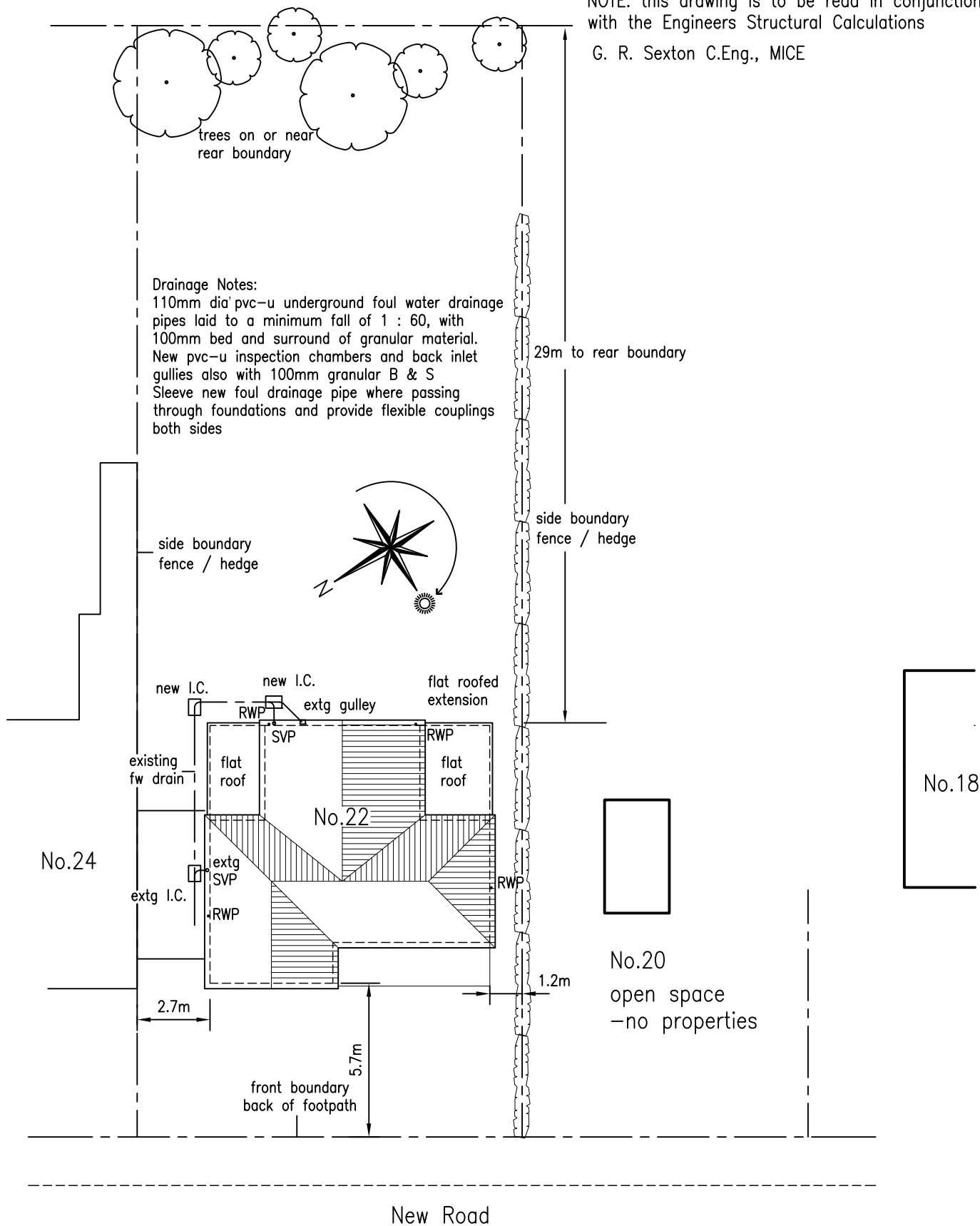

### Block Plan

scale 1 : 200

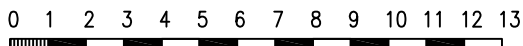

#### SEXTON DESIGN SERVICES

BUILDING, CIVIL, & STRUCTURAL  
ENGINEERING SERVICES

21A Empress Avenue, West Mersea,  
CO5 8EX, tel & fax 01206 384153

#### CLIENT

Mrs. Louise Letch

23 Salisbury Avenue,  
Colchester CO3 3DW

#### PROJECT

TWO STOREY REAR EXTENSION  
22 NEW ROAD, MISTLEY, CO11 2AG  
BLOCK PLAN - PROPOSED

Scale 1 : 200

Designed GRS

Drawn GRS

Date January 2024

DRG. No. 2156/10