

NOTE: this drawing is to be read in conjunction with the Engineers Structural Calculations

G. R. Sexton C.Eng., MICE

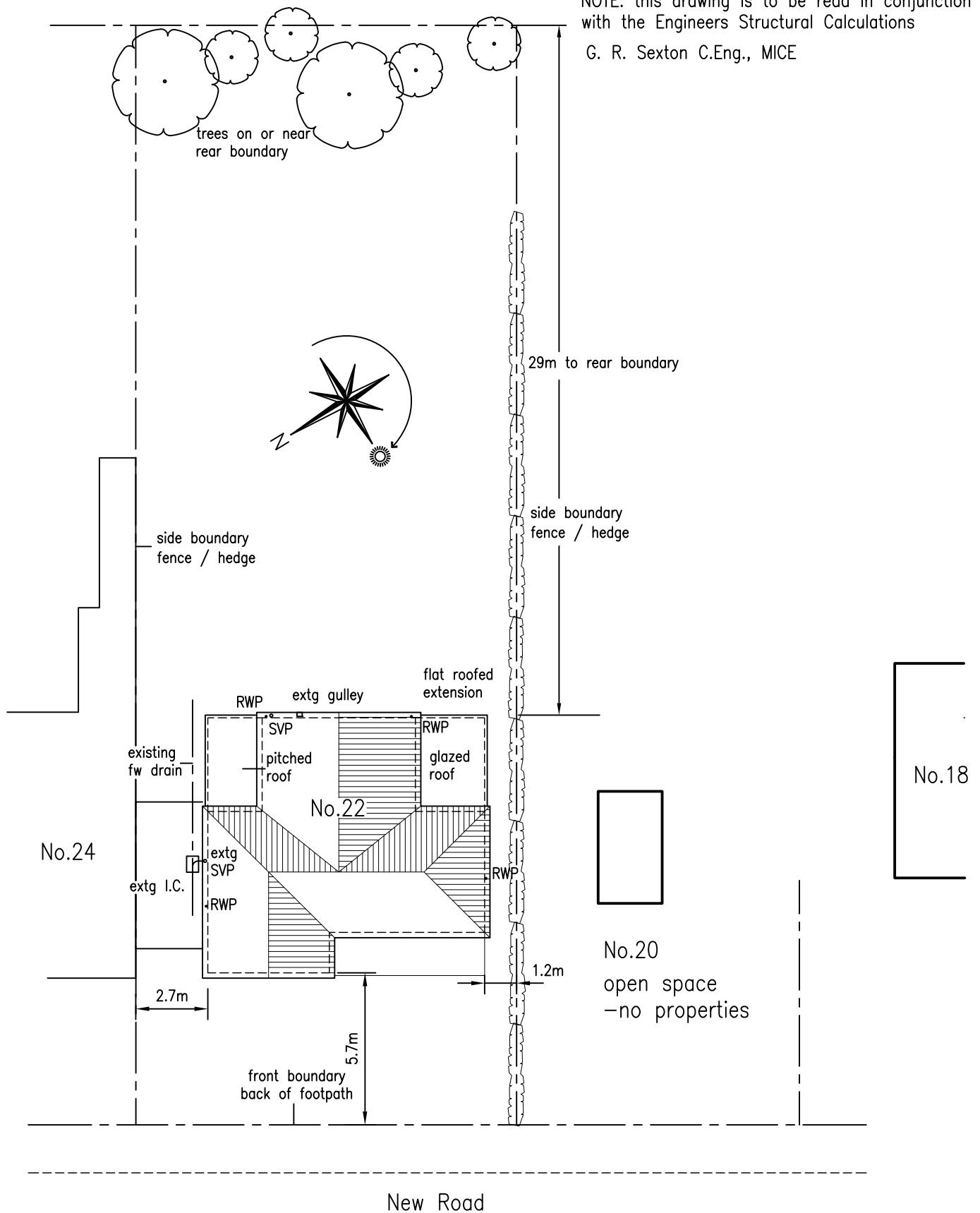

## Block Plan

scale 1 : 200

0 1 2 3 4 5 6 7 8 9 10 11 12 13

### SEXTON DESIGN SERVICES

BUILDING, CIVIL, & STRUCTURAL  
ENGINEERING SERVICES

21A Empress Avenue, West Mersea,  
CO5 8EX, tel & fax 01206 384153

### CLIENT

Mrs. Louise Letch

23 Salisbury Avenue,  
Colchester CO3 3DW

### PROJECT

TWO STOREY REAR EXTENSION

22 NEW ROAD, MISTLEY, CO11 2AG

BLOCK PLAN -EXISTING

Scale 1 : 200

Designed GRS

Drawn GRS

Date January 2024

DRG. No. 2156/12