

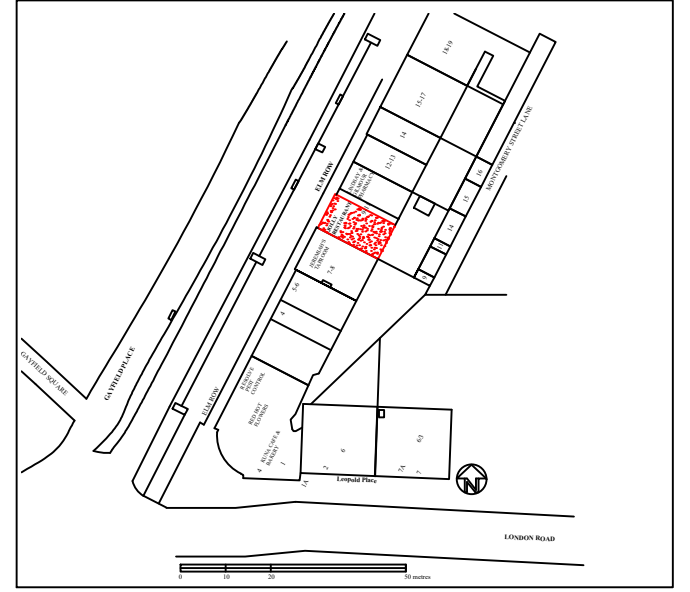

SITE PLAN 1/500.

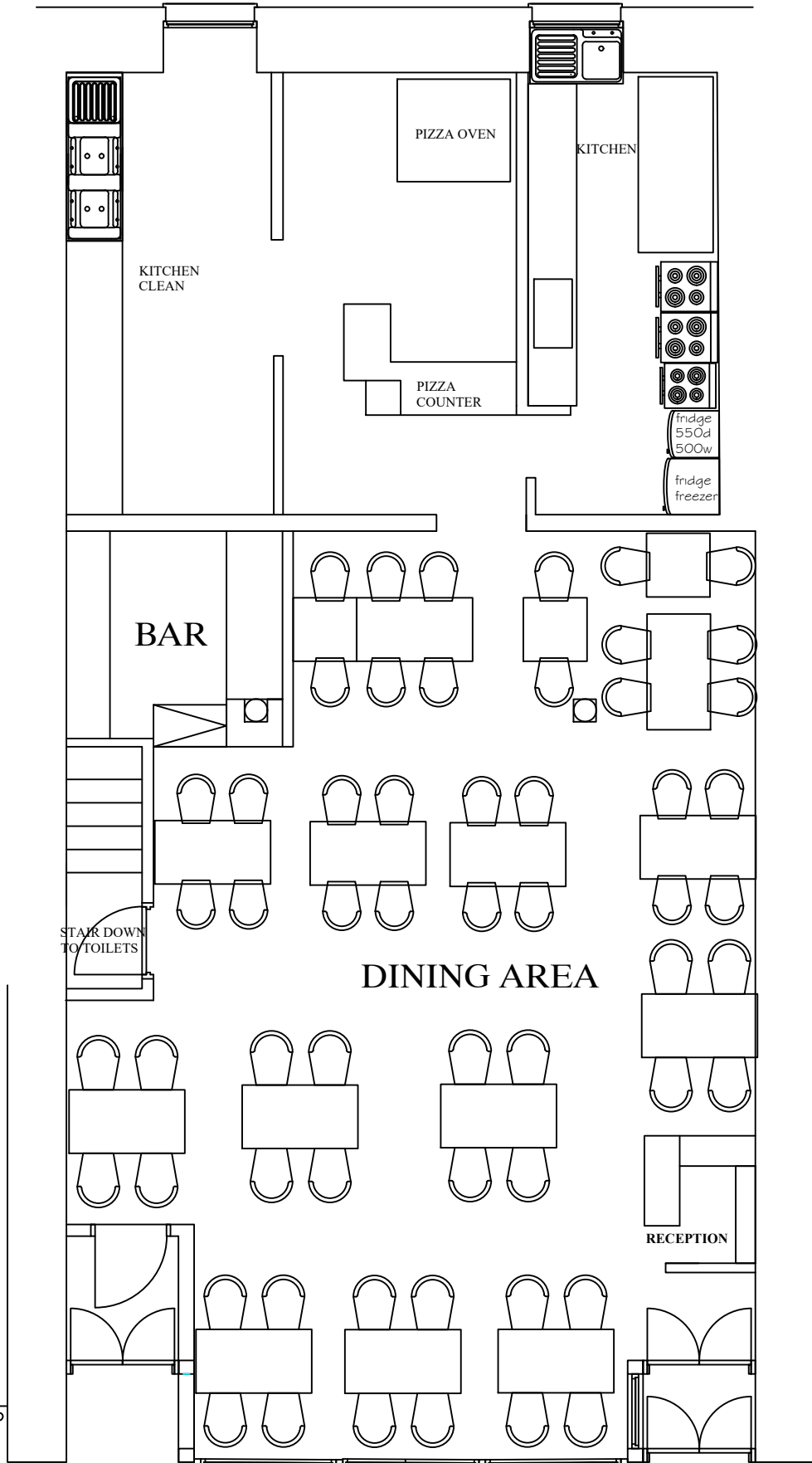

LOCATION PLAN 1/1250



EXISTING GROUND FLOOR PLAN scale 1/50

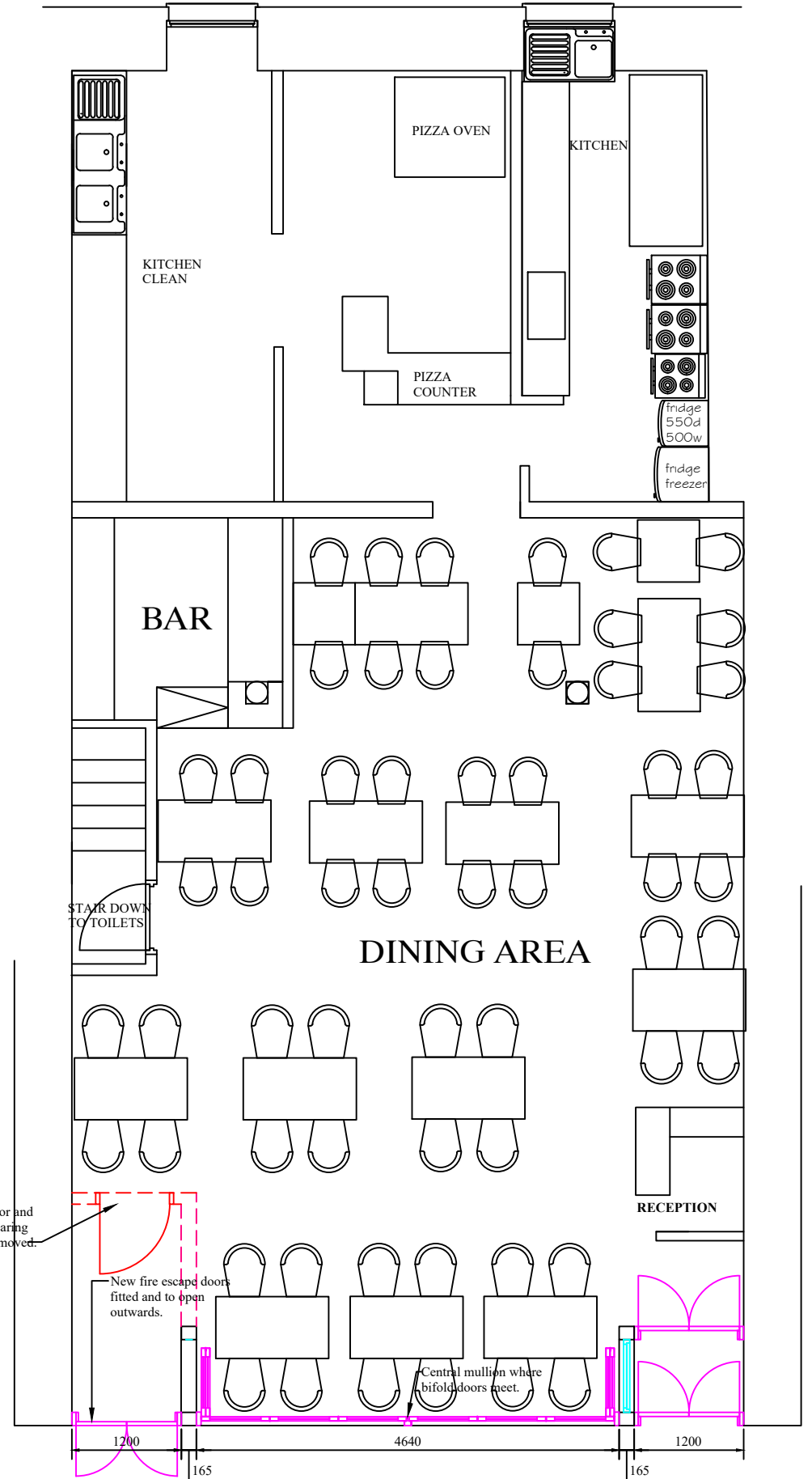

PROPOSED GROUND FLOOR PLAN scale 1/50

SCOPE OF THE PROPOSED WORKS.

- The following is for the proposal to fit hardwood bifold doors to the front elevation of the restaurant and enable the public to gain access to the street precinct.
- The existing windows on the front elevation to be removed to make provision for the bifold doors.
- The bifold doors to incorporate a hardwood window section at high level. 6mm clear toughened glass to be fitted to the window frame.
- Existing door and adjacent non-load bearing walls removed. Make good adjacent wall fabric i.e. plaster walls flush to prepare for painting.

SPECIFICATION:

Bi-folding doors to be manufactured using Maranti timber.
 Glass to be toughened double glazed units 4/12/4 low E, argon glass, this to be toughened with black super spacer.
 Bi-folding doors Ironmongery: Centor B3 bi-folding top rolling system. Pass door ironmongery, Multi point locks(GU rhino), Fab and fix Windsor handles, high security euro cylinders.
 Low disabled access weather bars. Prime painting by ECG.
 Decoration to new works by others.

Drawing Title		
PROPOSED BIFOLD DOORS TO THE JOLLY RESTAURANT		
9 ELM ROW, EDINBURGH EH7 4AA		
Scale	Date	Drawn
	Jan 2024	Robert Graham

