

The Link Outdoor Gym

SE2 9AN

Landscape Proposals
Design & Access Statement
January 2024



Introduction

This document has been produced by Peabody and is intended to communicate the design for provision of outdoor gym to the lawn area in front of the Southmere lake.

The purpose of this project is to relocate the gym equipment outside the Link, with one new piece of gym equipment that serves a range of age ranges. The works are being undertaken as part of Peabody's Landscape and Open Spaces Delivery Capital Investment Programme which ensures the Peabody estates are able to provide safe, attractive and meaningful outdoor active spaces for the residents.

Introduction

1.0

- 1.1
- 1.2
- 1.3

The site

- Site context
- Site overview
- The Site

2.0

- 2.1
- 2.2

Proposal

- Landscape GA
- Materials

3.0

- 3.1
- 3.2

Appendix

- Consultation feedback
- Maintenance Plan

1.0

THE SITE

1.1 Site Context

Southmere Park is located in the London Borough of Bexley and comprises a lake surrounded by various uses including the Bow Arts Centre as well as the boating club. Surrounding the lake there are areas of planting, open grass, trees and hardstanding. The site is north of the Abbey Wood Station which has services operated by Thameslink and Southeastern Rail Lines and Elizabeth Line.

There are lakes in Southmere, Crossway and Birchmere Parks. All three are connected and part of the original drainage scheme and fed by the River Plum, which enters Southmere Lake.

The park is open to the public.





Key

-  Tube & Train station
-  Local parks & open space
-  The site
-  200m (3-minute walk)
-  500m (7-minute walk)
-  Southmere Park

1.2 Site Overview

As part of the Southmere development, Peabody are required to relocate the Links Outdoor Gym. Peabody have explored possible locations close to the existing site and where people can use it whilst enjoying overlooking the lake.

- Key**
-  Peabody Ownership Boundary
 -  Site Area
 -  Original Location of The Link Outdoor Gym, Removed to make space for development

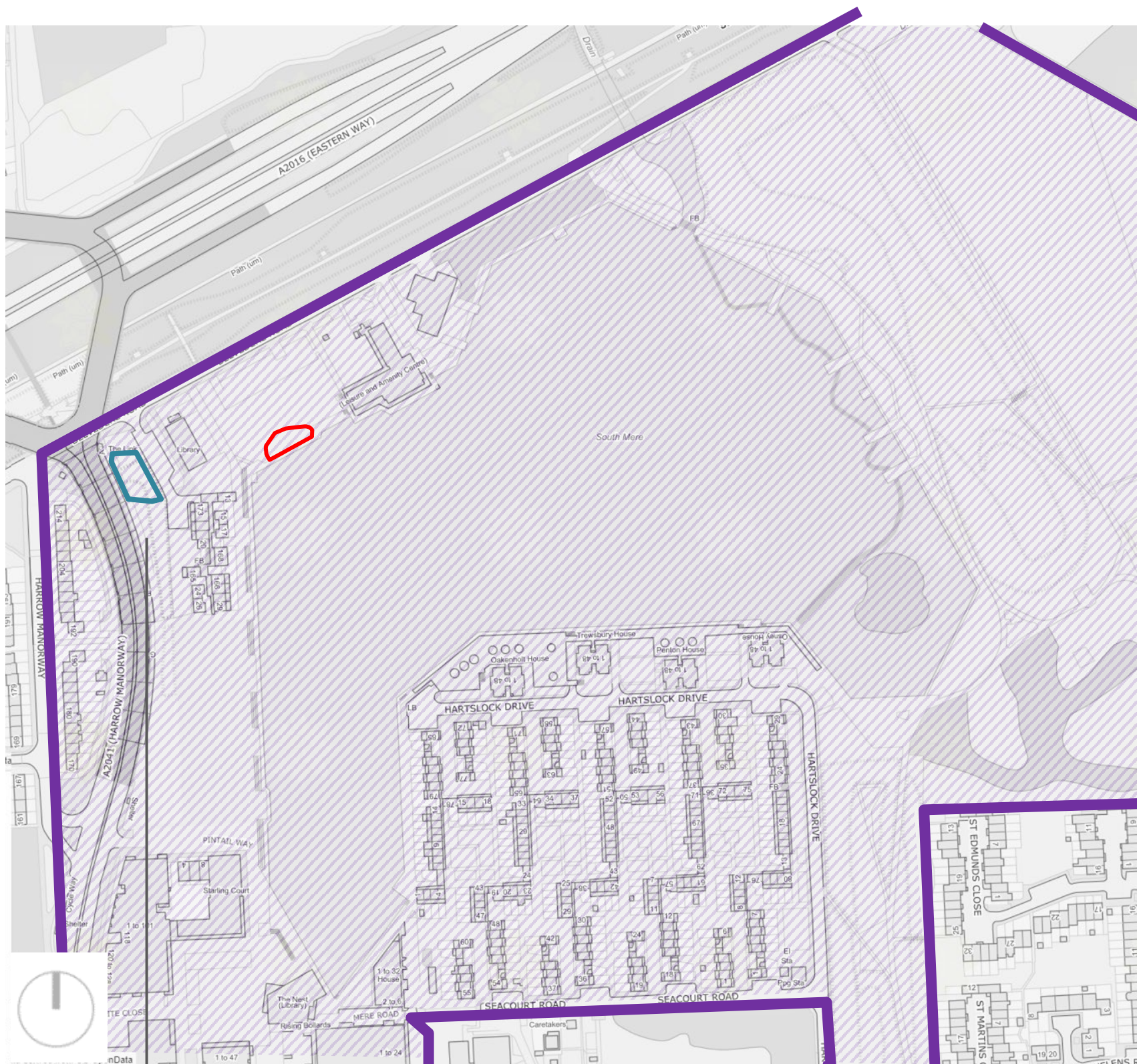

1.3 The Site

The application area is located on a gentle slope covered with lawn, overlooking the Southmere lake, to the west of the Lakeside Event Centre.

Group of trees are located to the north side of the gym area on the top of the slope, outside the application area. Proposed works are not anticipated to impact any trees.

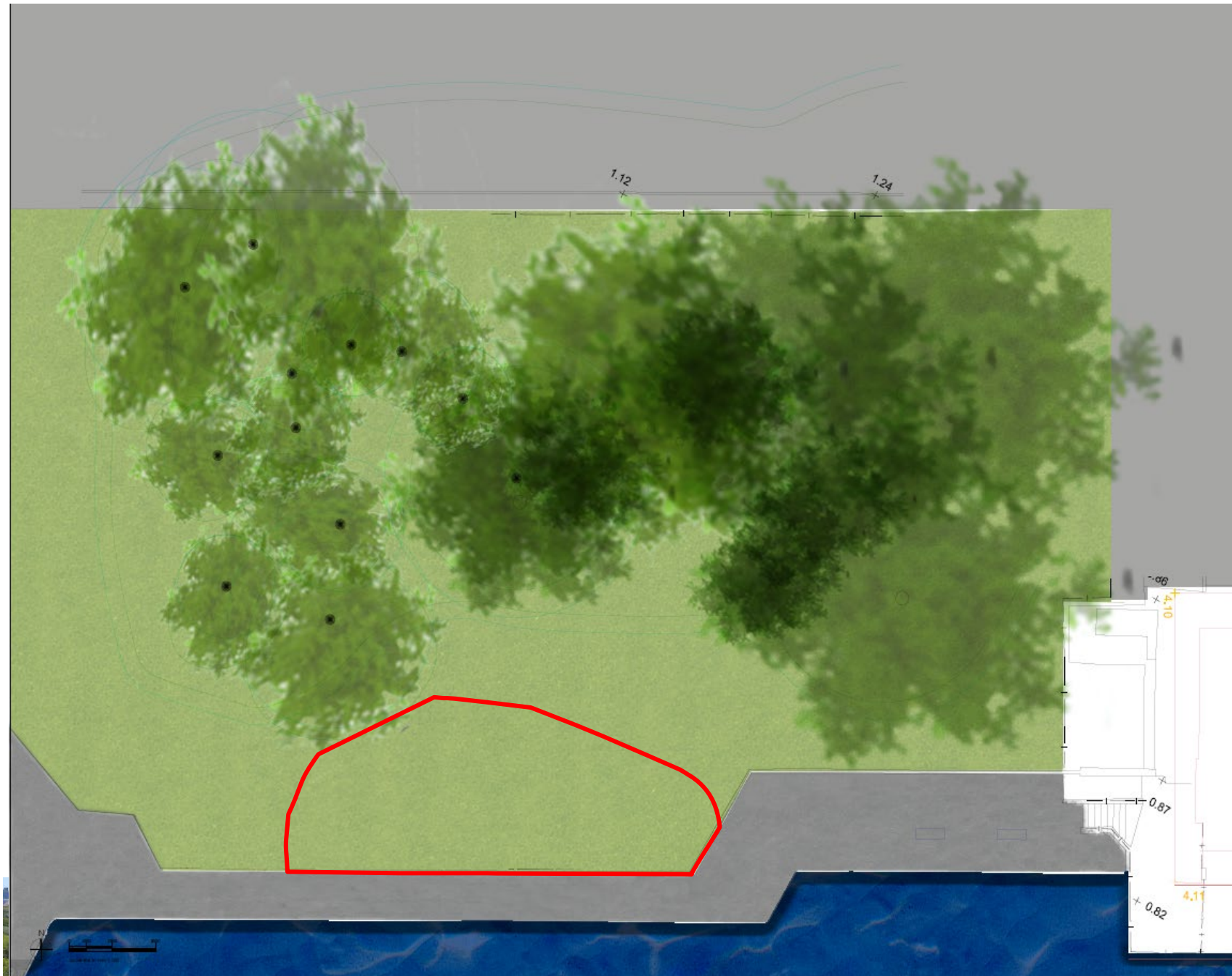

- Key
- Planning Application Area
 - Lawn
 - Paths



2.0

LANDSCAPE DESIGN

2.1 Landscape GA

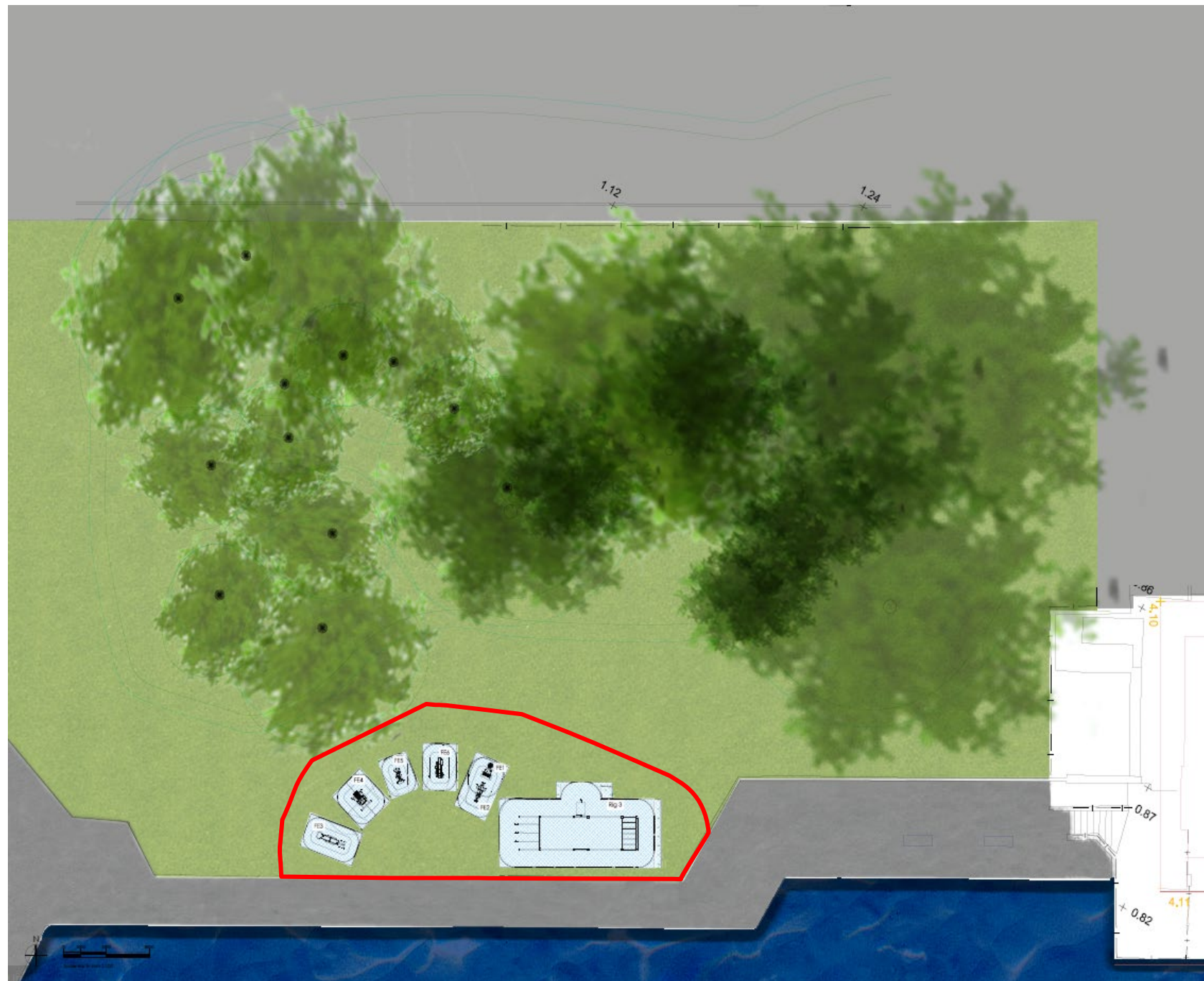

The proposed works are limited to relocating gym equipment, the installation of a new exercise station and providing a safety surface for the gym equipment.

The safety surface is a grass mat product, which will be in green and allow the grass to grow through, reducing the visual impact of the works on the existing slope.

No works are proposed to the existing trees, all works are outside of the root protection area of the trees.

All residents have access to the gym area via an existing pedestrian path.

- Key
- Planning Application Area
 - Lawn
 - Path
 - Trees outside of application area

2.2 Materials

Equipment Previously Placed in the Link Gym



Leg press & Oblique



Bench



Cross trainer



Pull Up/Assisted Pull Up

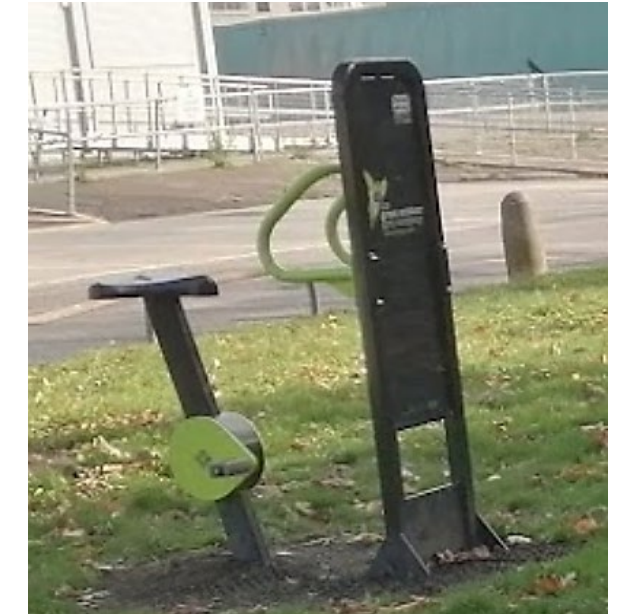

Fitness Bike

Proposed Equipment



Movement Rig

Proposed Surface



Grass Matting

3.0

APPENDIX

3.1 Consultation

THE LINKS OUTDOOR GYM

As part of the Southmere development, Peabody will be moving the Links Outdoor Gym. We are exploring possible locations close to the existing site and where people can use it whilst enjoying overlooking the lake.



Existing equipment to be relocated



Bench
Strength



Pull up/Assisted pull up
Strength



Leg press
Strength



Single oblique
Cardio



Cross trainer
Cardio



Fitness bike
Cardio

Possible new equipment



Kalos Stenthos Champion Rig
Calisthenics



Squat machine
Strength



Dips/Leg Raise
Strength

A drop-in session was organized by our Thamesmead Directorate at the Nest in August 2023. A1 board with images and illustrations were presented.

3.2 .Maintenance Plan

Maintenance Operations

1. The maintenance operations are mainly related to inspection, repairing, refurbishment, replacement due to wear and tear etc.

Demarcation of Maintenance Responsibilities by Key Components	
Component	Responsibility
1. Gym Area	To be kept clean, tidy and free of detritus by Charlton Triangle Homes weekly.
2. Surfacing	
3. Outdoor Gym Equipment and surfacing	All gym equipment to be inspected, maintained & repaired by Peabody in accordance with their Play Inspection & Maintenance Policy.