



DO NOT SCALE FROM DRAWINGS
 All dimensions to be checked on site by Contractor and any discrepancies to be notified to the Architect prior to works being commenced. Use Figured Dimensions ONLY.

COPYRIGHT
 All Rights Reserved. All Documents and Drawings prepared by JSA remain the property of JSA.

Notes:

-  Existing Walls
-  Proposed Walls
-  Proposed Downtakings

Staircase fixing to be strictly in accordance with engineer and stair manufacturer details

Downtake existing staircase and erect new tapered tread staircase. Opening to be amended to suit. 13no risers @ 201.9mm. Standard goings @ 230mm. Max rise - 42°

Existing staircase opening to be reduced in size with infill structure to engineer's design and specification

Existing bedroom wall to be downtaken and new partitions erected to form shower room, bedroom and store

Existing bedroom door to be relocated back to line through with existing wall

New shower room to be connected back to existing external SWP

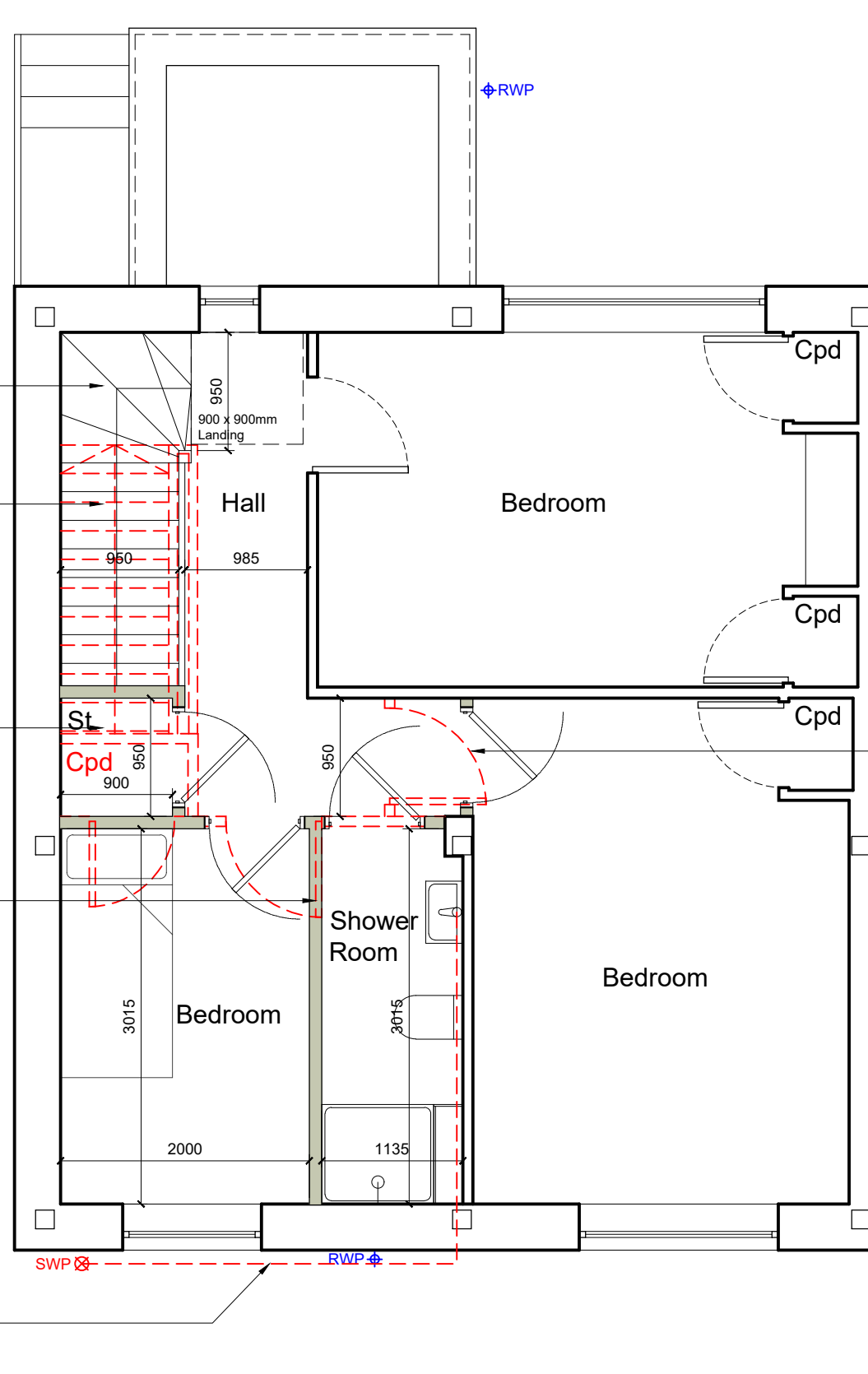

Rev Date	Description	Iss
----------	-------------	-----

Proposed First Floor Plan

e. info@jsarch.co.uk
 t. 07342 305560

JSA

FRONT PORCH & INTERNAL ALTERATIONS

Building Warrant

Mr & Mrs McGurk
 8 Windhill Road, Glasgow

Scale: As noted @ A3

L(20)006

FIRST FLOOR PLAN AS PROPOSED
 1:50

