

BASE

Offices:
SHREWSBURY, CONWY, CHESTER

Tel: **01743 236 400** | Tel: **01244 569 008**

Email: **HELLO@BASEARCHITECTURE.CO.UK**

Web: **BASEARCHITECTURE.CO.UK**

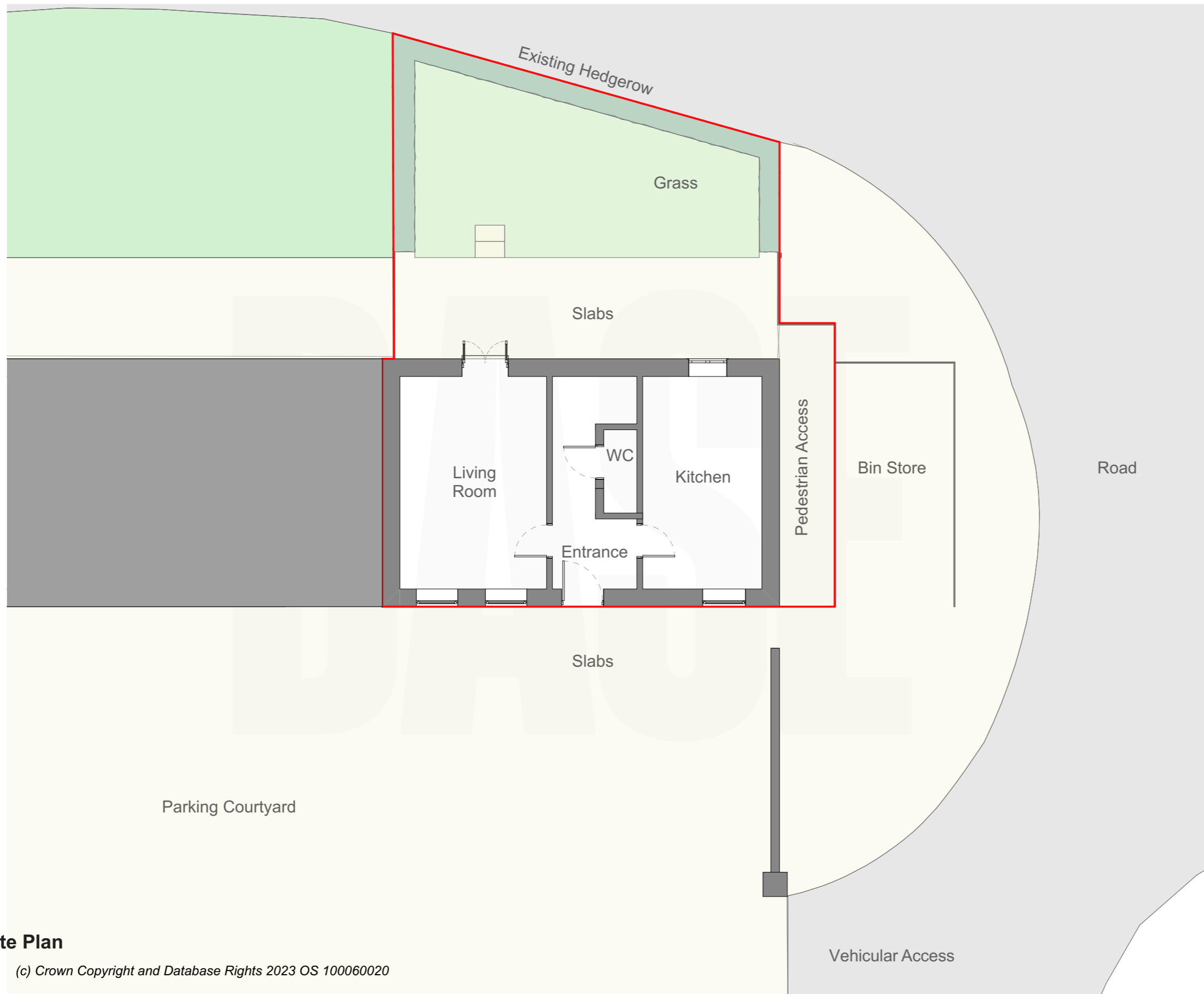

Existing Site Plan

1:100

(c) Crown Copyright and Database Rights 2023 OS 100060020

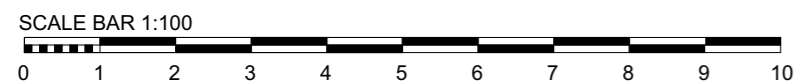

Rev.	Revision Description.
By.	
Chk.	

Scale.	Drawn by.
1:100 @ A3	DG

Date.	Chk.
30.01.24	JH

Project Title
3 Clock House Stables

Client
Irene Steele

Drawing Title
Existing Site Plan

Project No.	Drawing No.	Rev.
BA4266	PL-002	

This drawing is the property of base Architecture & Design Ltd. It shall not be copied or scanned, in part or whole, without prior consent of base Architecture and Design. Do not scale this drawing.

