

FIRST FLOOR

GROUND FLOOR

PROPOSED SITE PLAN

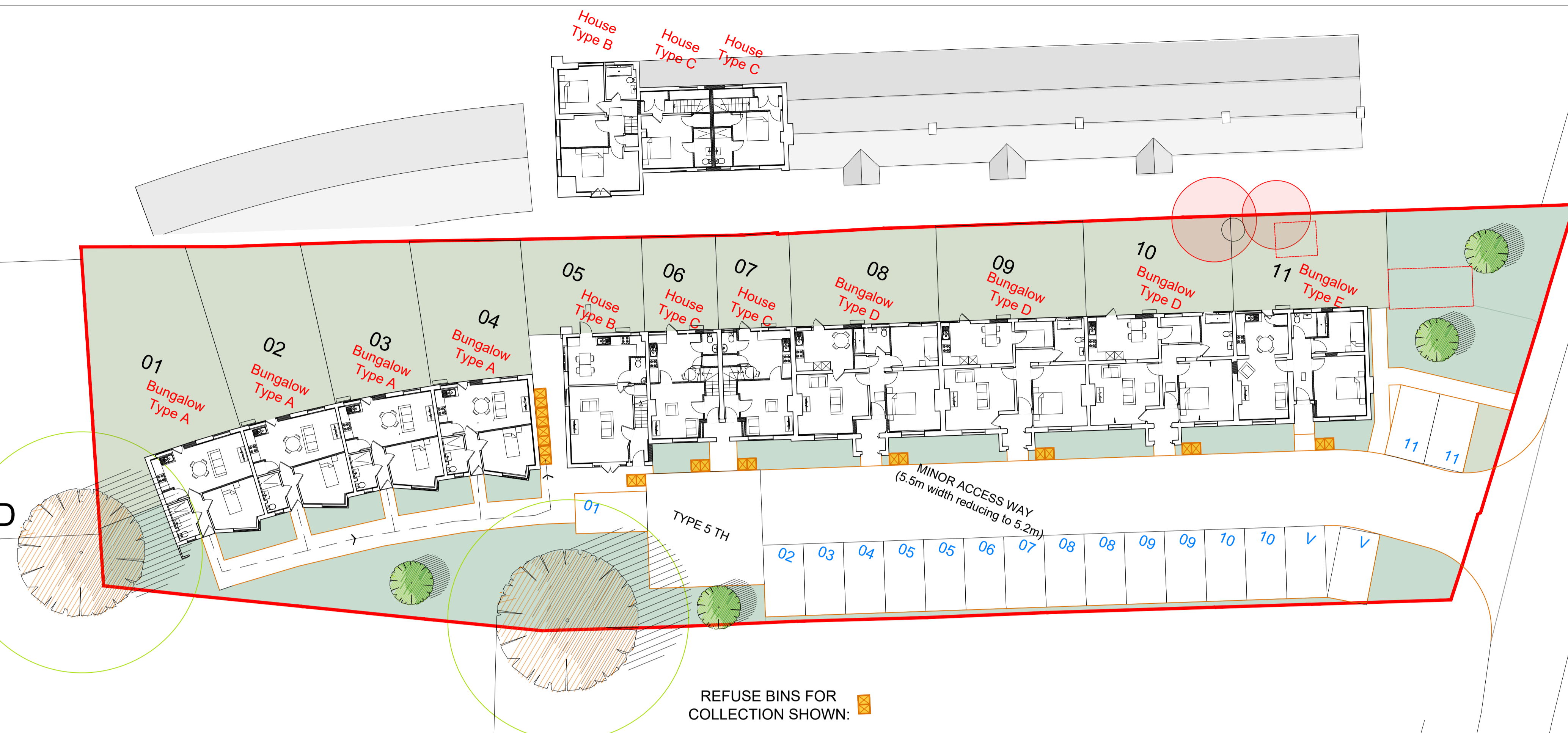

FIRST FLOOR

GROUND FLOOR

EXISTING SITE PLAN

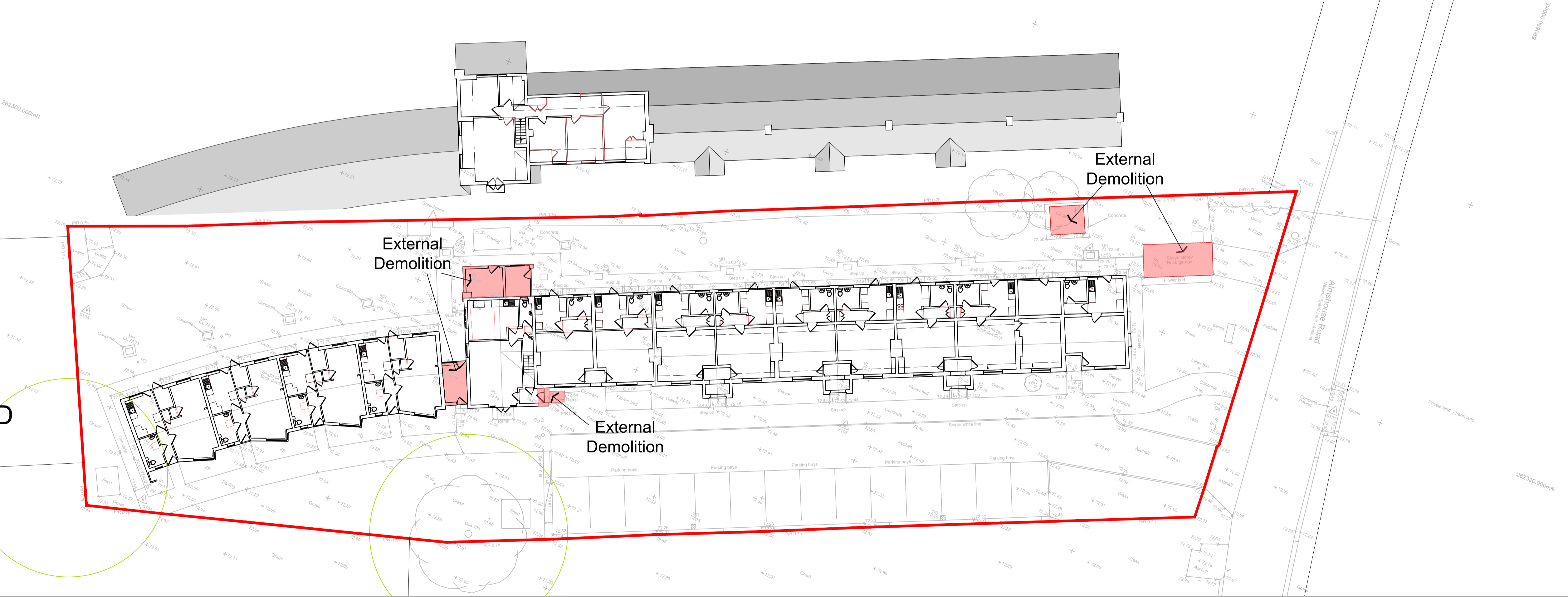

This drawing is produced as a document for use in this project only and may not be used for any other purpose. The license is granted only to the specific recipients of the drawing directly from Chaplin Farrant Ltd. Chaplin Farrant Ltd accepts no liability for the use of this drawing other than the purpose for which it was intended in connection with this project as recorded on the title block and 'File Status Code' and 'Revision'. If also issued in digital format, the data within this file may not be used for any purpose other than the information present on the paper copy of the document.

Chaplin Farrant Copyright © 2024. This drawing may not be reproduced in any form without Chaplin Farrant's prior written agreement.

SCALE 1: 200 @A1

NORTH

NOTES
This drawing contains the following:

Soft Landscaping (Indicative only - see Specialist Design)

- Existing trees to remain (approx rpx indicated)
- Approx location of new trees or shrub trees (local species)
- Trees to be removed
- Communal Open Space
- Private Garden

Schedule

Reference	Type	Slopes	Background	GIA (m²)	GLA (m²)	Parking Spaces	Number	Total GIA (m²)
A	Bungalow	1	1/1	422	39	2	1	156.8
B	House	2	3/5	998	92	7	2	92.7
C	House	2	1/2	599	57	9	2	115.8
D	Bungalow	1	2/3	731	67	9	3	203.7
E	Bungalow	1	2/3	664	61	7	1	61.7
TOTAL								11 630.7

REVISION LOG

REV.	DATE	DESCRIPTION
P1	04/04/23	First issue
P2	11/05/23	Updated following site visit
P3	13/12/23	Minor amendments to schedule & annotation text
P4	17/01/24	Parking & turning head amended, existing site plan added
P5	29/01/24	First floor plans added to both existing and proposed plans, garage indicated retained to match D&A statement

DRAWING USE

PLANNING

CLIENT
HAVEBURY

PROJECT
JAMES STIFF COTTAGES

ADDRESS
ALMSHOUSE RD ROUGHAM IP30 9JL

STATUS

S4-FOR STAGE APPROVAL

DRAWING TITLE
SITE PLAN

DRAWING NO.
012

CREATED BY
WS

CHECKED BY
MN

APPROVED BY
MN

CF JOB NO.

6166

SIZE
A1

REVISION
P5

51 Yarmouth Road,
Norwich,
NR7 0ET
01603 70000
office@chaplinfarrant.com

Also at:
Cambridge and Winchester
www.chaplinfarrant.com

