

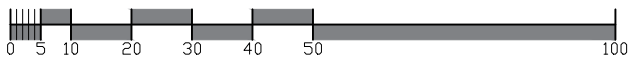

(c) Crown Copyright and Database Rights 2023 OS 100060020

| REV | DATE | DESCRIPTION | INITIAL | CHECKED |
|-----------------|------|-------------|---------|---------|
| PLANNING | | | | |

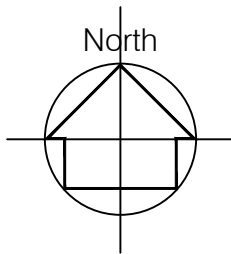

© This drawing is copyright.
It is sent to you in confidence and must not be reproduced or disclosed to third parties without our prior permission.

Do not scale from this drawing, other than for Local Authority Planning purposes.

This drawing is to be read in conjunction with all relevant consultants, specialist manufacturers drawings and specifications.

Any discrepancies in dimensions or details on or between these drawings should be drawn to our attention.

All dimensions are in millimetres unless noted otherwise.



harding rose architects

| | | | |
|---------|-------------------------|-------------|----------|
| CLIENT | MR J KEBE | | |
| PROJECT | 5 Llanvair Drive, Ascot | | |
| TITLE | Location Plan | | |
| SCALE | 1:1250@A4 | DATE | 02.02.24 |
| DRAWN | AC | PROJECT NO. | 23.1108 |
| | | | L.201 |