

Produced on 07 November 2023 From the Ordnance Survey National Geographic Database and incorporating surveyed revision available at this date.  
 This map shows the area bounded by 253814 672374,253956 672374,253956 672516,253814 672516,253814 672374  
 Crown copyright and database rights 2023 OS 100054125. Supplied by copie ltd trading as UKPlanningMaps.com a licensed Ordnance Survey partner OS 100054125.  
 Data licence expires 07 November 2024. Unique plan reference: v2e/1022856/1379328

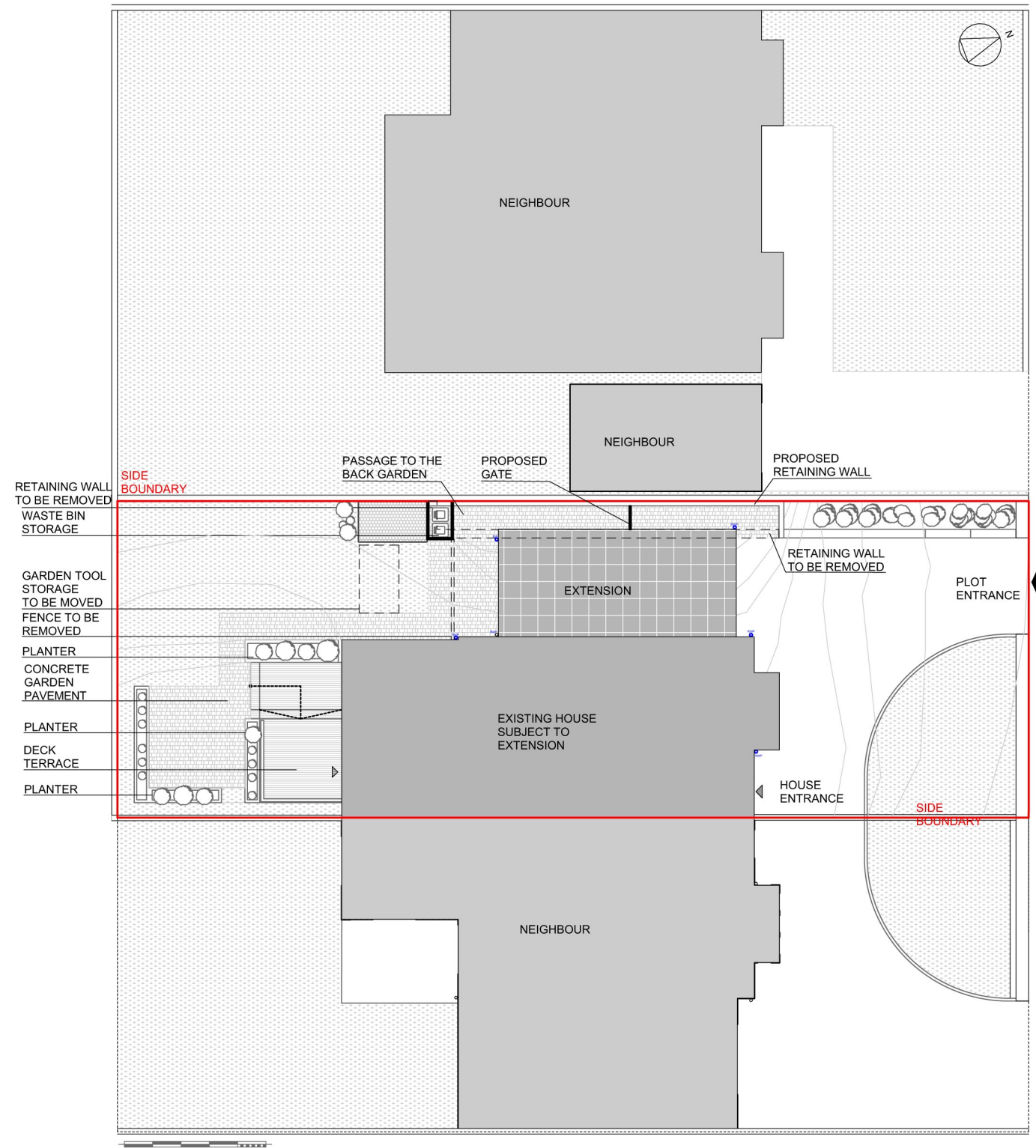

Location Plan As Proposed  
 1:2000



Site Plan As Proposed  
 1:200

- note
- do not scale
- check all dimensions on site prior to erection or fabrication and report any discrepancies to the architect immediately

| rev | date | by | description |
|-----|------|----|-------------|
|     |      |    |             |

client  
**Shiona McCallum & Michael Borthwick**

---

project  
**19 North Erskine Park, G61 4LZ, Bearsden, Glasgow;  
 Alteration and Extension  
 to Semi-detached Residential Dwelling**

---

drawing  
**Site Plan As Proposed, Location Plan As Proposed**

project no. **2304**

---

drawing no. **100** revision

---

scale **1:200, 1:2000**

---

status **Planning Application**

---

drawn **JR**

---

date **01.02.2024**

**DAS DESIGN**  
 architects

13 Barrmill Road  
 Burnhouse KA15 1LG  
 t: 07950400213  
 t: 01560 484 236  
 e: info@dasdesign.co.uk  
 www.dasdesign.co.uk