

**CDM 2015 RESIDUAL RISKS**

- It is assumed that a competent Principal Contractor with the relevant skills, knowledge and experience of construction of this type of work and location will be appointed, and will be aware of the typical hazards. Refer to broader non-typical risks on Considine Construction Notes, Drawing No. 5273-CON-00-XX-DR-C-1400.
- Asbestos present in existing pipework.

The above residual risks are for non-standard hazards. It is assumed that a competent contractor familiar with the construction of this type of work will be appointed who will be aware of the standard hazards.

**KEY**

- +LEVEL Proposed Level
- + [LEVEL] Existing Level Interpolated
- 1/123 Proposed Gradient
- Proposed Quadrant Kerb
- Proposed Transition Kerb
- Proposed HB2 Kerb with 125mm Upstand
- Proposed Bull Nosed Kerb with 0-6mm Upstand
- Proposed Edging
- (GB) Proposed Gravel Board Retaining Wall Refer to Typical Construction Details
- (RW) Proposed Retaining Structure. By others.
- (TNK) Proposed Tanking, by Others.
- Further Significant Information Required

DO NOT SCALE THIS DRAWING. ALL SETTING OUT TO ARCHITECT'S DETAILS AND DRAWINGS

THIS DRAWING IS TO BE READ IN CONJUNCTION WITH ALL OTHER RELEVANT DRAWING ISSUES AND THE SPECIFICATION.

**Notes:**

- All building materials, components and workmanship to comply with the appropriate public health acts, building regulations, british standards and codes of practice and the appropriate manufacturer's recommendations.
- For all specialist work see relevant drawings.
- Any discrepancies, errors or omissions to be reported to the project co-ordinator for further instructions before commencement of works.
- The Engineer is not responsible for dimensions, except where shown on his drawings. All setting out information, dimensions, etc, shall be calculated from the Architect's drawings.

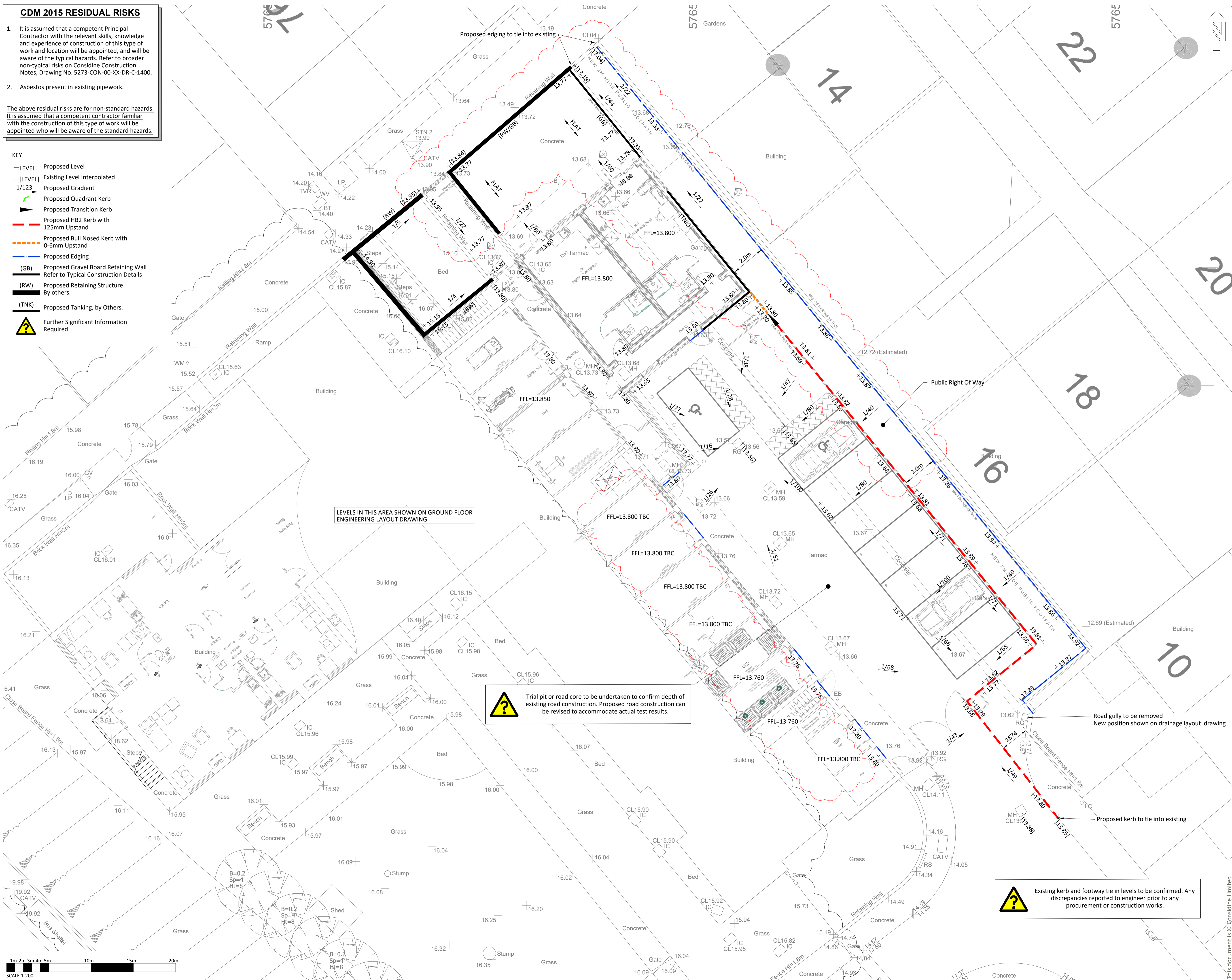

LEVELS IN THIS AREA SHOWN ON GROUND FLOOR ENGINEERING LAYOUT DRAWING.

**?** Trial pit or road core to be undertaken to confirm depth of existing road construction. Proposed road construction can be revised to accommodate actual test results.

**?** Existing kerb and footway tie in levels to be confirmed. Any discrepancies reported to engineer prior to any procurement or construction works.

P03	Archplan updated. FFL's to bin stores and levels to PROW updated.	SJ	IMF	18.05.23
P02	Archplan updated Parking area layout change and retaining wall layout revised.	SJ	IMF	14.03.23
P01	Preliminary Issue	SJ	IMF	08.02.23
Rev	Amendment	Drn	Chk	Date

**considine**  
civil + structural engineers  
25 Hollingworth Court, Turkey Mill  
Ashford Road, Maidstone, Kent ME14 5PP  
t: 01622 919918 e: info@considine.co.uk  
www.considine.co.uk



Project:  
**RUSSELL HOUSE  
RUSSELL COURT, CHATHAM  
ME4 5LE**

Drawing Title:  
**ENGINEERING LAYOUT  
LOWER GROUND FLOOR**

considine ref	drawn by	date	drawing scales	original paper size
5273	SJ	JAN 23	1:100@A1, 1:200@A3	A1

drawing reference	originator	volume	level	type	role	number
5273-CON-00-XX-DR-C-1500						

status:	SUITABLE FOR INFORMATION
revision:	PRELIMINARY
P03	

