

SCALE BAR 1:50

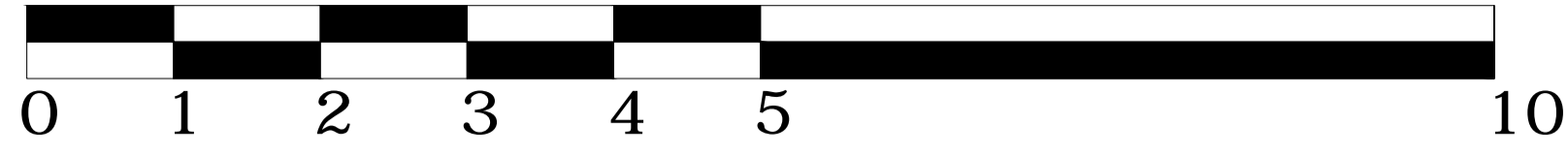

- Wall Construction**
 100mm dense concrete block with 2 coat waterproof roughcast 15mm thick & 100mm thick Hopeman Sandstone
 50mm thick cavity with stainless steel ties & nails breather membrane 9mm OSB boarding 145x45mm C16 studs @ 600mm
 50mm Kingspan 80mm frametherm reflectatherm VC joints taped services void using 25mm vertical battens @ 600mm crs 12.7mm plain ptd joints taped & filled
- Structural Legend**
B1 = 203x133x25Kg U.B
C1 = 100x100 rhs
L1 = 3x 45x225 C16 timber lintils
L2 = 2x 45x2175 C24 timber beams
 cripple studs
 panel height studs
 Above window studs
 Below window studs
P4 = 4No 45x145mm C16 Panel height studs
P2 = 2No 45x145mm C16 Panel height studs
S1 = 1No 45x145mm C16 cripple studs
S2 = 2No 45x145mm C16 cripple studs
S3 = 3No 45x145mm C16 cripple studs
S4 = 4No 45x145mm C16 cripple studs
 Make allowance for a percentage of internal partitions to have OSB racking below plasterboard finish

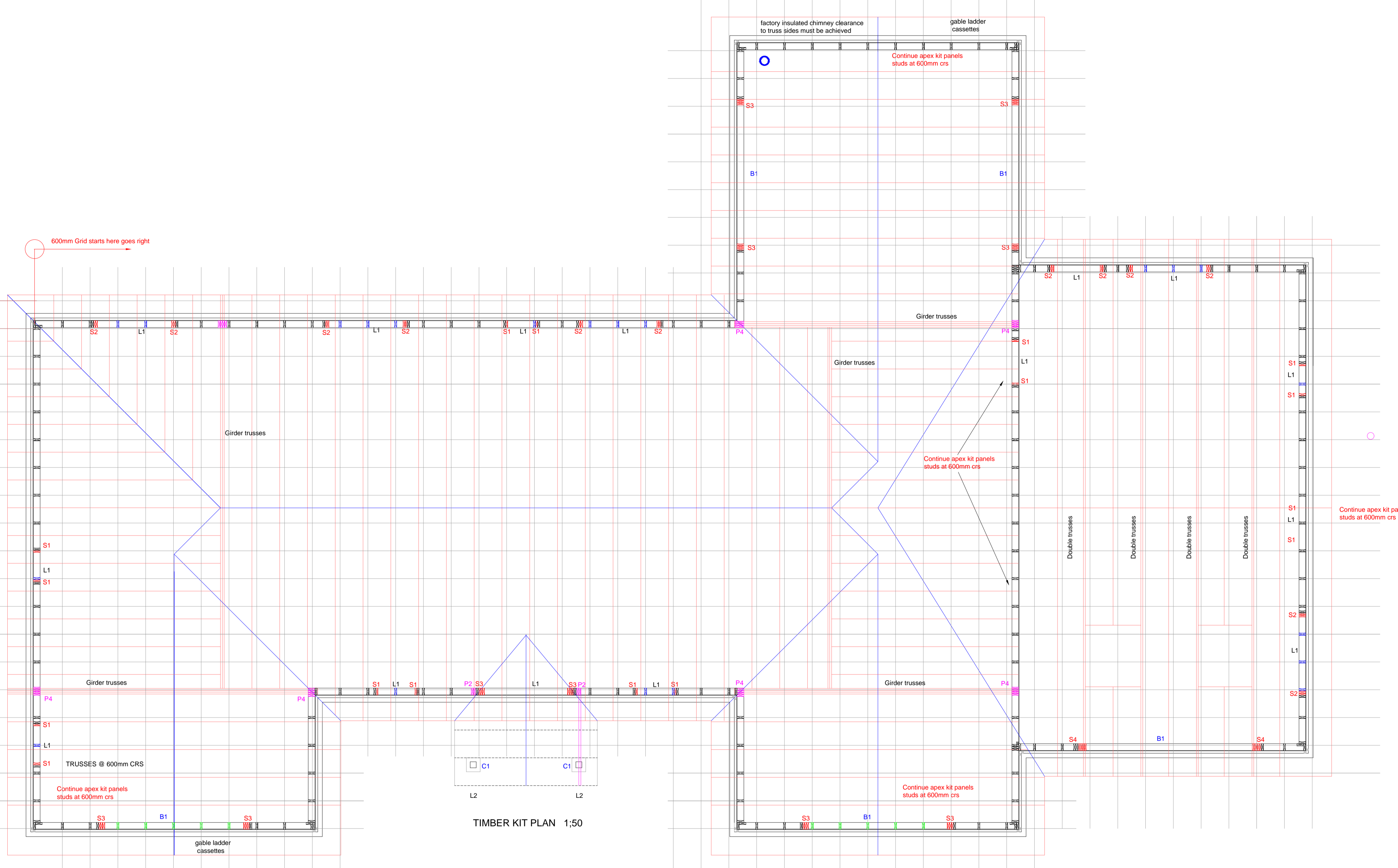

TIMBER KIT PLAN 1:50



D K MELDRUM LTD
 ARCHITECTURAL SERVICES
 BUILDING CONSULTANCY

Mob: 07800841674
 E-Mail: Dmeldrum1957@aol.com
 Office: THE DRUM
 10 Cheynes Lane
 Turriff
 AB53 4FQ

DRAWING DETAILS

Proposals: Dwelling
 Scale as detailed
 Date 31;01;2024
 Drawn DKM
 REF No 4BW

PROJECT DETAILS

Erection of dwelling & garage @
 Site 3
 Millmoos Nurseries
 Turriff for Mr R Duncan