

0 0.5 1.0 1.5 2.0 3.0 4.0 5.0 6.0  
scale bar: 1:100.

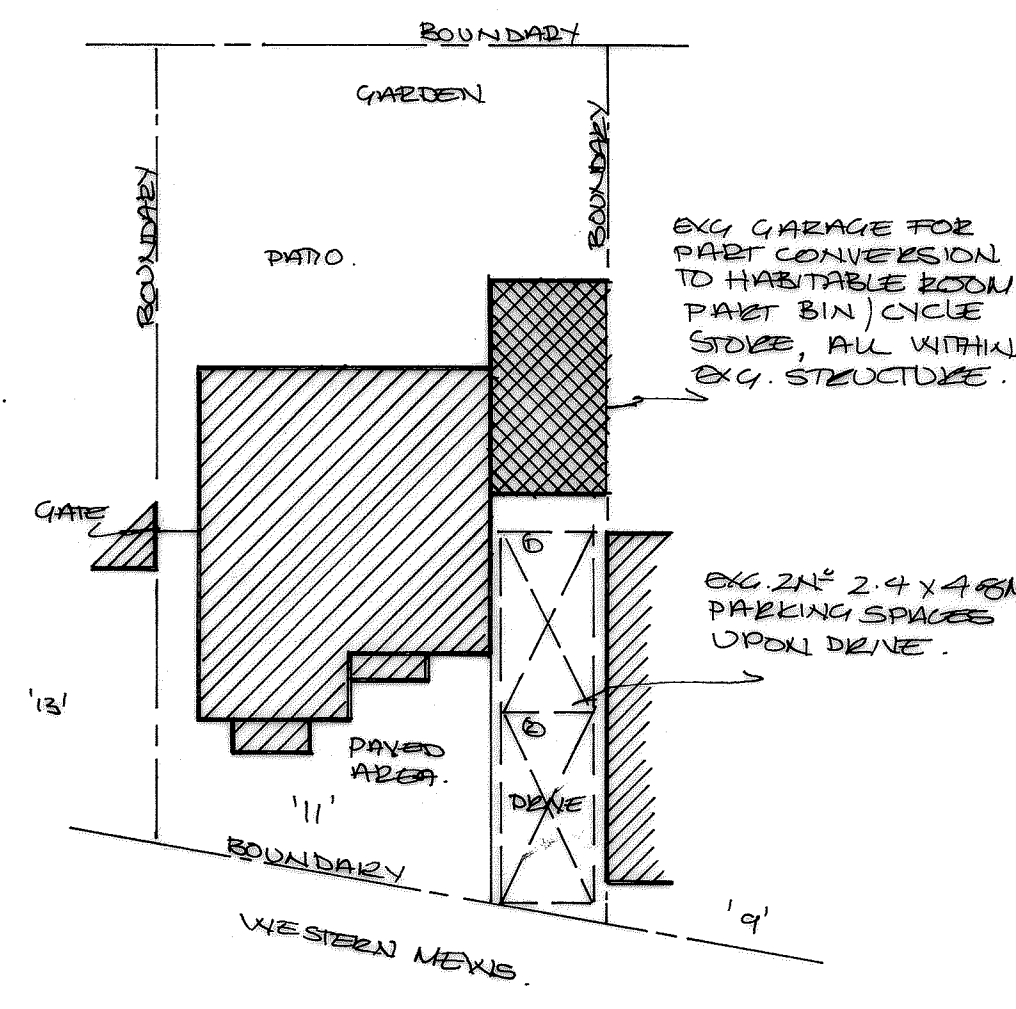
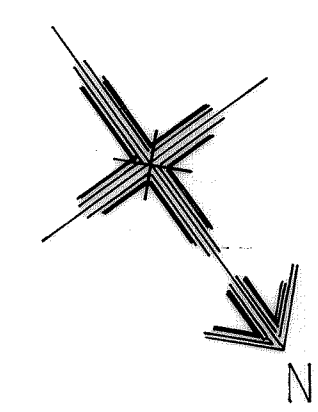
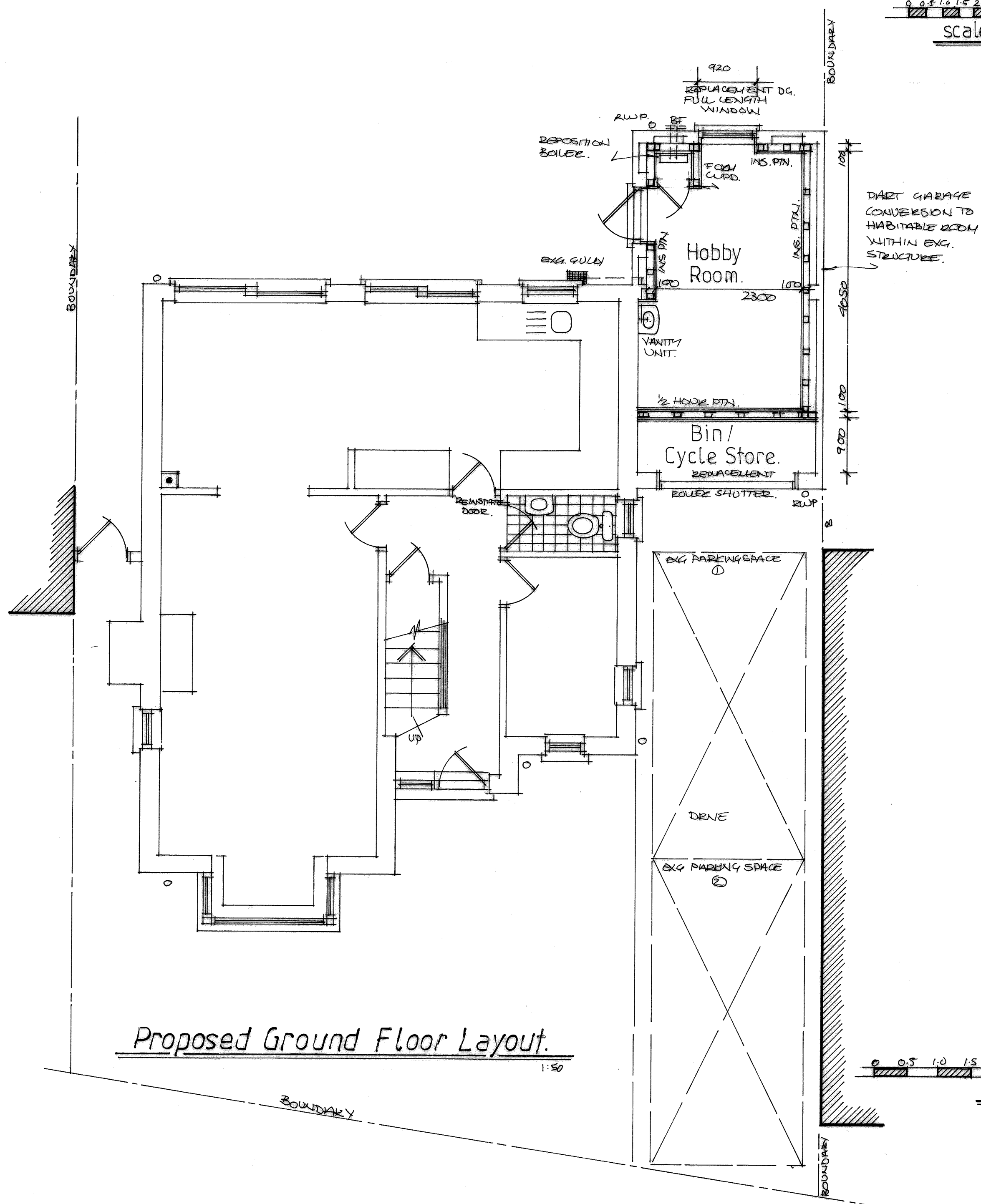

0 1 2 3 4 5 10  
scale bar: 1:200.

0 0.5 1.0 1.5 2.0 3.0 4.0 5.0 6.0  
scale bar: 1:50.

**Russell A Broad & Associates.**  
\*Architecture\*Surveying\*Supervision\*  
approved designs since 1986.  
  
The Architectural Design Studio.  
The Old Cycle Shop, 200 High Street,  
Wickham Market, Suffolk IP13 0RF.  
Mobile:- 07931 150805.  
Email:- RussellBroad1986@gmail.com

Project:-  
Proposed Part Conversion  
of Existing Garage to  
Habitable Room, Part  
Bin/Cycle Store within  
Existing Structure.

Project Address:-  
11, Western Mews,  
Billericay,  
Essex. CM12 9EA.  
For:-  
Mr. Sutherland & Miss Thomas.

Drawn: <i>[Signature]</i>	Submitted:-	Approved:-
------------------------------	-------------	------------

Date:- Feb. 2024. Scale:- 1:50, 1:100, 1:200.

Please Scale For Planning Purposes Only.  
All Dimensions are to be Checked on Site.  
All Works to Relevant Codes of Practice & B.S.'s.  
Client and Contractor to ensure compliance with  
C.D.M., Health & Safety Regulations & Party Wall  
Agreement Act where applicable.

Project Ref:- 81173.	Drawing Number:- 02.	Rev
-------------------------	-------------------------	-----