

**1** Existing Site Plan.  
1 : 200

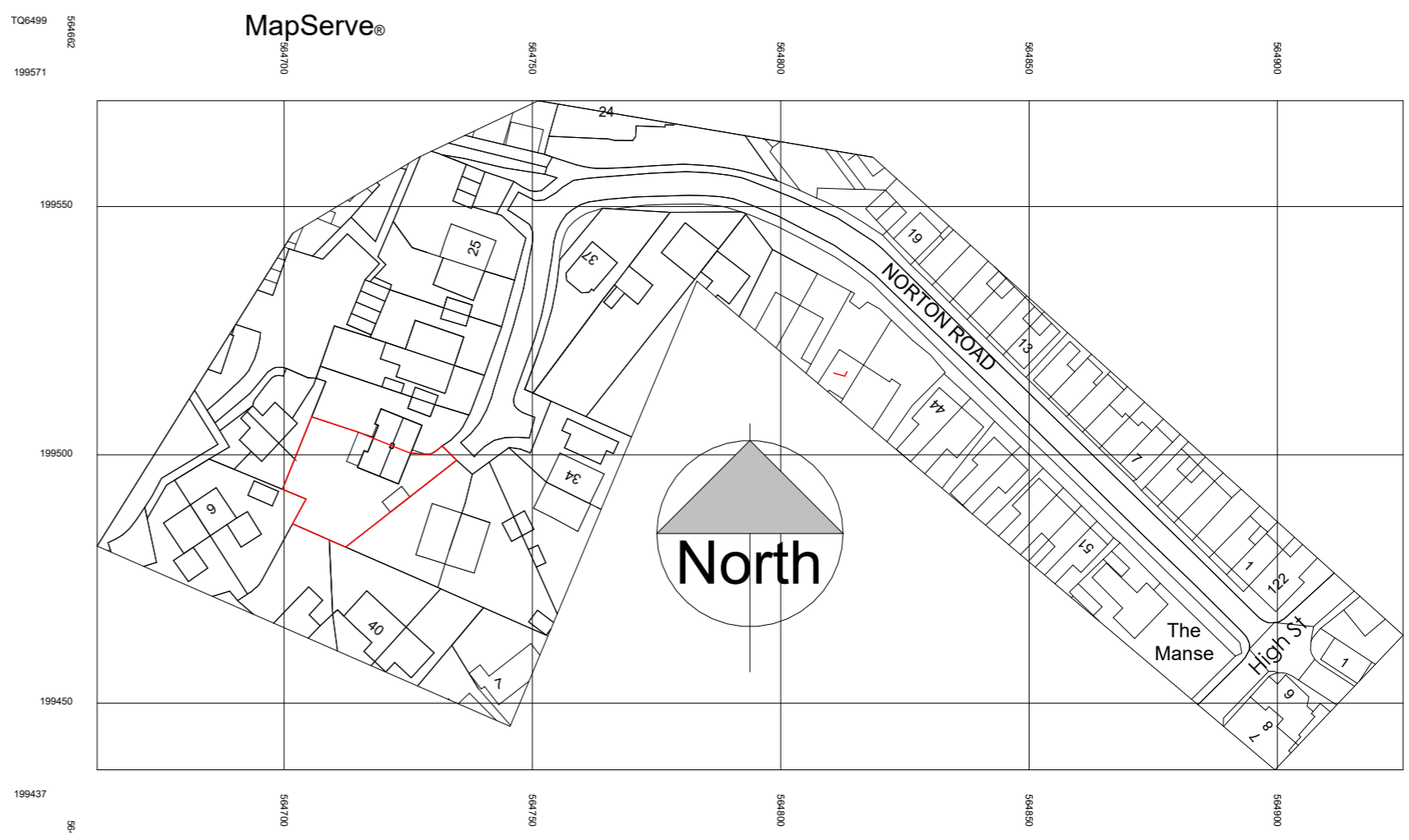

**2** Site Location Plan  
1 : 1250

REV	DATE	REV	DRAWN	CHECKED
<b>RD Consulting</b> sustainable technical solutions 8 Ruffles Close, Rayleigh, Essex, SS8 8EW T: 01288 741388 F: 01288 741388 E: info@rdconsult.co.uk W: www.rdconsult.co.uk				
Mr & Mrs Croker				
30 Norton Road, Ingatestone				
Site and Location Plan (As Original)				
DATE	02/01/24	DRAWN	TE	PROJ No.
				23517
SCALE	As indicated	CHKD	RD	DWG. No.
				006
THIS DRAWING IS COPYRIGHT OF RD CONSULTING AND MAY NOT BE REPRODUCED WITHOUT PERMISSION				STAGE <b>PLANNING</b>