

**IMPORTANT**

- Do not scale from this drawing, except for planning purposes, use figured dimensions only. If in doubt ask Douglas Briggs Partnership [01243 574511 or architecture@douglasbriggspartnership.co.uk]
- All dimensions must be checked on site prior to commencement of work and fabrication.
- This drawing/document is to be read in conjunction with other consultants/suppliers information and the Architects contract drawings and specifications etc.
- Any discrepancies between different pieces of information that have been supplied shall be notified immediately to Douglas Briggs Partnership.
- Any departure from dimensions provided by DSP and the locations, positions or dimensions given in Planning and Building Control approvals shall be notified to Douglas Briggs Partnership prior to departure.
- This design and copyright remains the property of Douglas Briggs Partnership LLP unless expressly released in writing by Douglas Briggs Partnership LLP.

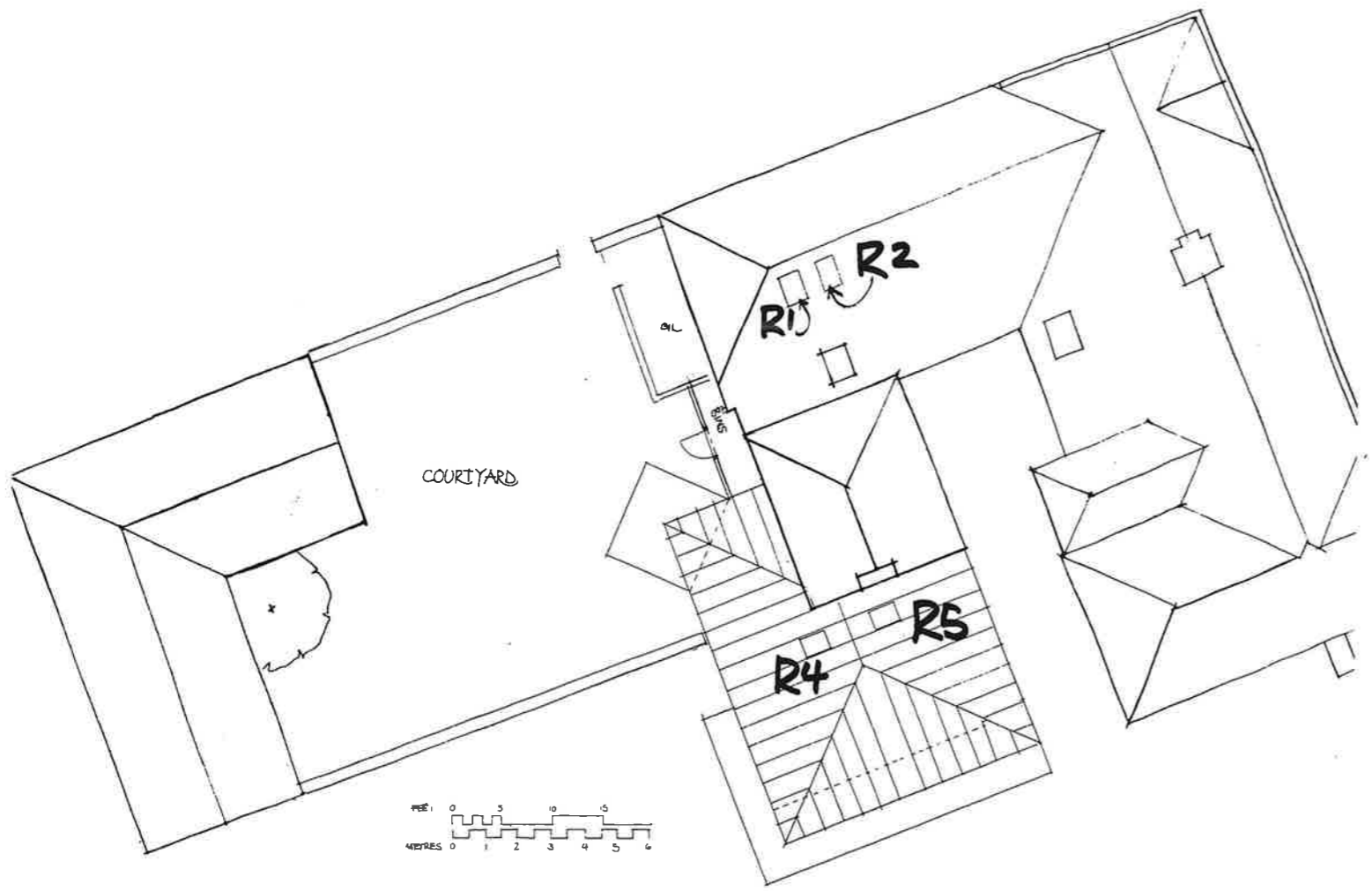

**Description:** Velux Conservation style roof windows with grey centre glazing bar.  
 Recessed flashings for plain tiled roofs, zinc flashings for zinc roofs

**Method of opening:** Centre pivot, Velux Integra electric operation

**Colour and finish:** RAL 7043  
 Grey External frame and centre glazing bar  
 White polyurethane internal finish

**BLINDS :** TIMER CONTROLLED ELECTRICALLY OPERATED BLACKOUT BLINDS.

KEY PLAN 1:200

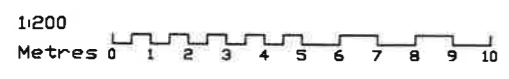

A3 SHEET SIZE

ROOF WINDOW DETAILS.

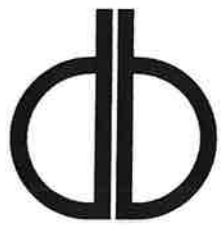

0318-34<sup>A</sup>  
 1:200

ALTERATIONS & EXTENSIONS  
 AT  
**SOUTH MUNDTAM HOUSE**  
 SOUTH MUNDTAM, WEST SUSSEX

**DOUGLAS BRIGGS PARTNERSHIP**

INTEGRATED ARCHITECTURE AND TOWN PLANNING

Douglas Briggs Partnership  
 Flint Barns  
 Ham Farm  
 Bosham  
 West Sussex PO18 8EH  
 T 01243 576611 F 01243 574816  
 Email ideas@douglasbriggspartnership.co.uk  
 Web www.douglasbriggspartnership.co.uk