

- LEGEND:
- ⊕ Indicates heat detector
 - ⊙ Indicates smoke detector
 - ⊘ Indicates monoxide detector
 - ⊖ Indicates fire escape window

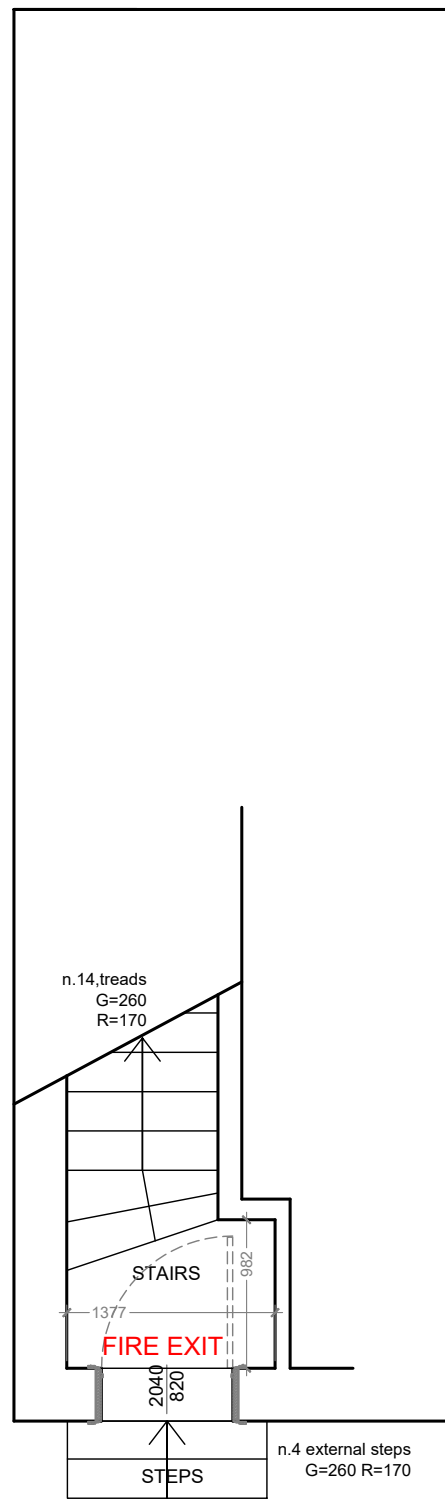

Ground Floor access

SCALE
1:50 0 0.5m 1m

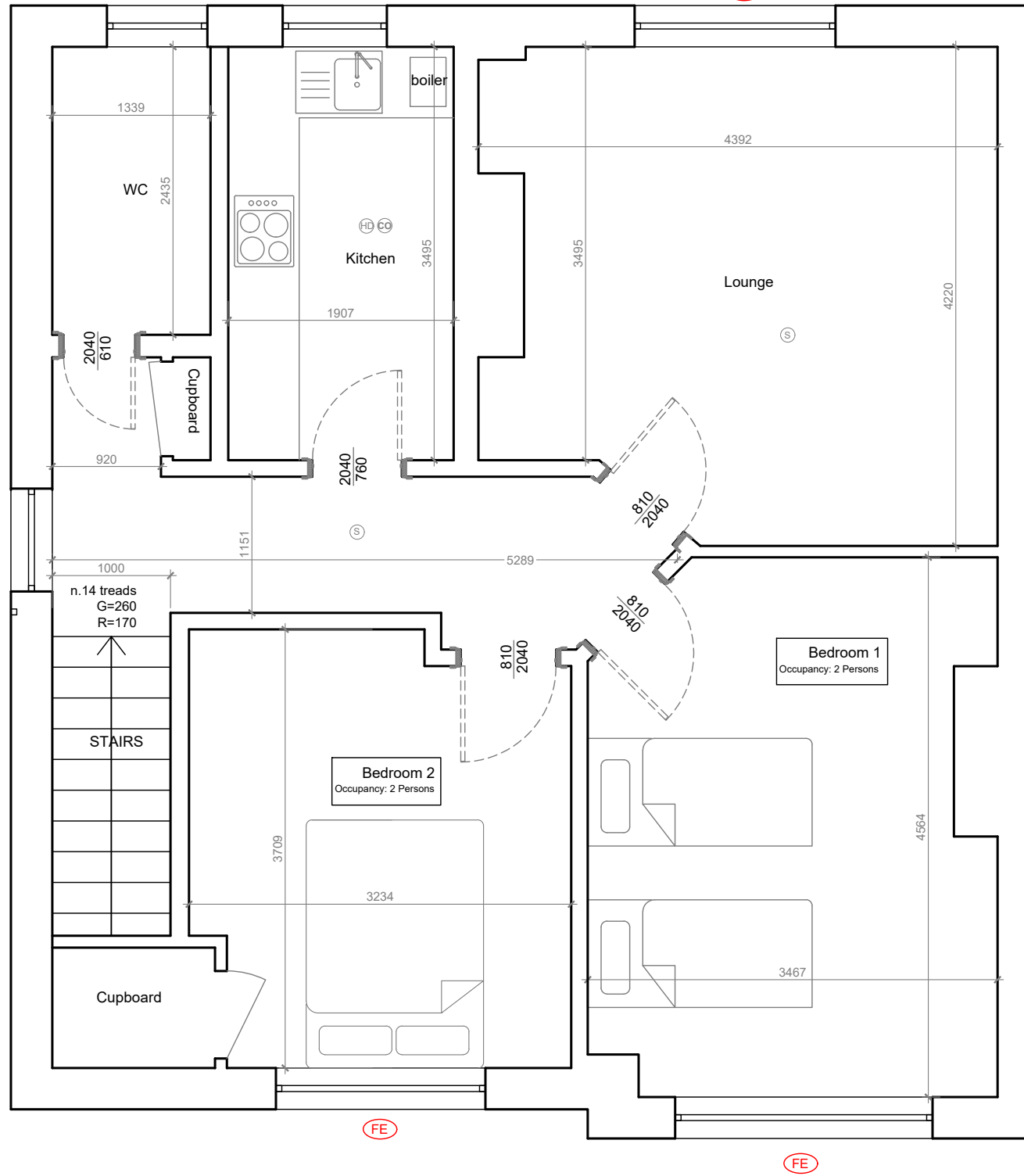

Upper level

SCALE
1:50 0 0.5m 1m

NOTE 2:
The entire flat (located at first floor of a 'four in a block' property) will be part of a short let and will be fully available to guests. In particular the bedrooms will be occupied as per below:

- Bedroom 1 (n.2 occupants)
- Bedroom 2 (n.2 occupants)

The entire flat shall host a maximum of 4 occupants to sleep. They will have access to any facility and any other rooms such as kitchen and sitting area during their staying.

Drawing title: **Short term letting application**

Address: **94 Househillwood Road
G53 6AU**

for: - Drawing Number:

scale: **1:50@A3** **01**