



(PH)
The Hatherley

HATHERLEY ROAD

CAERNARVON ROAD

Caernarvon
Court car park

Shelter

Existing asses to
property remain
unchanged

Existing
concreted front
parking area to
be removed

52.7m

Garage to be
demolish

Outside storage
to be demolish

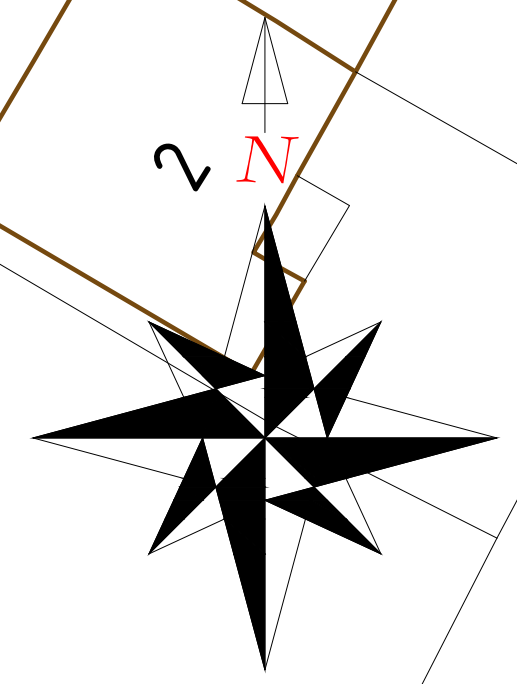

<p>— Boundary</p>	
<p>AMENDMENT 16/02/2024</p>	
<p>Notes:</p> <p>THIS DRAWING IS TO BE CHECKED & VERIFIED BY THE CONTRACTOR PRIOR TO WORK COMMENCING ON SITE & ANY DISCREPANCY OR QUERY SHALL BE IMMEDIATELY REPORTED & RESOLVED BEFORE PROCEEDING WITH CONSTRUCTION.</p>	
<p>DRAWING DESCRIPTION:</p>	<p>EXISTING BLOCK PLAN Proposed single storey side and rear extension</p>
<p>SITE:</p>	<p>304 Hatherley Road, Cheltenham, GL51 6HR</p>
<p>CLIENT:</p>	<p>Mi Botta Miniqamk</p>
<p>DATE: 16/02/2024</p>	<p>DWG NO: 304_HR_E&R_AM_16_02_24</p>
<p>SCALE: 1:200 (as noted @A2)</p>	<p>DRAWN: T.Zadnyga</p>
<p>This design remains copyright to Tamesh Zadnyga. Changes should be agreed with the designer. Please check you are working off the most recent version of the data. It is the responsibility of the user/members to ensure they are installing this file to the appropriate data directory. The designer is not responsible for this file being installed incorrectly or unsafely. It is strongly recommended to verify all measurements on site. This drawing has been produced for planning purposes only and should not be used for any other purpose. This drawing may be subject to amendments without approval from Tamesh Zadnyga. Users undertake that if consent is given for all copies, they will remain the property of Tamesh Zadnyga. This drawing cannot be guaranteed in any circumstances without the designer's check.</p>	
<p>WWW.TDPLAN.CO.UK ARCHITECT DRAWING SERVICE</p>	