

Indicative only

51

1

BECKMEADOW WAY

Issue: Proposed replacement gravel surfacing situated within the RPAs of retained trees 3, 4, 6.

Solution: The existing concrete surfacing will be carefully broken up and the new gravel surfacing will be backfilled to provide the finished level. There will be no excavation within the RPAs of retained trees deeper than the soil level beneath the existing concrete surfacing. Therefore, there will be no new impact to the RPAs of retained trees.

Issue: Proposed gravel surfacing situated within the RPA of retained tree 1.

Solution: A cellular confinement system or other approved no-dig sub-base will be used to ensure root damage is minimised.

Arboricultural Impacts	
Impacts	No. of trees
Trees to be removed	0
Groups / hedges to be removed (partial removal of group)	1 (1)
Trees with proposed incursions into RPAs	0
Trees that will require pruning	0
Groups / hedges that will require pruning	0
Trees to be transplanted	0
Groups / hedges to be transplanted	0

Arboricultural Impacts - RPAs (Area)				
No.	Species	RPA	Incursion	
1	Conifer/evergreen	21.26	4	1.0
3	Rowan	14.05	5.8	26.5
4	Rowan	19.95	7.7	36.6
6	Sycamore	25.06	2.5	9.6

Tree Work Schedule			
No.	Species	Works	Category
H1	Various	Fall: partially remove group and dig out stumps to allow for resurfacing work	C2
H6	Various	Fall: remove entire group and dig out signal stumps to allow for reconstruction of the garage	C3

All tree work is to be undertaken in accordance with British Standard BS 3998:2010 Tree Work - Recommendations. All arising soil to be removed and the site is to be left as found. Care is to be taken of the ground around retained trees to make sure that it does not become compacted as a result of tree surgery operations. No equipment or vehicles such as timber lorries, tractors, excavators or cranes shall be parked or driven beneath the crowns of any retained trees, to prevent subsequent compaction and root death.

No. of individual trees to be removed			
U	A	B	C
0	0	0	0

No. of groups / hedges to be removed			
U	A	B	C
0 (0)	0 (0)	0 (0)	1 (1)

U = Partial removal of a group

Arboricultural Method Statement

All tree work is to be undertaken in accordance with British Standard BS 3998:2010 Tree Work - Recommendations. All arising soil to be removed and the site is to be left as found. Care is to be taken of the ground around retained trees to make sure that it does not become compacted as a result of tree surgery operations. No equipment or vehicles such as timber lorries, tractors, excavators or cranes shall be parked or driven beneath the crowns of any retained trees, to prevent subsequent compaction and root death.

53

2

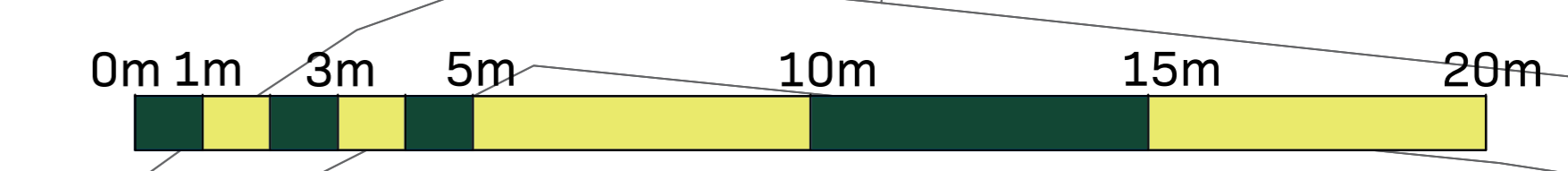
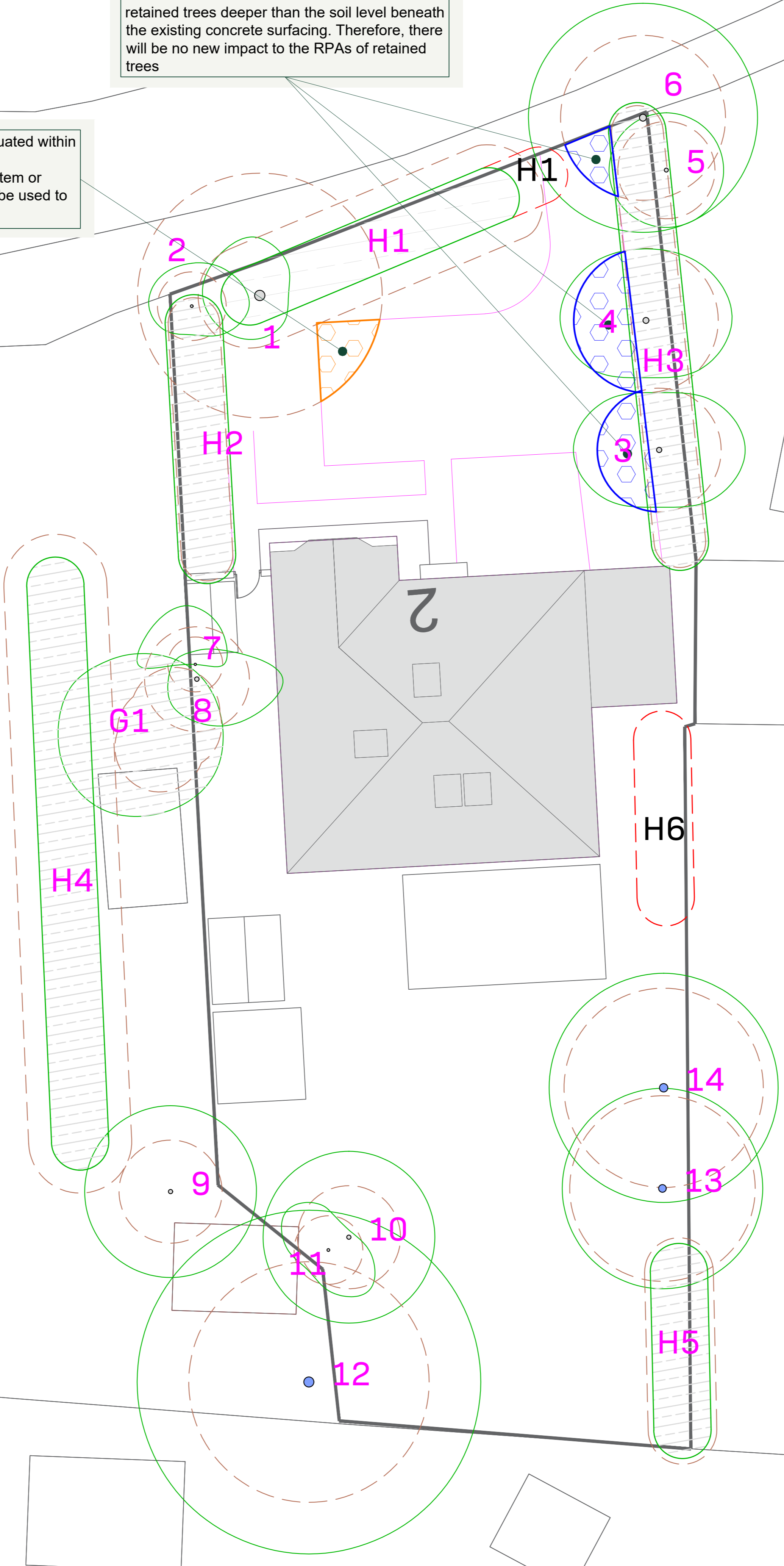

Unit 3, Well House Barns, Chester, CH4 0DH
 https://arbtech.co.uk, 01244 661170

Project:
**2 Beckmeadow Way
 Mundesley
 NR11 8LP**

Client:
Mr & Mrs Keen

Drawing:
Arboricultural Impact Assessment

Based on:
0223 - SK01

Drawing No:
Arbtech AIA 01

Date:
Jan 2024

Scale:
1:100 @ A0

Drawn:
DM

Key:			
Tree Nos. 1	Tree Canopies	Trunk	10' trees
RPA: 10' groups	Vegetation removed	Existing site (OS map)	Incursion - dig and resurfacing
Category C2 groups	Incursion - dig and resurfacing	Incursion - replaced	