

EXISTING GROUND FLOOR PLAN
1 : 50

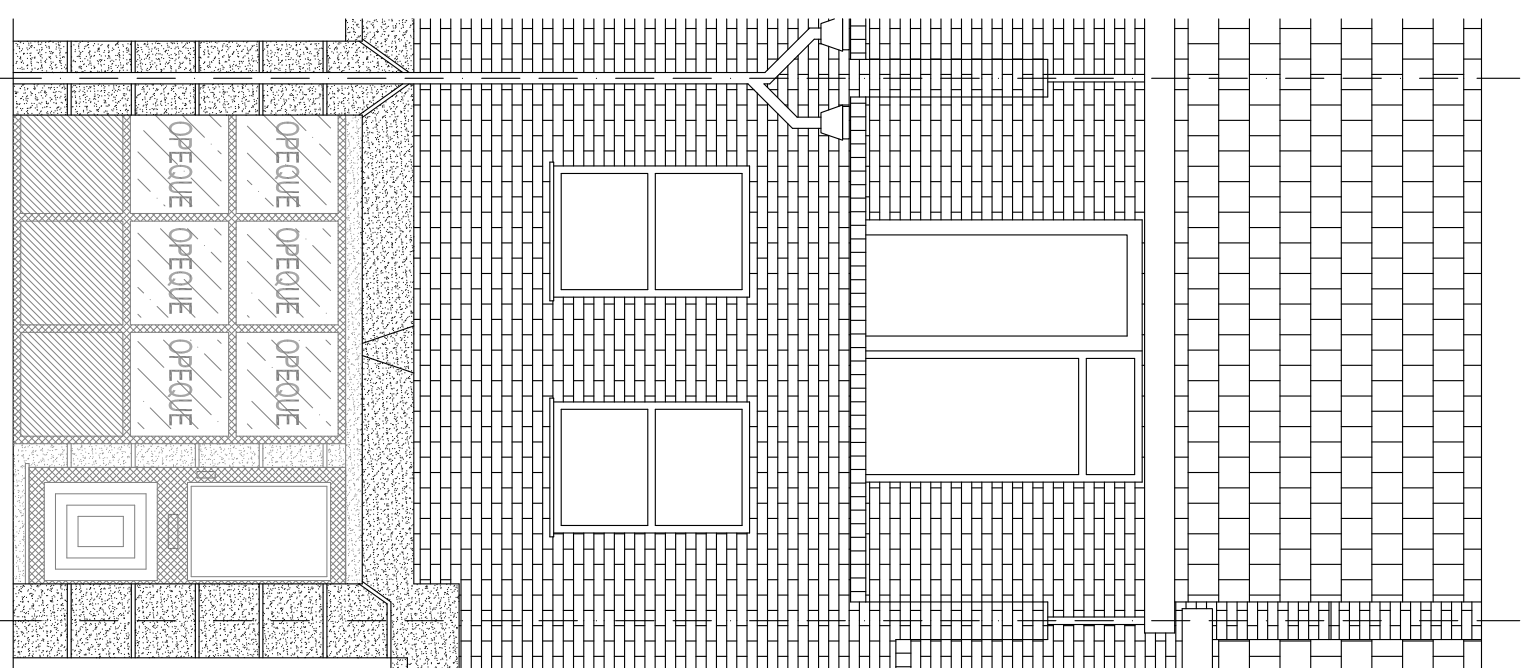

EXISTING FRONT ELEVATION
1 : 50

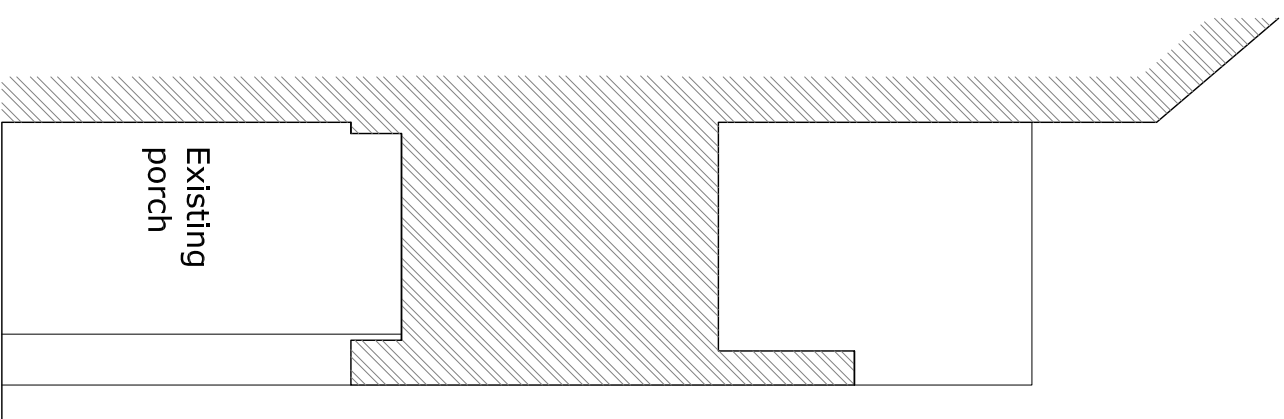

EXISTING SECTION
1 : 50

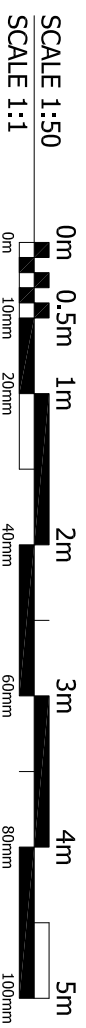

PLANNING		DATE 10/02/24		DRAWN R. Brukiene	
CLIENT Povilas Zemantauskas		SCALE 1:50 @A3		DRAWING NUMBER P102	
PROJECT 29 Damask Crescent, Canning Town, E16 4PQ		REV.			
TITLE Existing Drawings					

BA 30 St Katherine Rd, E16 4DS Tel: 07963496322
 E-mail: rfm@brooksarch.co.uk Web: www.brooksarch.co.uk

NOTES:
 All items, notes, dimensions and general design contained on this drawing are shown for guidance purposes. Nominated Builder or person responsible for the project should make a thorough check prior to commencement of works against the site, drainage services drawings, current Building Regulations, British Standards, Codes of Practice and appropriate manufacturers recommendations that from time to time shall apply. The Originator (Brooks Architecture) will not accept any liability for mistakes that could occur. Verify all dimensions on site before commencing any work, preparing shop drawings or before materials are ordered.
 Copyright exists on the designs and information shown on this drawing.