

All dimensions are to be verified on site prior to construction.
 Figured dimensions are to be taken in preference to scaling.
 Copyright of illustrated design material is retained by this office. Authority is required for reproduction.

STATUS:
PLANNING

REVISION:

ISSUE	DATE	AMENDMENT
A	13.02.2024	Planning Application

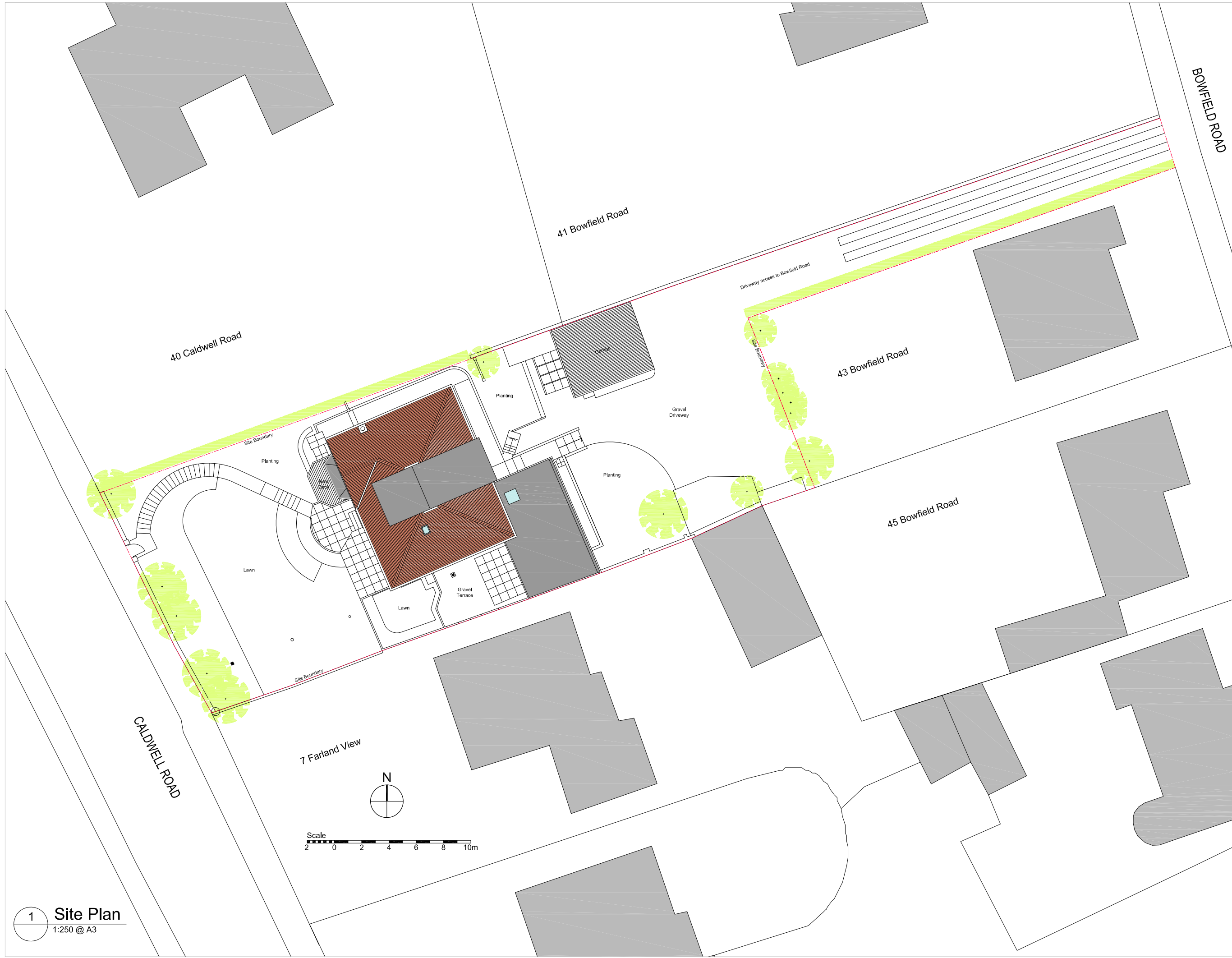

1 Site Plan
 1:250 @ A3

ARCHITECT:
James Hair Architect
 Crawford Lodge
 North Shore
 Ardrossan
 KA22 8PG
 t: 01294 601 004
 m: 0775 601 2796
 e: jhair@jameshairarchitect.com

CLIENT:
 D & K HOWIE

PROJECT:
 RAISED DECK
 42 CALDWELL ROAD
 WEST KILBRIDE

DRAWING TITLE:
 SITE PLAN

DWG NO:
 CR-P2-002

SCALE	PROJECT NO.	ISSUE
1:250@A3	CR/01/24	A
	DRAWN BY: JH	
	ISSUE DATE: 13.02.2024	