

GENERAL NOTES:

1. THE DRAWINGS, DESIGN AND ALL INFORMATION CONTAINED THEREIN ARE THE SOLE COPYRIGHT OF CANHAM CONSULTING LTD AND ANY REPRODUCTION IS FORBIDDEN UNLESS PERMISSION IS OBTAINED IN WRITING.
2. ALL DRAWINGS SHALL BE READ IN CONJUNCTION WITH ALL RELEVANT CIVIL / STRUCTURAL ENGINEERING DRAWINGS, THE PROJECT SPECIFICATION AND DRAWINGS PRODUCED BY THE ARCHITECTS, SERVICE ENGINEERS AND LANDSCAPE ARCHITECTS.
3. ANY DISCREPANCIES BETWEEN THE INFORMATION GIVEN BY THE ENGINEER, AND THAT PROVIDED BY OTHERS, MUST BE REFERRED TO THE ENGINEER BEFORE THE AFFECTED WORKS PROCEED.
4. DIMENSIONS MUST NOT BE SCALED FROM THE ENGINEER'S DRAWINGS.
5. ALL DIMENSIONS ARE IN MILLIMETRES UNLESS NOTED OTHERWISE.
6. THE CONTRACTOR IS TO ENSURE THE STABILITY OF EACH ELEMENT AND THE STABILITY OF THE OVERALL CONSTRUCTION UNTIL THE WORKS ARE COMPLETE.
7. ALL DESIGNS, CONNECTIONS, WORKMANSHIP AND MATERIAL ARE TO COMPLY WITH THE CURRENT BUILDING REGULATIONS AND THE LATEST RELEVANT BRITISH STANDARD SPECIFICATION AND CODES OF PRACTICE OR OTHERWISE BE TO THE SPECIFIC WRITTEN APPROVAL OF THE ENGINEER.
8. INSPECTIONS MADE BY THE LOCAL AUTHORITY, SHALL BE ARRANGED BY THE CONTRACTOR TO SUIT HIS PROGRAMME. ANY COST ARISING OUT OF FAILING TO CARRY OUT THE WORK TO THE SATISFACTION OF THE LOCAL AUTHORITY WILL BE THE SOLE RESPONSIBILITY OF THE CONTRACTOR.
9. THE CONTRACTOR MUST MAKE THEMSELVES AWARE OF THE EXISTING UTILITIES / SERVICES LOCATED WITHIN AND ADJACENT TO THE SITE. **NO EXCAVATIONS ARE TO BE UNDERTAKEN UNTIL THE UTILITY COMPANIES HAVE BEEN INFORMED / CO-ORDINATED WITH.** DIAL-BEFORE-YOU-DIG ADVICE IS FOLLOWED AND THE AREA IS CAT SCANNED. ALL UTILITY COMPANY GUIDELINES AND HEALTH & SAFETY PROCEDURES MUST BE STRICTLY FOLLOWED.
10. CBR VALUES ASSUMED TO BE 2% CONTRACTOR TO UNDERTAKE CBR TESTING ON SITE TO CONFIRM CBR VALUES AND ESTABLISH EXTENTS OF CAPPING REQUIREMENTS.

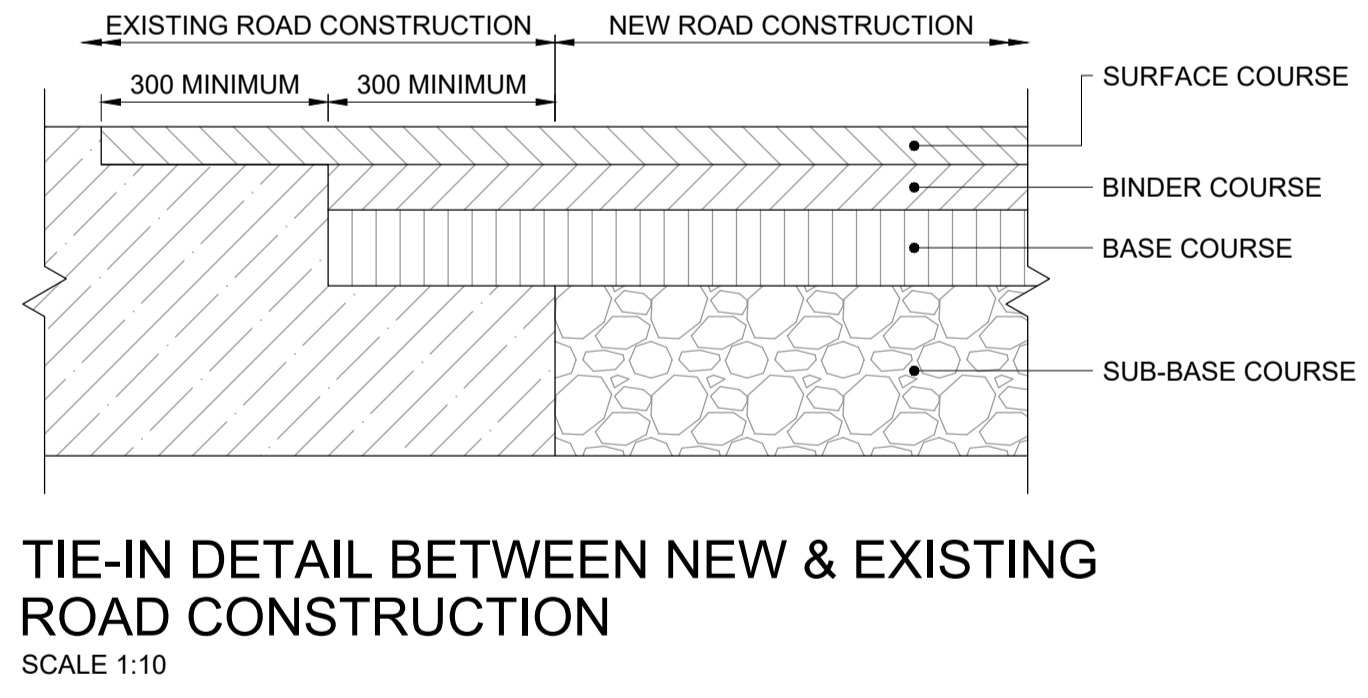
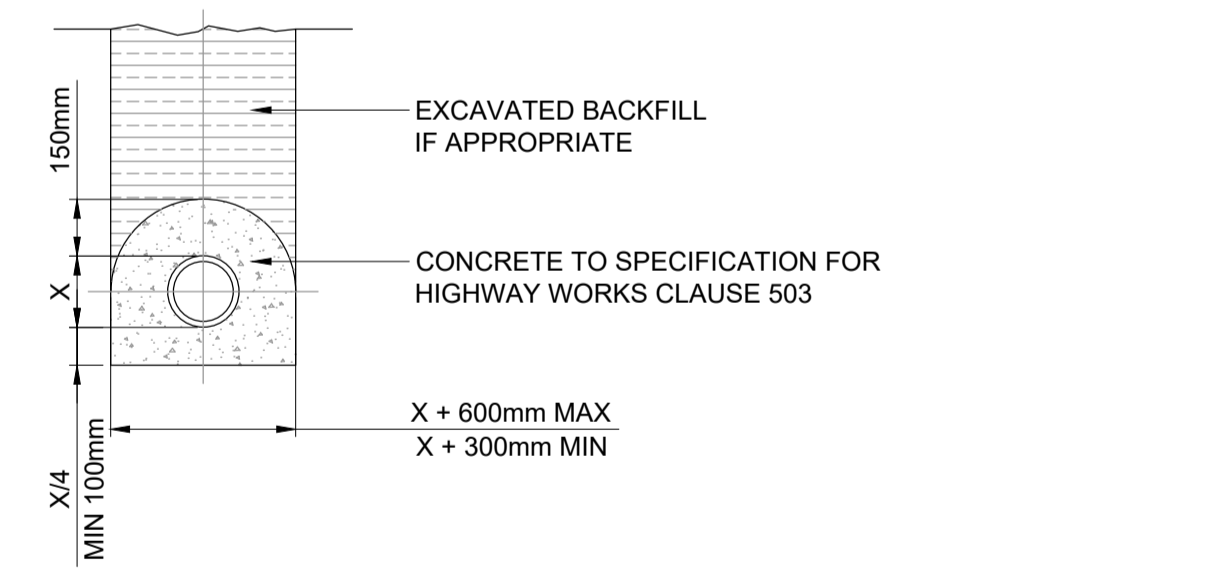
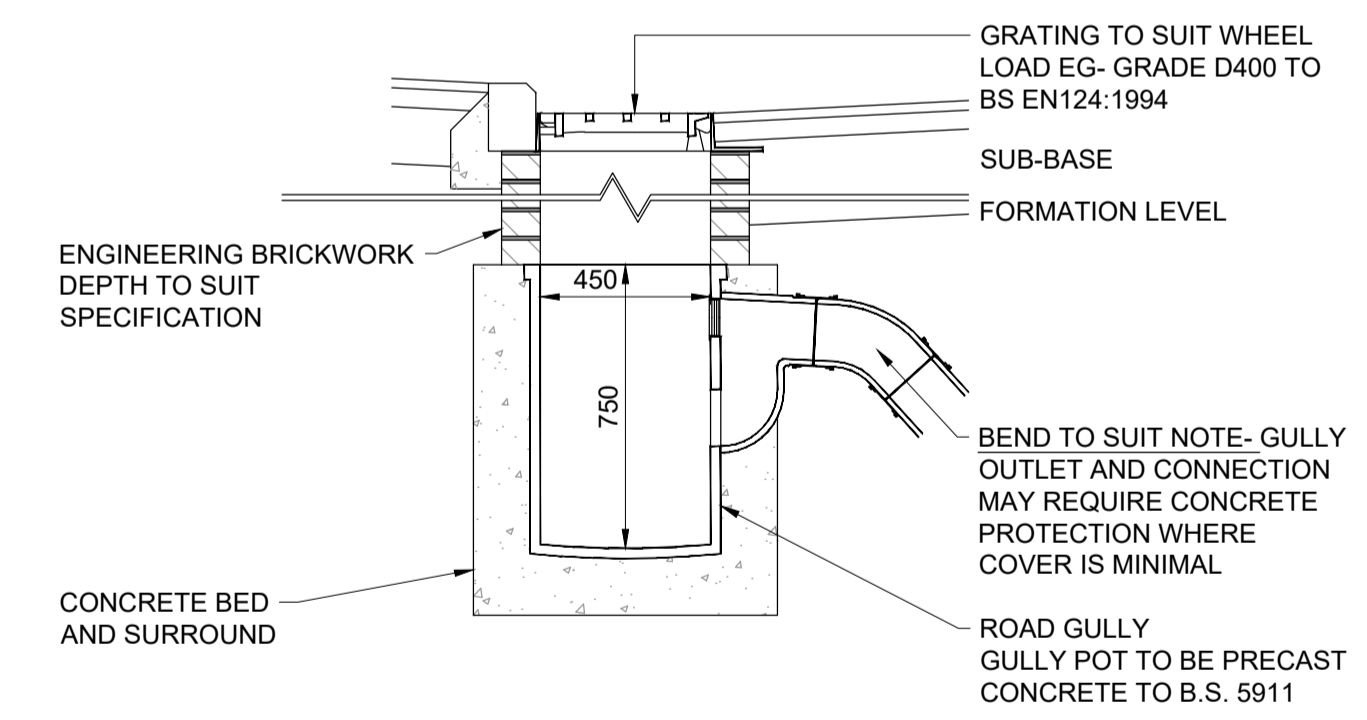
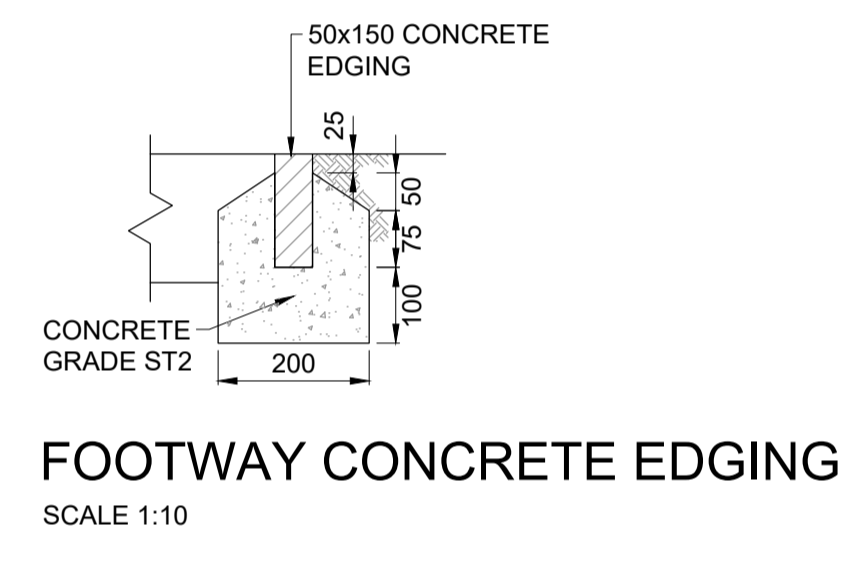
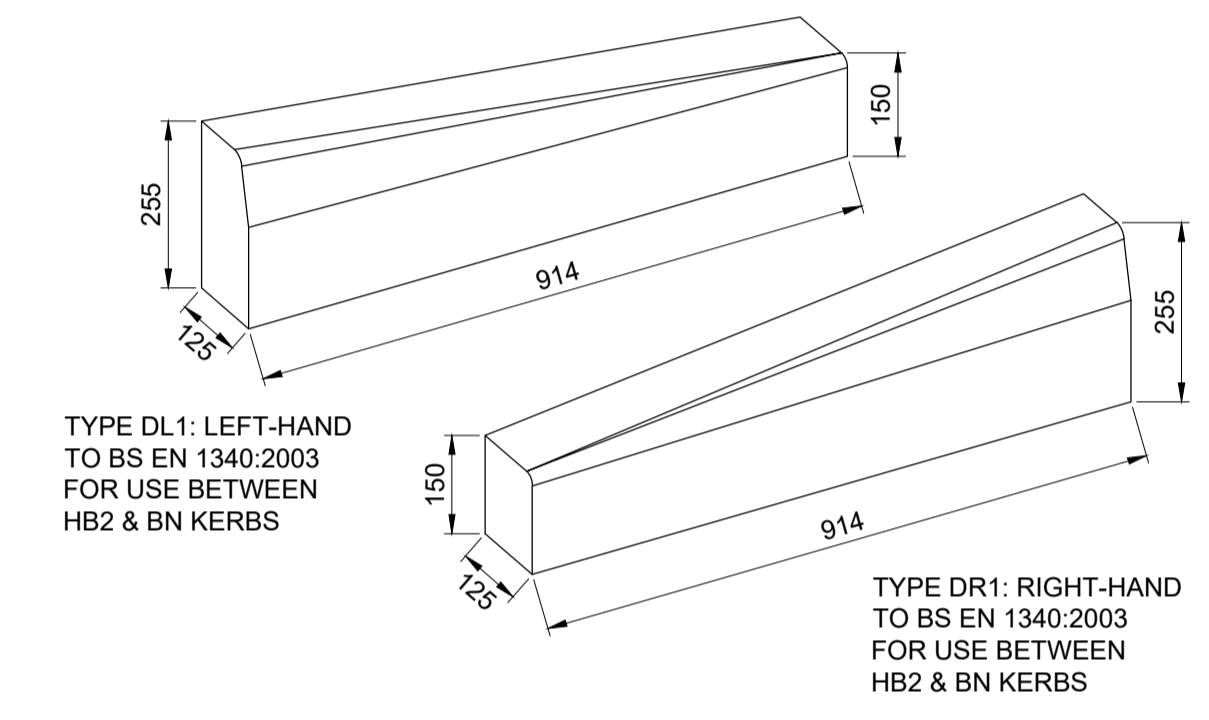
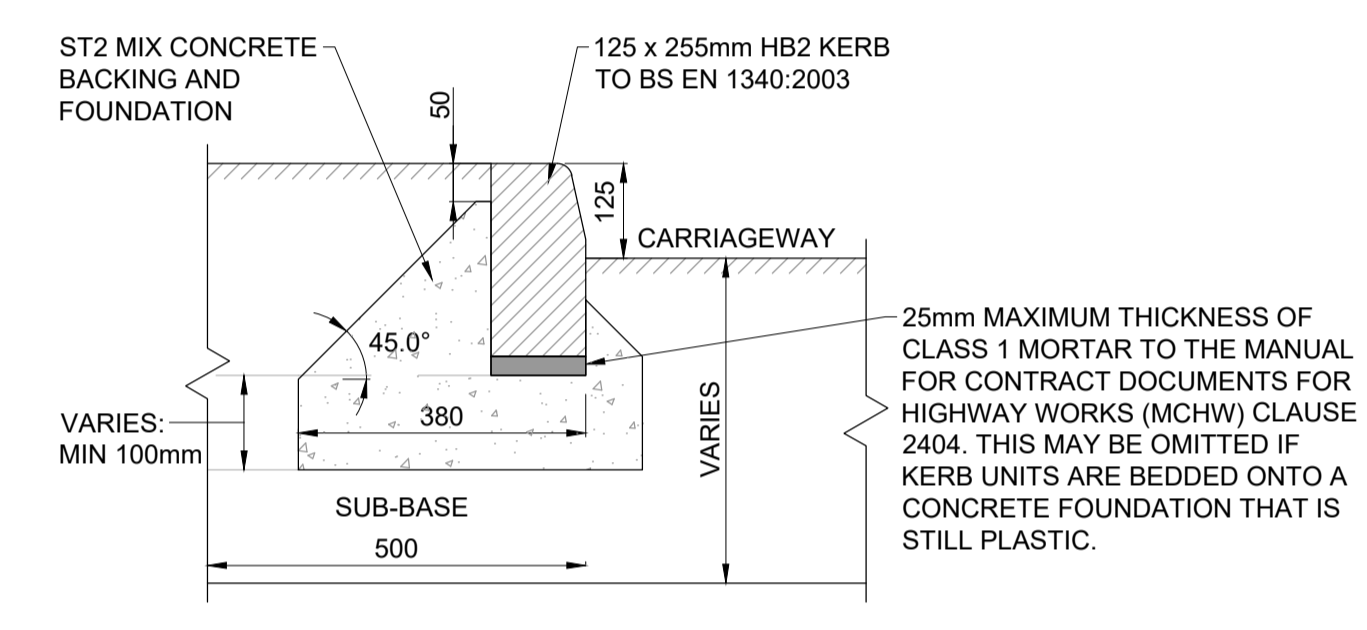
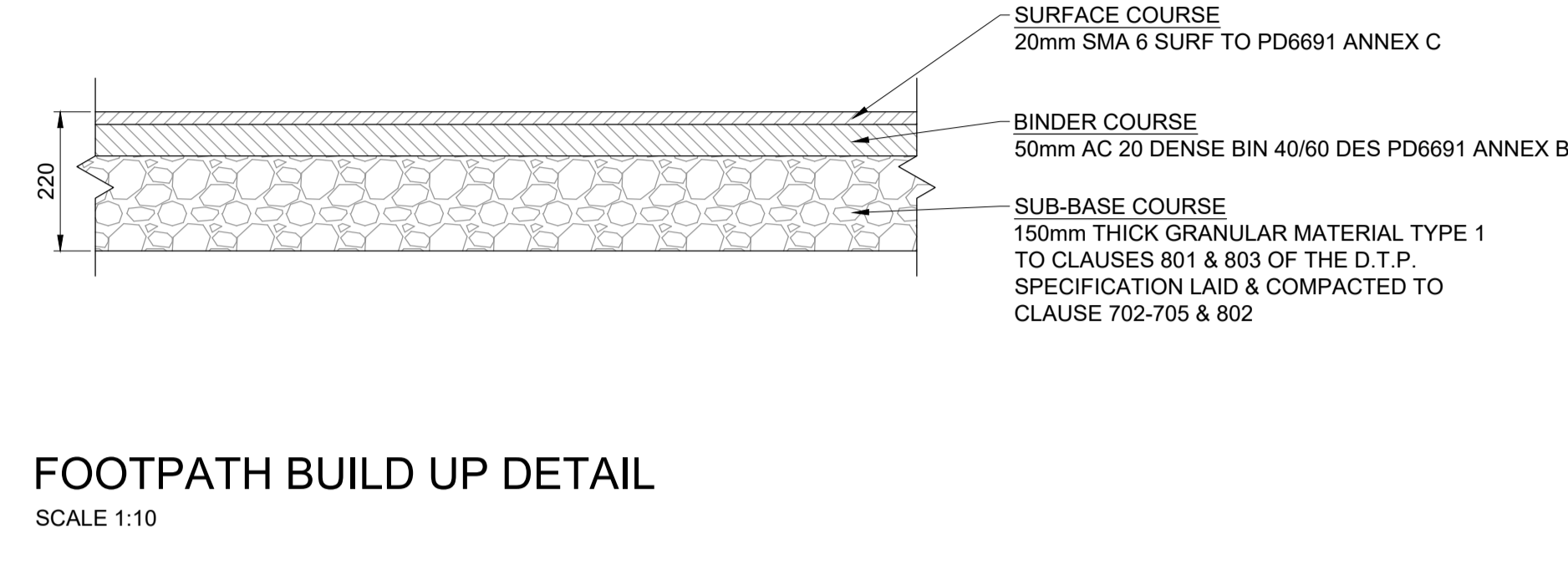
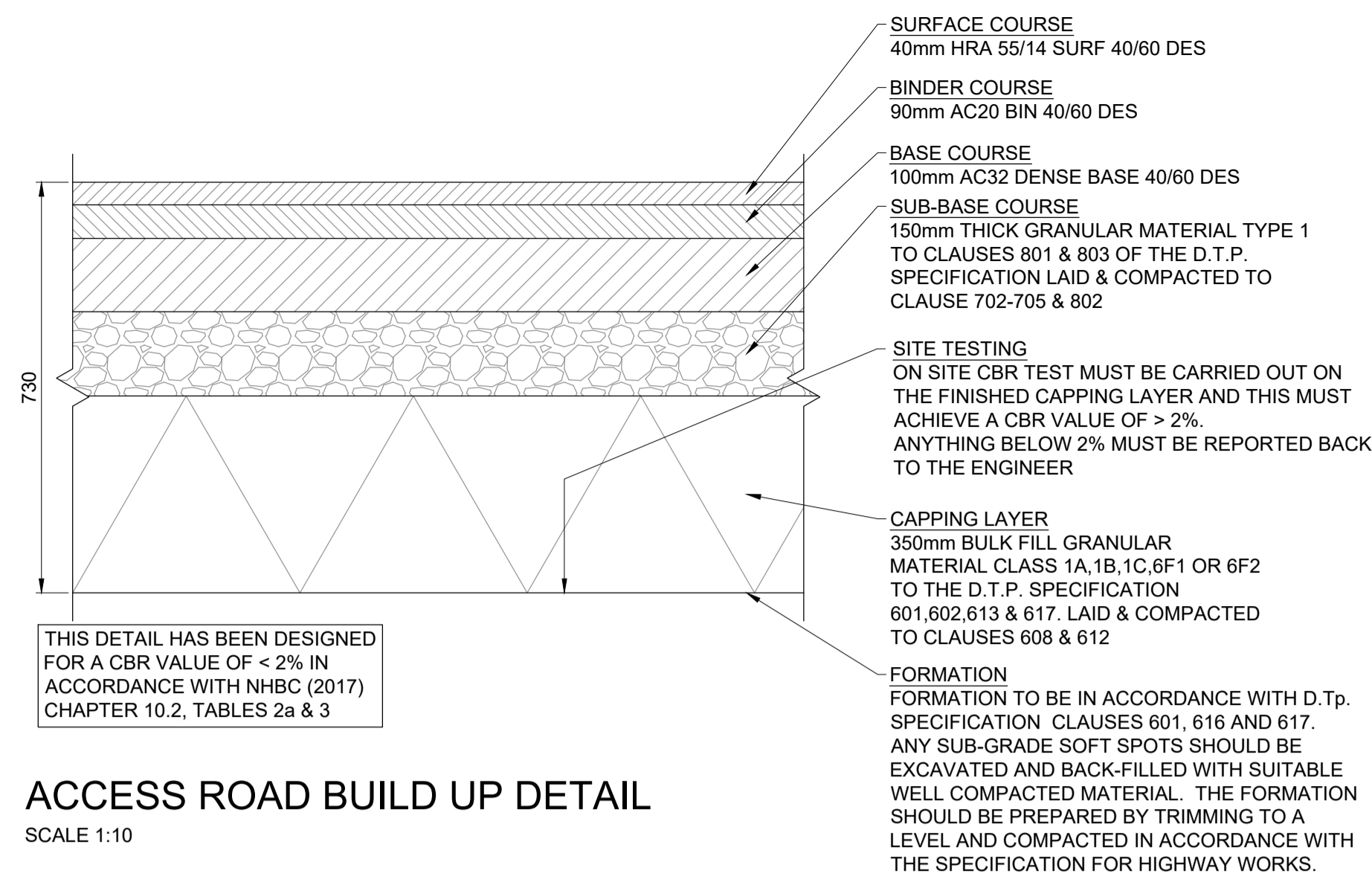

PRELIMINARY DRAWING:  
THIS DRAWING IS FOR PRELIMINARY PURPOSES ONLY AND MUST NOT BE READ AS A CONSTRUCTION ISSUE. IT INDICATES DESIGN INTENT ONLY AND IS SUBJECT TO AMENDMENT DURING FINAL DESIGN DEVELOPMENT.

P01	15.01.24	PRELIMINARY ISSUE	KS	MR
rev	date	details	drawn	checked

**Canham Consulting**  
Structural Engineers | Civil Engineers | Building Surveyors

+44 (0)1603 430650 | mail@canhamconsulting.co.uk | www.canhamconsulting.co.uk  
client: WARREN HILL FARMS, EYE, SUFFOLK  
architect: TRUNDLEY, KINGS LYNN  
project: FARM SHOP, WARREN HILL FARM, OAKLEY, SUFFOLK  
title: SMALL HIGHWAY WORKS: CONSTRUCTION DETAILS

CCL ref:	drawn	design	checked	scale	size	date
219528	KS	MR	AS SHOWN	A1 (L)	15.01.2024	

status: S3 - SUITABLE FOR REVIEW & COMMENT  
drawing number: 219528-CCL-XX-00-DR-C-4900 P01  
revision:

THIS DESIGN IS PRODUCED IN ACCORDANCE WITH THE CONSTRUCTION (DESIGN AND MANAGEMENT) REGULATIONS 2016 INCORPORATING THE APPROVED CODE OF PRACTICE REGULATIONS 17 AND 17. THOSE ALTERNING THE DESIGN WITHOUT THE AUTHORITY OF CANHAM CONSULTING LTD SHOULD BE AWARE THEY MAY ALSO ASSUME RESPONSIBILITY FOR THESE DETAILS.