

Notes
 This drawing has been prepared for the purpose of gaining planning permission only and does not purport to be a working or contractual drawing and should not be used for any building or contractual purposes.
 This drawing has been prepared based on survey drawings and information prepared by others.
 All dimensions and levels on all drawings must be checked and verified on site before commencement of works.

© Copyright
 This drawing is the property of B Newton Architecture. No disclosure or copy of it may be made without the written permission of B Newton Architecture.

PLAN

Existing Areas:
 Site total: 310 sq.m
 Service yard total: 110 sq.m
 Hardstanding: 80 sq.m
 Mound: 240 sq.ft / 20 sq.m



Revisions

Date	Rev	Details
04/12/2023	/	Issued for Planning
12/12/2023	/	Issued for Planning
07/02/2024	/	Issued for Planning



B. Newton Architecture
 B. Newton Architecture
 Chichester, West Sussex
 T: +44 788 609 1177
 E: bnwtonarchitecture@gmail.com

Project Title & Address
5A, 5 & 7 Church Street
 Basingstoke
 Hampshire, RG21 7QG

Drawing Title
Site Plan
 as Proposed

Scale	Creation Date	Status
1:100@A3	Dec 2023	PLAN

Project No.	Drawing No.	Revision
145	104	/

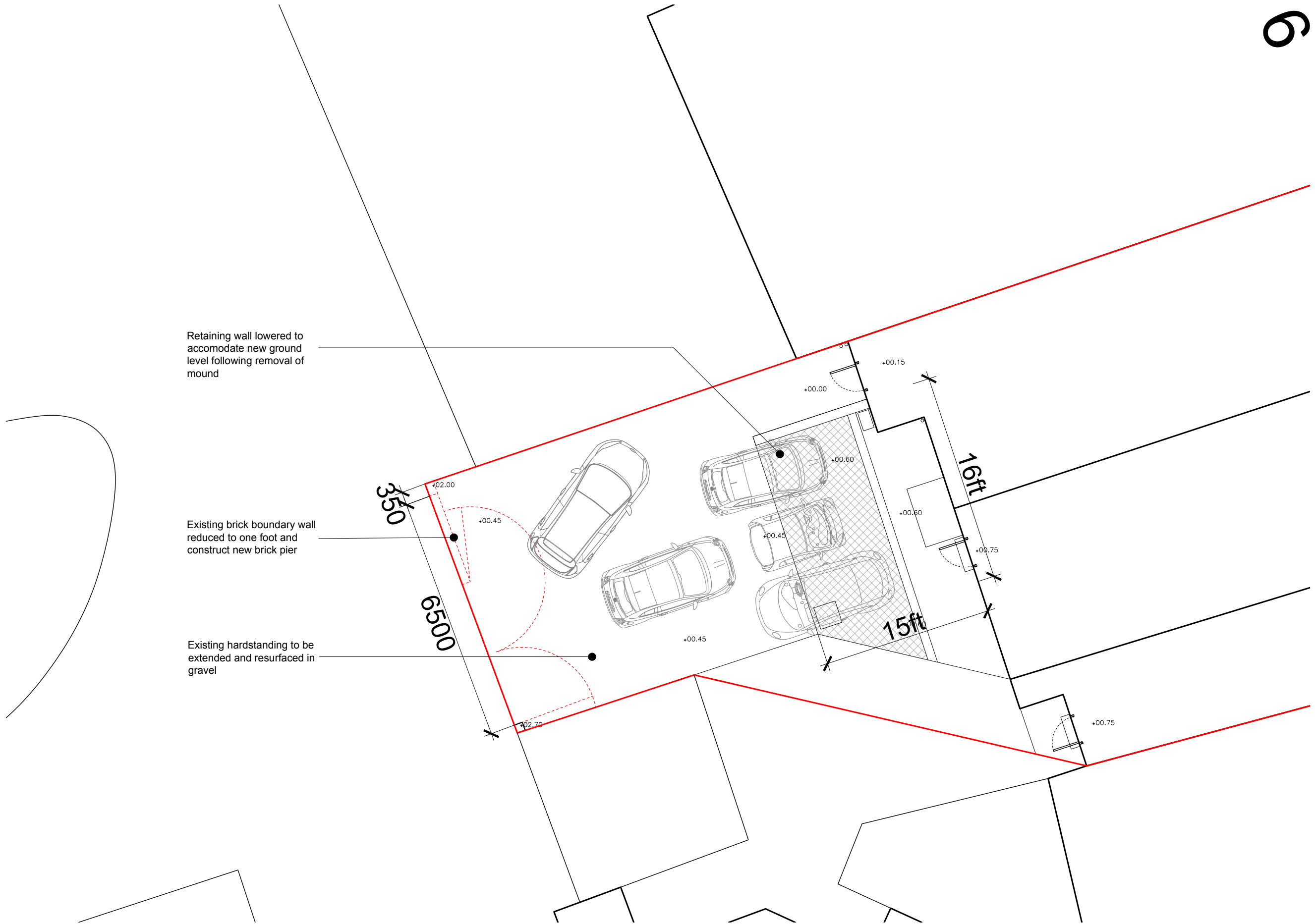

Retaining wall lowered to accommodate new ground level following removal of mound

Existing brick boundary wall reduced to one foot and construct new brick pier

Existing hardstanding to be extended and resurfaced in gravel

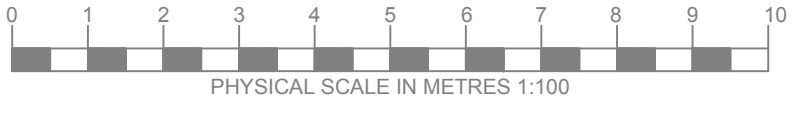

① **SITE PLAN - AS PROPOSED**
 Scale: 1:100