

Ground-Guards

Ground protection and site access system

Ground-Guards are an "Instant Roadway" system of lightweight plastic panels, capable of taking vehicles of up to 50 tonnes weight.

DESCRIPTION

The Ground-Guard system is a temporary ground protection system for the protection of unpaved areas during construction and site access. It is a system of interlocking plastic panels, which are laid over the ground surface to create a temporary roadway. The Ground-Guard system is designed to be used in areas where the ground is soft, wet, or otherwise unsuitable for heavy vehicles. The system is easy to install and remove, and it provides a safe and stable surface for vehicles and equipment.

SUPPLY

Ground-Guard panels are available in a range of sizes and thicknesses to suit different applications. They are made from high quality, recycled plastic, and they are available in a range of colors.

SERVICES

Ground-Guard panels are available in a range of sizes and thicknesses to suit different applications. They are made from high quality, recycled plastic, and they are available in a range of colors.

GreenTek

EuroMat®
Heavy Duty Temporary Access Mat

Supporting loads up to 50 tonnes, EuroMat® is the ultimate heavy duty mat for temporary roadways and work areas. EuroMat® is available for the construction, civil engineering and ground work industries.

Heavy Duty Temporary Access Mat

Supporting loads up to 50 tonnes, EuroMat® is the ultimate heavy duty mat for temporary roadways and work areas. EuroMat® is available for the construction, civil engineering and ground work industries.

Logistics

Lighter in weight than conventional wood or steel alternatives, EuroMat® offers the environmental benefits of non-rubbish loading per wagon and is turn reducing transportation costs and carbon emissions.

Temporary ground protection (magenta shading) installed on unsurfaced RPAs outside fencing, until such time as new no-dig permeable surfacing for car parking is installed (red hatch) - refer to AMS

Temporary BS5837 tree fencing to protect unsurfaced RPAs for duration of site works

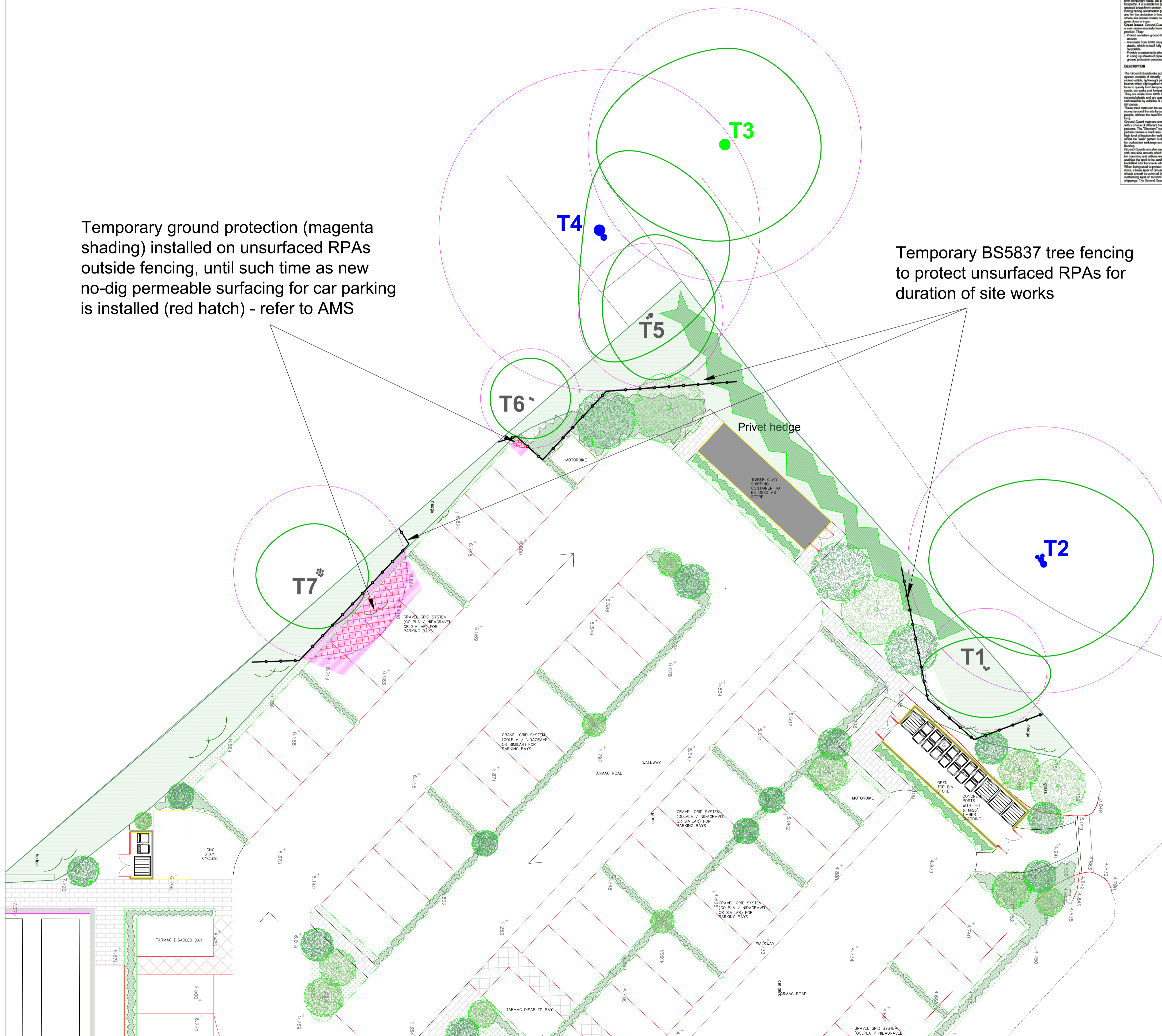

Examples of temporary ground protection required to protect unsurfaced RPA where vehicular access is required

PROTECTIVE FENCING. THIS FENCING MUST BE MAINTAINED IN ACCORDANCE WITH THE APPROVED PLANS AND DRAWINGS FOR THIS DEVELOPMENT.

TREE PROTECTION AREA
KEEP OUT!
(TOWN & COUNTRY PLANNING ACT 1990)
TREES ENCLOSED BY THIS FENCE ARE PROTECTED BY PLANNING CONDITIONS AND/OR ARE THE SUBJECTS OF A TREE PRESERVATION ORDER. CONTRAVENTION OF A TREE PRESERVATION ORDER MAY LEAD TO CRIMINAL PROSECUTION.
ANY INCURSION INTO THE PROTECTED AREA MUST BE WITH THE WRITTEN PERMISSION OF THE LOCAL PLANNING AUTHORITY

Examples of protective fencing signage

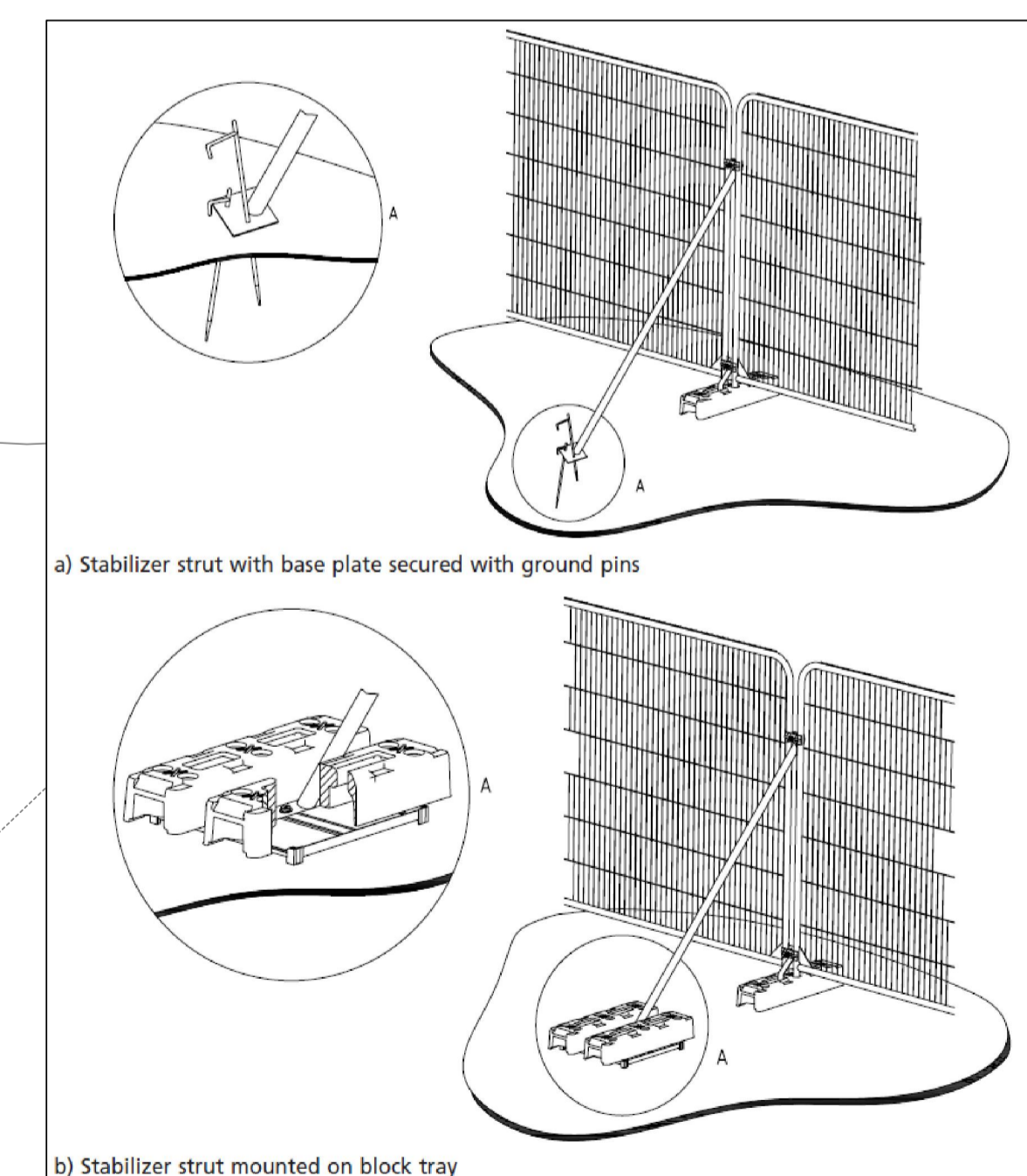

Examples of above-ground stabilising systems (reproduced from BS 5837:2012 Trees in relation to design, demolition and construction - Recommendations)

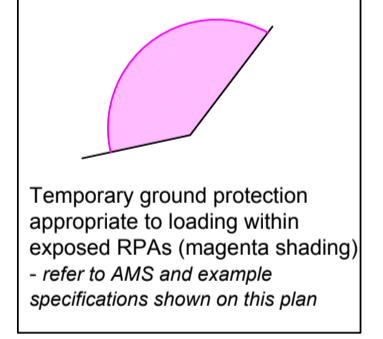
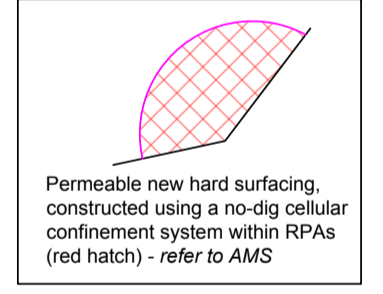
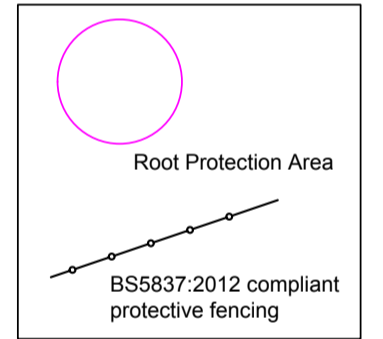

WOODSIDE TREE CONSULTANCY

M: 07867 725238
E: info@woodsidetrees.co.uk
W: www.woodsidetrees.co.uk

CLIENT:
A2K

PROJECT:
Land at Alibon Hotel, Freshwater Bay

DRAWING TITLE:
Tree Protection Plan

DRAWING NO: AS/DW0124 TPP	REV.
DRAWN BY: AS	DATE: 26.01.2024

SCALE:
1:125 @ A1

© Woodside Tree Consultancy

Site as proposed