

NOTES: THIS DRAWING IS THE COPYRIGHT OF MODH DESIGN LTD. IT MAY NOT BE COPIED, ALTERED OR REPRODUCED WITHOUT WRITTEN AUTHORITY. THE USE OF THIS DRAWING BY THIRD PARTIES IS ENTIRELY AT THEIR OWN RISK.

THE DRAWING MUST NOT BE SCALED. ALL LEVELS AND DIMENSIONS MUST BE CHECKED ON SITE. FIGURED DIMENSIONS MUST BE CHECKED ON SITE. FIGURED DIMENSIONS SHOULD BE TAKEN IN PREFERENCE TO SCALED DIMENSIONS.

FOR PLANNING APPLICATION  
SUBMISSION PURPOSES ONLY

 LINE DENOTES SITE APPLICATION BOUNDARY

TOTAL SPACES CARS & MOTORBIKES: 67 & 18 BIKES.

PROPOSED CAR PARKING NUMBER: 65 SPACES.

BREAKDOWN OF SPACES AS FOLLOWS:  
59 X GUEST PARKING SPACES  
(41 X HOTEL RESIDENTS BAYS)  
(18 X DINING / SPA BAYS)  
3 X DISABLED PARKING BAY  
(1 X DINING BAYS & 2 X HOTEL / SPA BAYS)  
3 X ELECTRIC CAR CHARGING

2 X MOTORBIKES  
10 X LONG STAY CYCLE PARKING (COVERED & LOCKABLE)  
8 X SHORT STAY CYCLE PARKING

NORTHERN ENTRANCE TO BE BLOCKED IN WITH ACCESS FOR BIN STORE. MAIN EXISTING ENTRANCE TO BE WIDENED.  
CAR PARK IS PRIVATELY OWNED. USE TO BE FOR HOTEL GUESTS ONLY.

B	22.01.24	PROPOSED GLAZED COURTYARD FOR SPA, CAR PARK LAYOUT ALTERATIONS, BIN STORE LOCATION AMENDED
A	17.08.23	REVISIONS TO LANDSCAPE

REVISIONS: DATE: NOTE:



A | STUDIO 1, NEW BARN FARM, SUN HILL, CALBOURNE, IOW PO30 4JA  
T | 01983 555051  
W | WWW.MODHDESIGN.CO.UK  
E | HELLO@MODHDESIGN.CO.UK

CLIENT:  
A2K LEISURE LLP

PROJECT:  
PROPOSED SPA BUILDING & CAR PARK ALTERATIONS AT THE ALBION HOTEL, FRESHWATER BAY, FRESHWATER PO40 9RA

DRAWING TITLE:  
PROPOSED SITE PLAN

SCALE: VARIES@A1 DATE: APRIL 23 DRAWN: EF

STAGE: PLANNING APPLICATION CHECKED BY: CC

JOB NUMBER: MDA223 DRAWING NUMBER: PL 200 REVISION: B

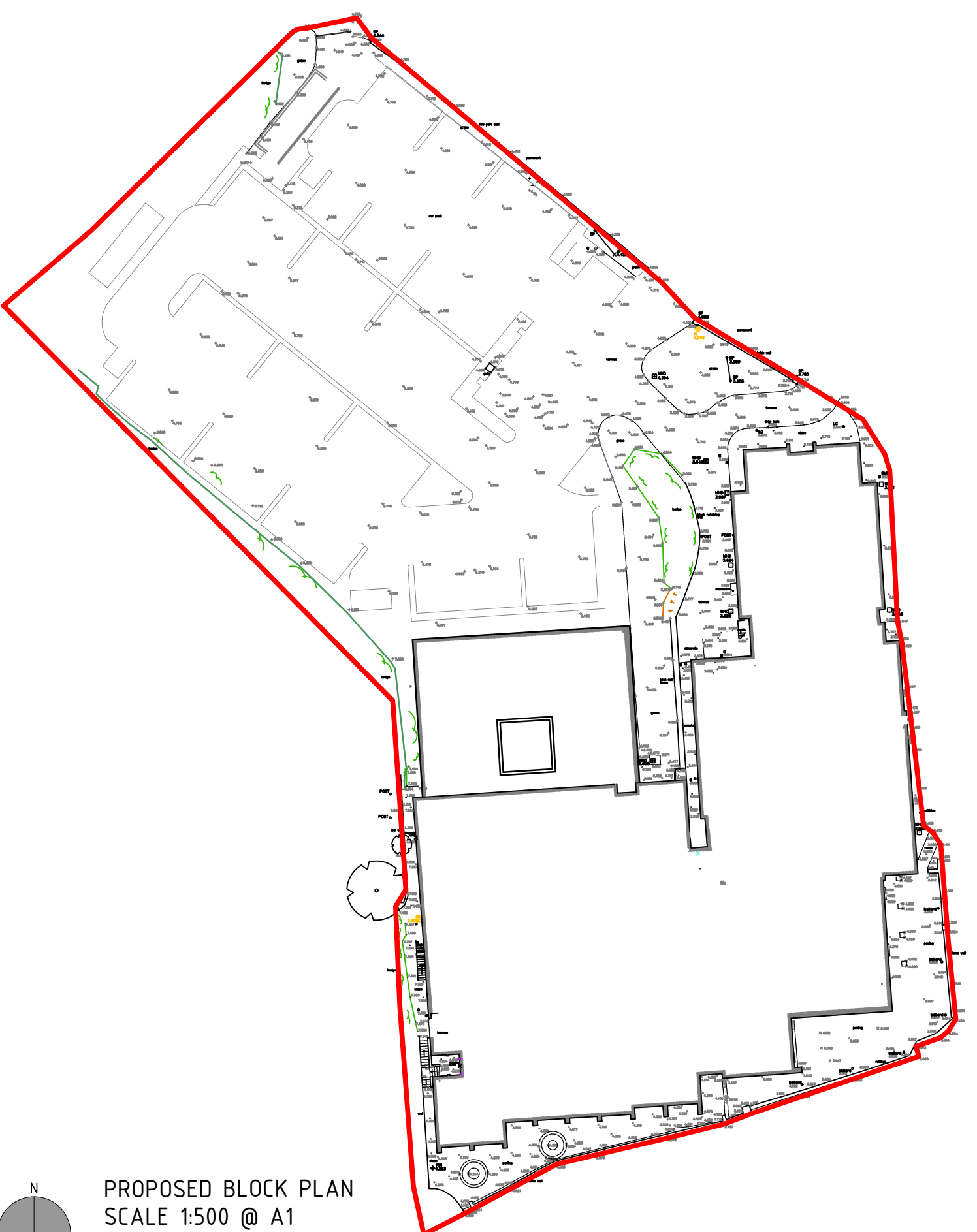

PROPOSED BLOCK PLAN  
SCALE 1:500 @ A1  
0 5 10 15 20 25 METRES

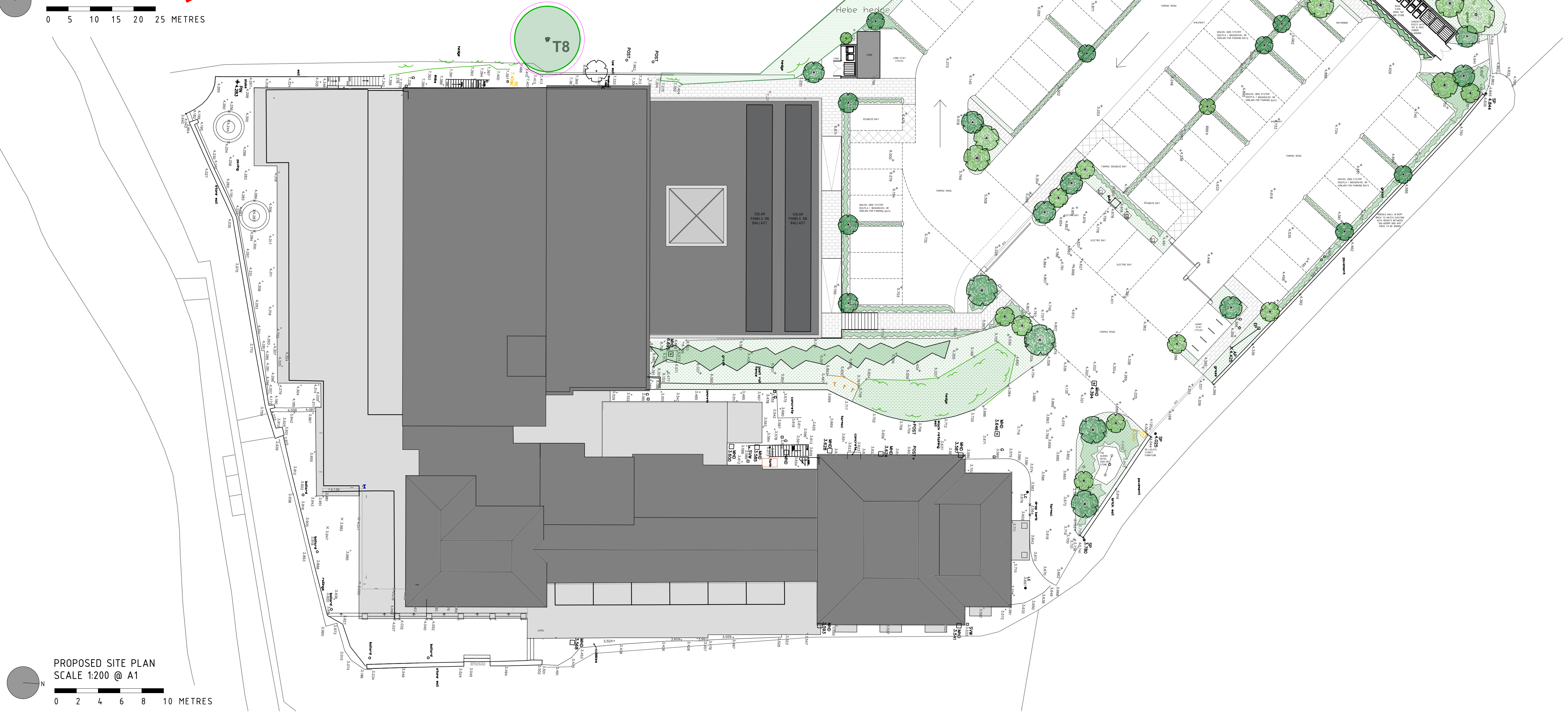

PROPOSED SITE PLAN  
SCALE 1:200 @ A1  
0 2 4 6 8 10 METRES