

NOTES:-

Any discrepancies should be reported immediately

All dimensions should be checked on site prior to commencement of work

Site/survey based on ordinance survey information

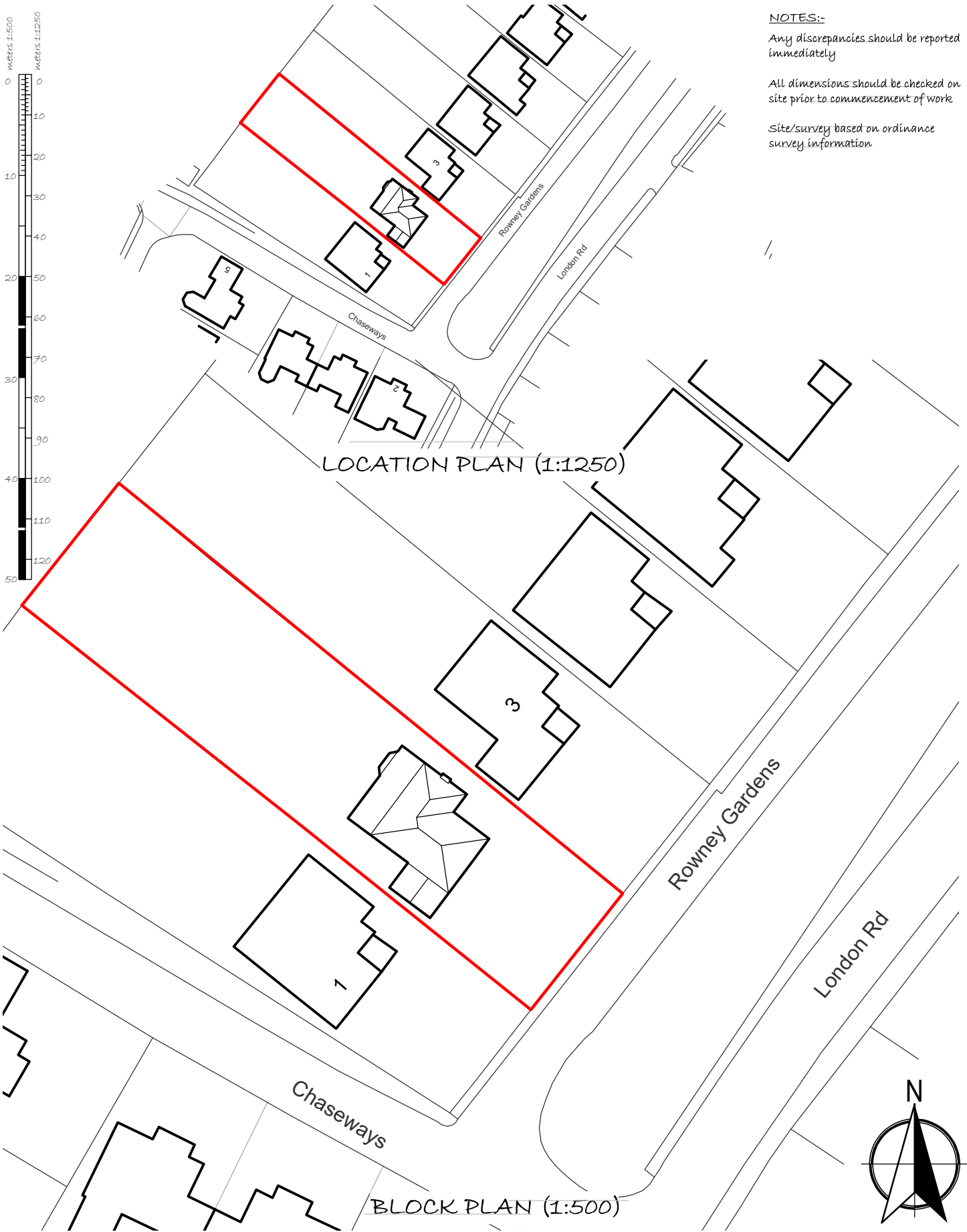

LEGEND:-

	Application site boundary
	Site in applicant's ownership <small>(but not included as part of application)</small>
	Existing building

New World Architectural

Ecological Building Solutions

Sucklings Yard, Church Street, Ware, Hertfordshire, SG12 9EN

• Tel: 07771 538948 • Email: info@newworldarchitectural.com •

TITLE: 2 ROWNEY GARDENS, SAWBRIDGEWORTH, CM21 0AT	
EXIST. BLOCK AND LOCATION PLANS	
DWG REF: NWA-24-006-LOC_E	REV: -
SCALE: As stated	DATE: 15-02-2024
DRAWN: N.COOK	