

Front Elevation

New replacement shopfront - Silver finish to new double glazed aluminum frame incorporating a single glass door. Glazing - 12mm thick toughened safety glass in accordance with BSEN 12150C

Existing aluminum framed double glazed door & frame to be re-used in new opening to provide access to the upper floor flats.

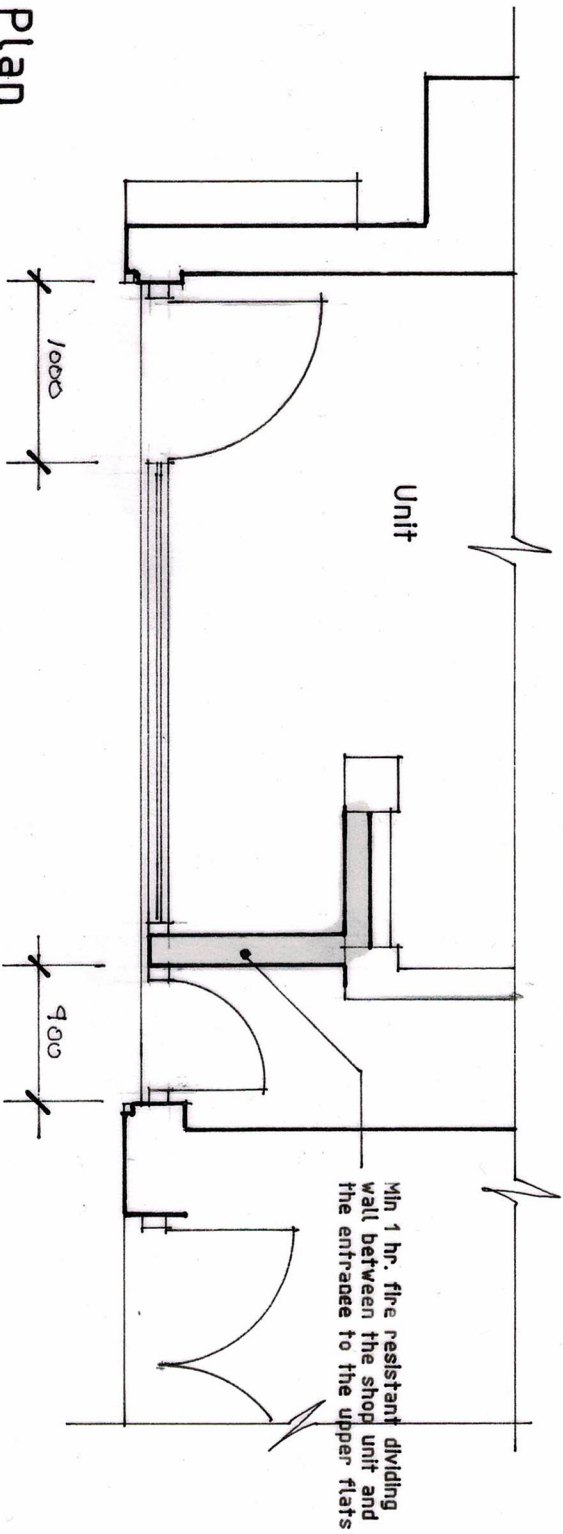

Plan

Min 1 hr. fire resistant dividing wall between the shop unit and the entrance to the upper flats



CLIENT Mr A Ram
 JOB Proposed New Shopfront
 1 Queens Parade
 Basingstoke
 Hants
 RG21 7DA

Leo Mulkerms Architects Limited
 Netheredge, 23 Pardown,
 East Oakley, Basingstoke, Hants RG23 7DY
 Telephone/Fax 01256 783448

DWG Proposed Layout and Front Elevation

DATE Feb 24

SCALE 1:50

DRAWN LMM

JOB 2314

DWG 02

REV