



- GENERAL NOTES:**
1. This drawing is copyright © and remains the property of KEY
 2. Any discrepancies in dimensions or details between the various drawings should be reported immediately.
 3. The drawings are for information only and are not to be used for construction without the written consent of KEY.
 4. The builder and any other contractor employed to undertake the works described shall ensure the stability of the existing and the new structure at all times.

Rev	Note	Date

PO Box 997
 Northgate
 Stratford-upon-Avon CV34 4NY
 Tel: 01583 818152
 www.keyarchitecturaldesign.co.uk
 www.keyplanning.co.uk

KEY
 architectural design ltd
 architecture, design, planning, project management

Client: **Alpack Limited**
 Project: **Proposed Change of Use to Storage Units, Planning Use Class B8 at Oak Tree Farm, Drayton Bassett, B78 3EF**
 Drawing: **Existing Site Plan**

ISSUED BY:	PROJECT NO.:	REV
1:250 @A1	DKT	23-125
CHECKED BY:	DATE:	
DKT	10/11/23	P02

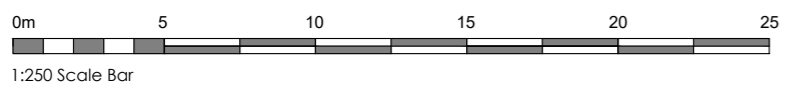
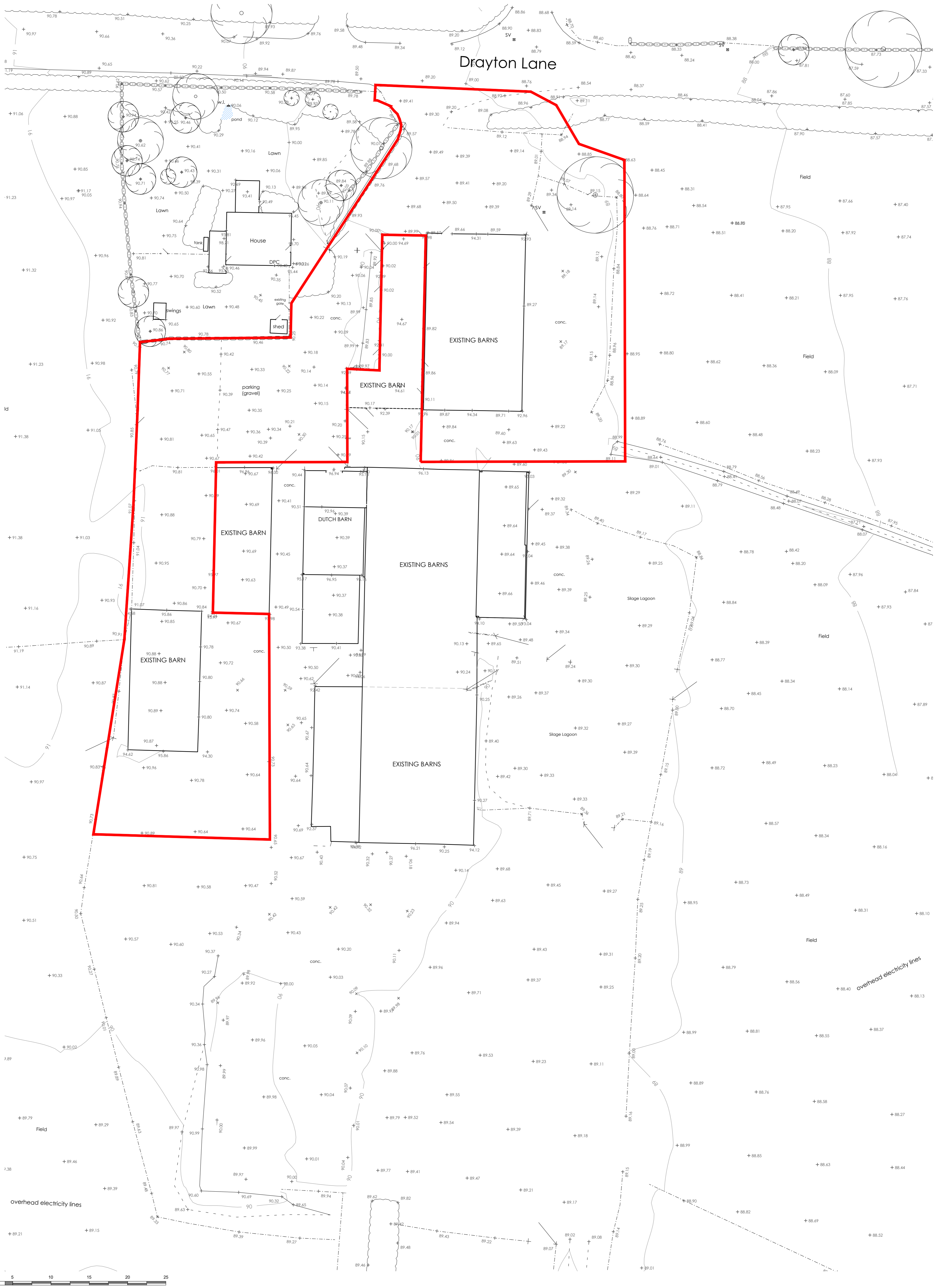

Existing Site Plan