



Glendurgan Front Gate

October 2023



 National Trust

COOKSON & TICKNER
LANDSCAPE ARCHITECTURE

Table of Contents

- 1. Introduction & designations _____ Page 1
- 2. Site location _____ Page 2
- 3. Site analysis _____ Page 3
- 4. Outline proposal _____ Page 6

1. Introduction

The National Trust are seeking pre-application advice on the possible rearrangement of the front gate at Glendurgan as the current entrance is very narrow and sightlines from vehicles exiting this entrance are severely restricted.

The front gates provide private access to Glendurgan House for the donor family. This entrance is not used by visitors to the National Trust Garden.

The site location is shown on drawing *CT193.01.location plan* included in this pre-application request.

Designations

Glendurgan is included at Grade II in the Register of Historic Parks and Gardens of Special Historic Interest (List entry 1000649; first listed 11 June 1987). The site is not within close proximity to a listed building.

The entrance forms part of a 19th century approach to the undesignated Glendurgan House.

The List entry describes the entrance in question as follows:

'The C19 entrance to Glendurgan House is situated c 200m south-west of the late C20 visitors' entrance on the minor road to the north of the site. The entrance comprises an ornamental mid or late C19 timber and cast-iron gate with three cast-iron floral motifs in the upper section above vertical rails and saltire stretchers in the lower section. The gate is supported and flanked by a pair of obelisk-shaped granite piers which are in turn flanked by quadrant stone walls. To east and west of the entrance the walls support a pair of white-painted metal running foxes. The entrance leads to a gravelled drive which sweeps south and south-east through mixed ornamental shrubbery and specimen trees planted on lawns, before turning west to approach the carriage court on the east side of the House. A service drive continues round the north side of the House to reach the service quarters to the north-west, and the stables c 80m west of the House. The C19 stables have been

2. Site Location

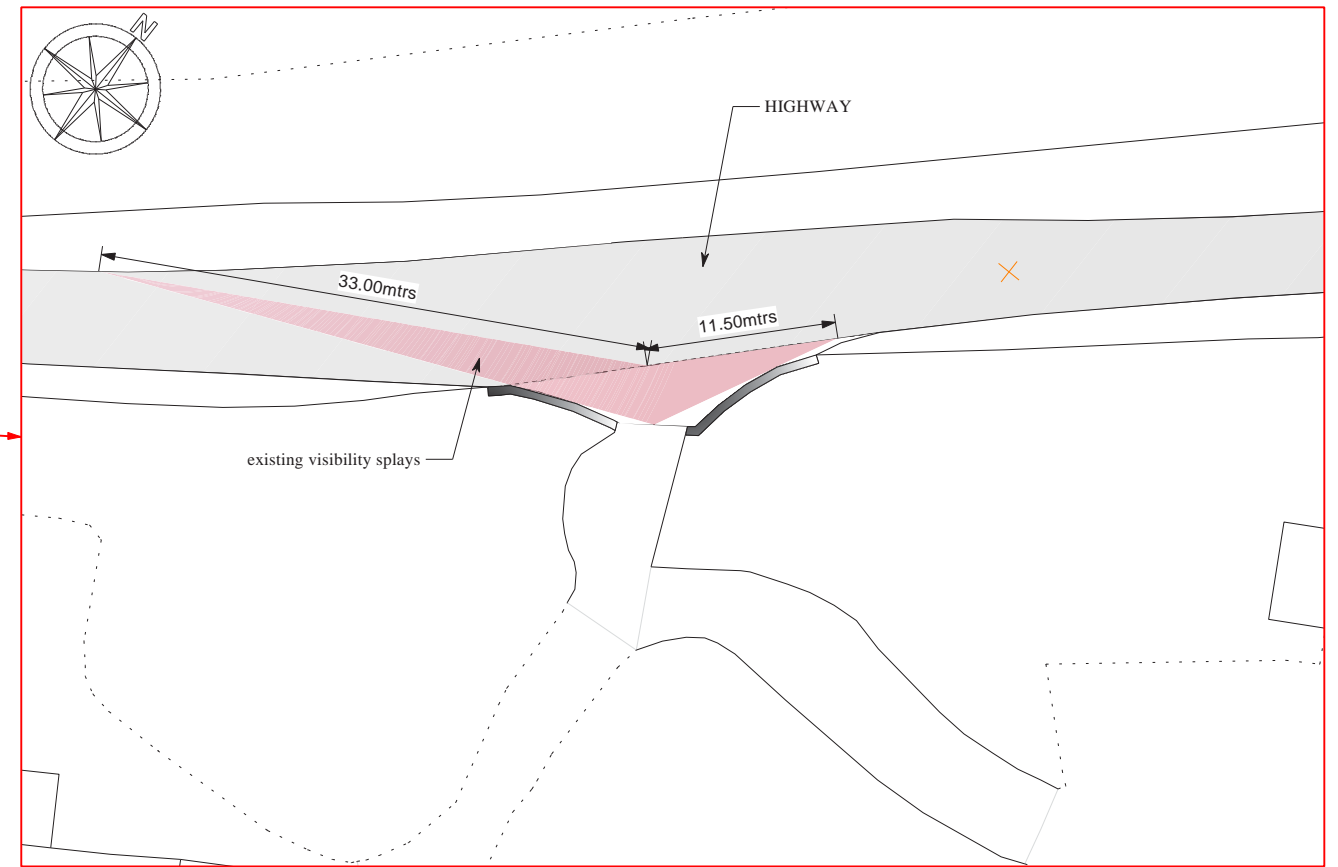
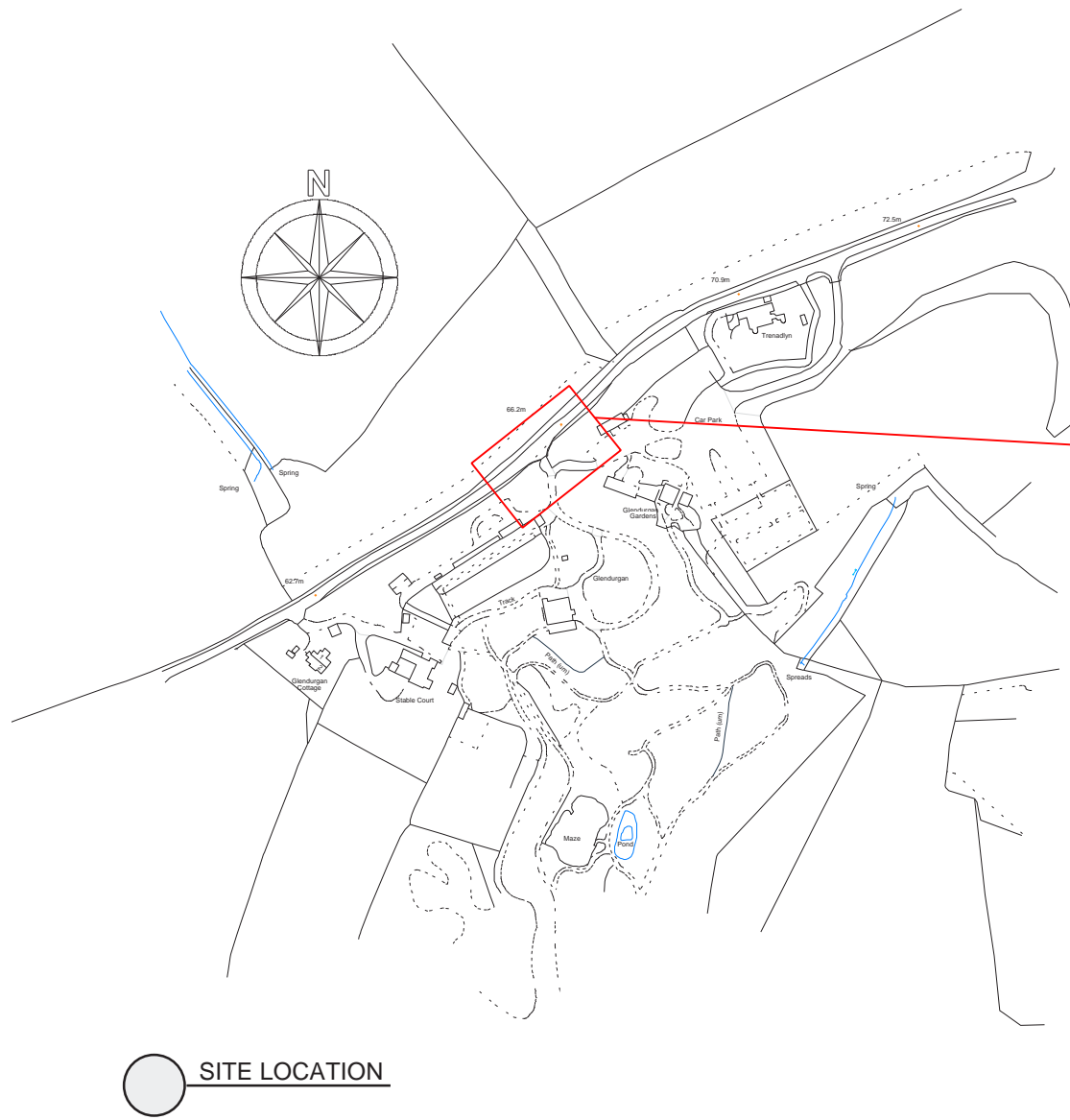

● EXISTING VISIBILITY SPLAY

Please see full sized A1 scale plan CT193.02, in attached documents

3. Site analysis

Historic and current mapping

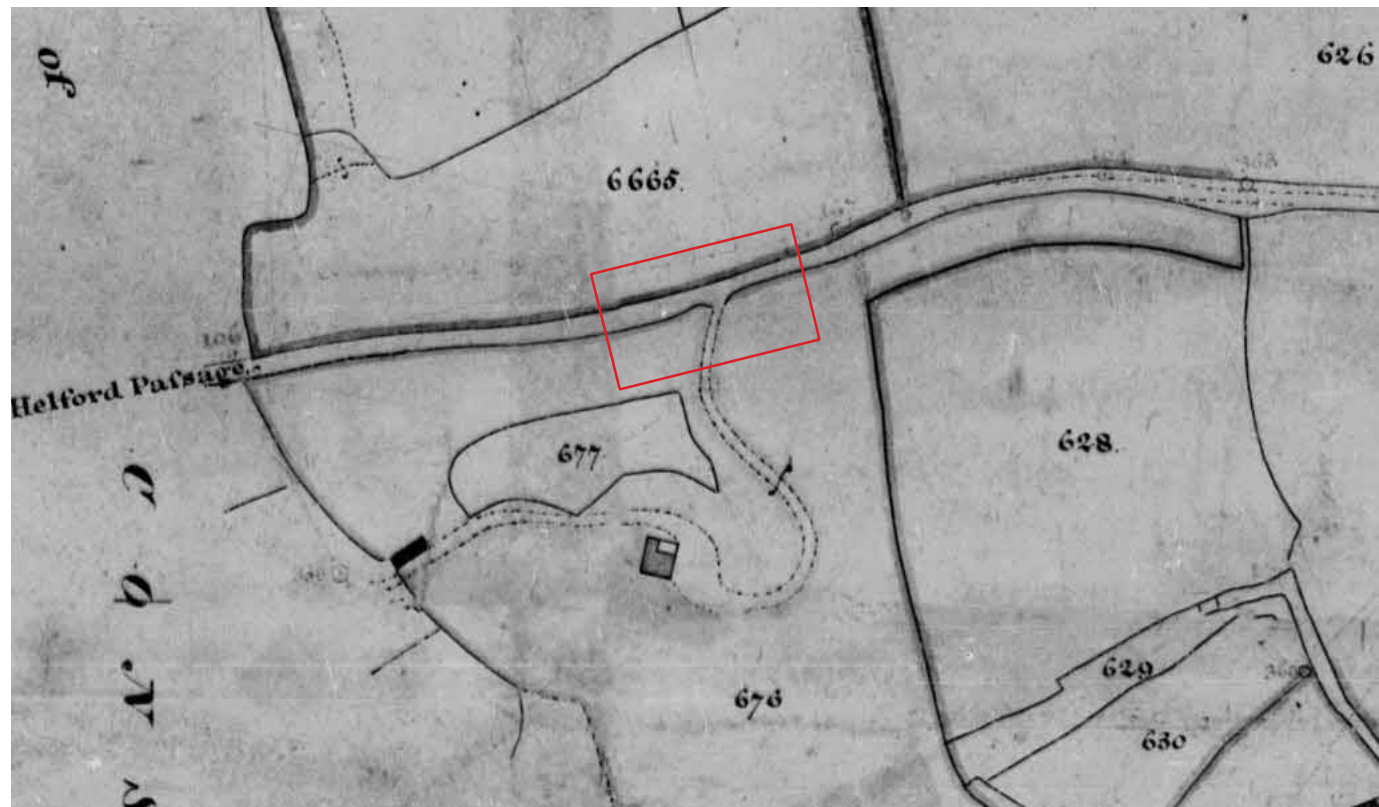

Tithe map showing Glen Durgan, 6th April 1839



2nd Edition Ordnance Survey map 1906, published 1908

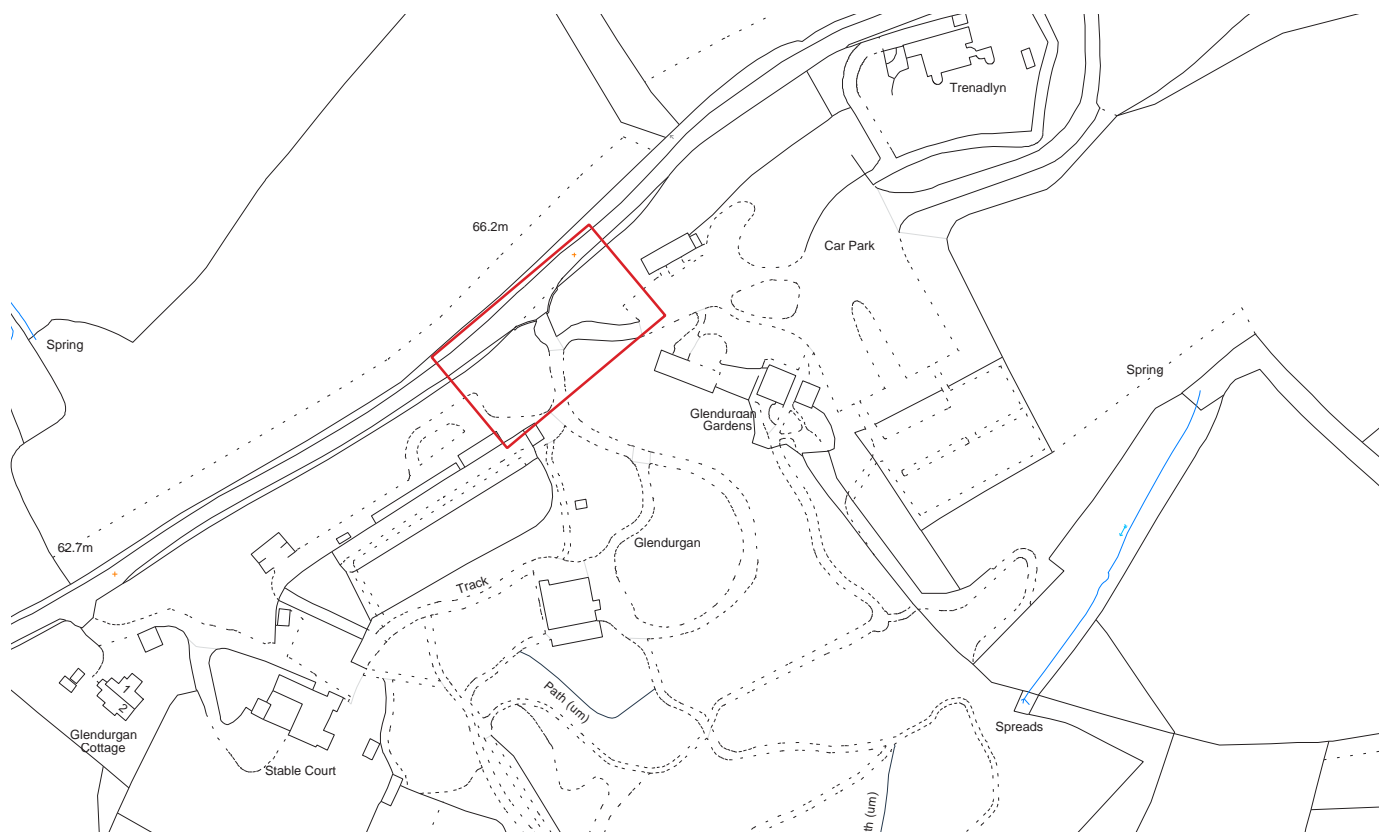

Present day Ordnance Survey mastermap indicates the existing gateway and drive to Glendurgan House



Present day aerial view

Photographs of existing gateway visual splay

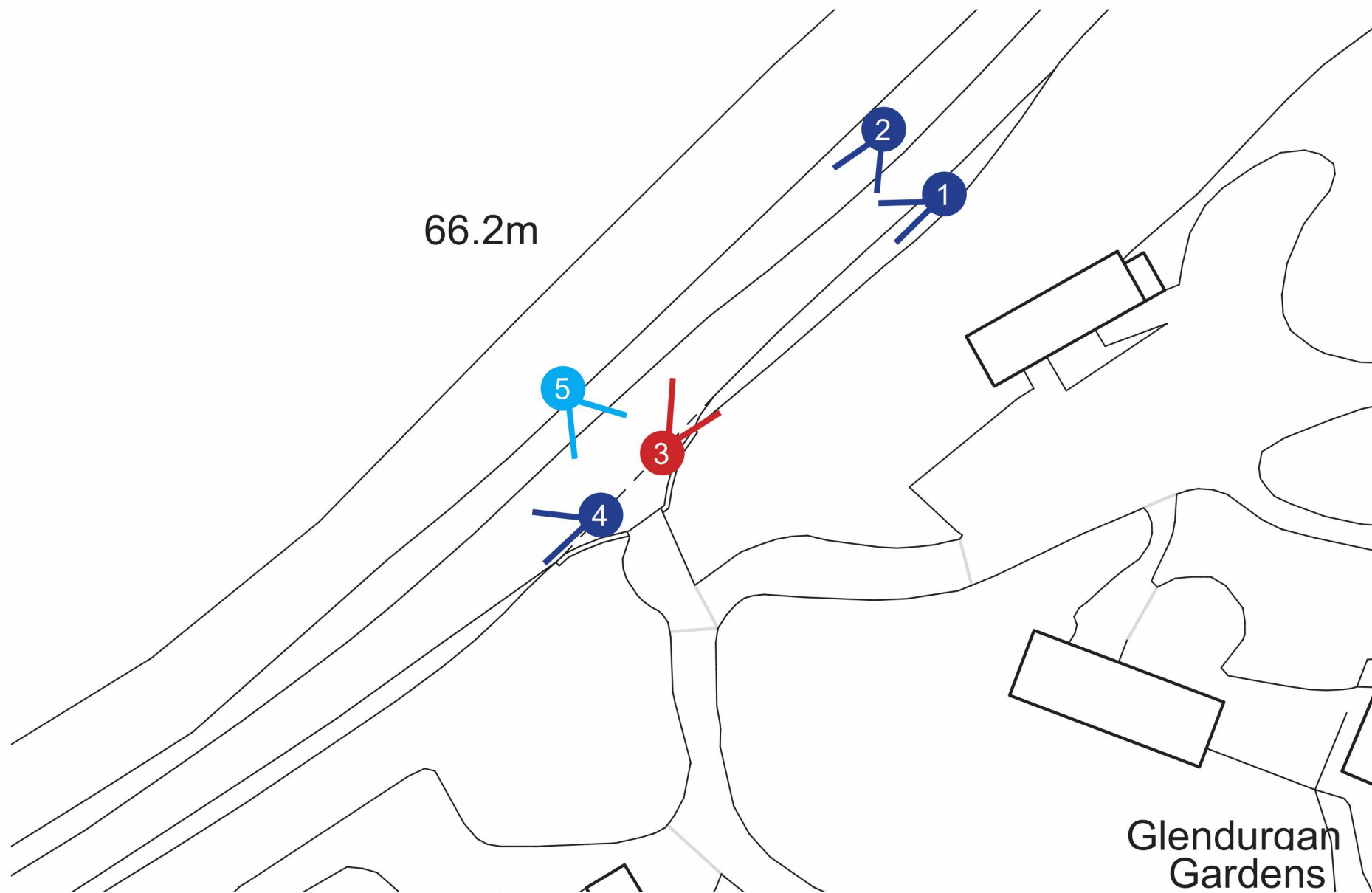

Glendurgan: front gates

Historic fabric

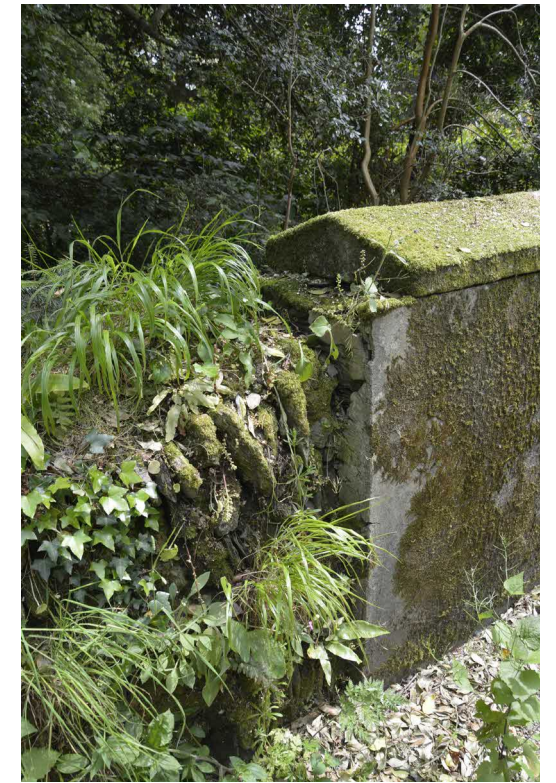

4. Outline proposal

converted in the C20 to domestic use, and are in separate ownership.'

Drawing *CT193.02* shows a possible approach to the rearrangement of the front gate which involves relocating the gateway a short distance back from the highway to increase sightlines and widen the entrance. It would involve the relocation of Cornish hedgebanks and is likely to affect a number of trees. The existing historic fabric, comprising the gate, gateposts and stonework associated with the hedgebanks, would be retained, and relocated.

A small new section of gate to match the existing historic gate would be created to enable the full wider gateway to be closed if required. The new gate leaf could be presented as a pedestrian scale

gate to provide a rationale for this smaller section.

The outline proposal is shown with a 90m visibility splay for discussion and it is expected that ecological and agricultural surveys will further inform the final design, along with feedback from Cornwall Council Highways officers.

The intention is to create a safe point of entrance and exit for the residents and visitors to Glendurgan House that retains its historic fabric and character.

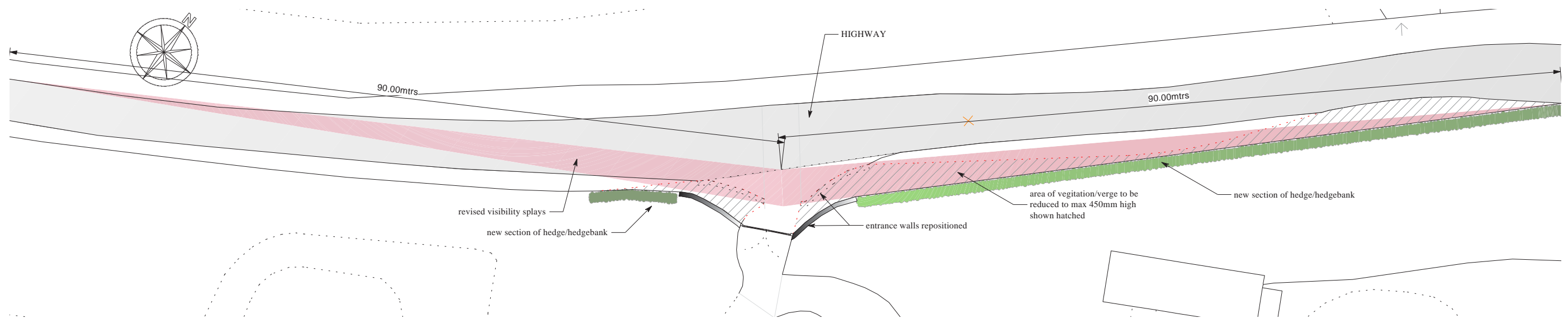

PROPOSED VISIBILITY SPLAY

Please see full sized A1 scale plan *CT193.02*, in attached documents