

Discharge of Condition 6 of Planning Application Ref. 23/02421/HOU

Bat Box Specification

Bat Box: Schwegler 2F Bat Box

Link to chosen Bat Box: https://www.arkwildlife.co.uk/product/schwegler-2f-bat-box/?gad_source=1&gclid=CjwKCAiA75itBhA6EiwAkho9e8NG4ImbofzGu3ykucvlgN8IF8CaaCqFmotiD_Eii8Ff5snf3t-fcRoChFcQAvD_BwE



This chosen bat box is in line with the recommended Bat Box as per the submitted Ecological Assessment which accompanied the application.

The Bat box is to be located at a minimum of 4 meters from the ground on the southwest facing side of the trunk. This tree has been chosen as it has a clear flight path and uncluttered lower branches.

The ivy will be substantially cut away around the box to ensure the entrance does not become overgrown.

Location of Proposed Bat Box

The map and images below show the location of the proposed bat box and the tree on which it will be situated.

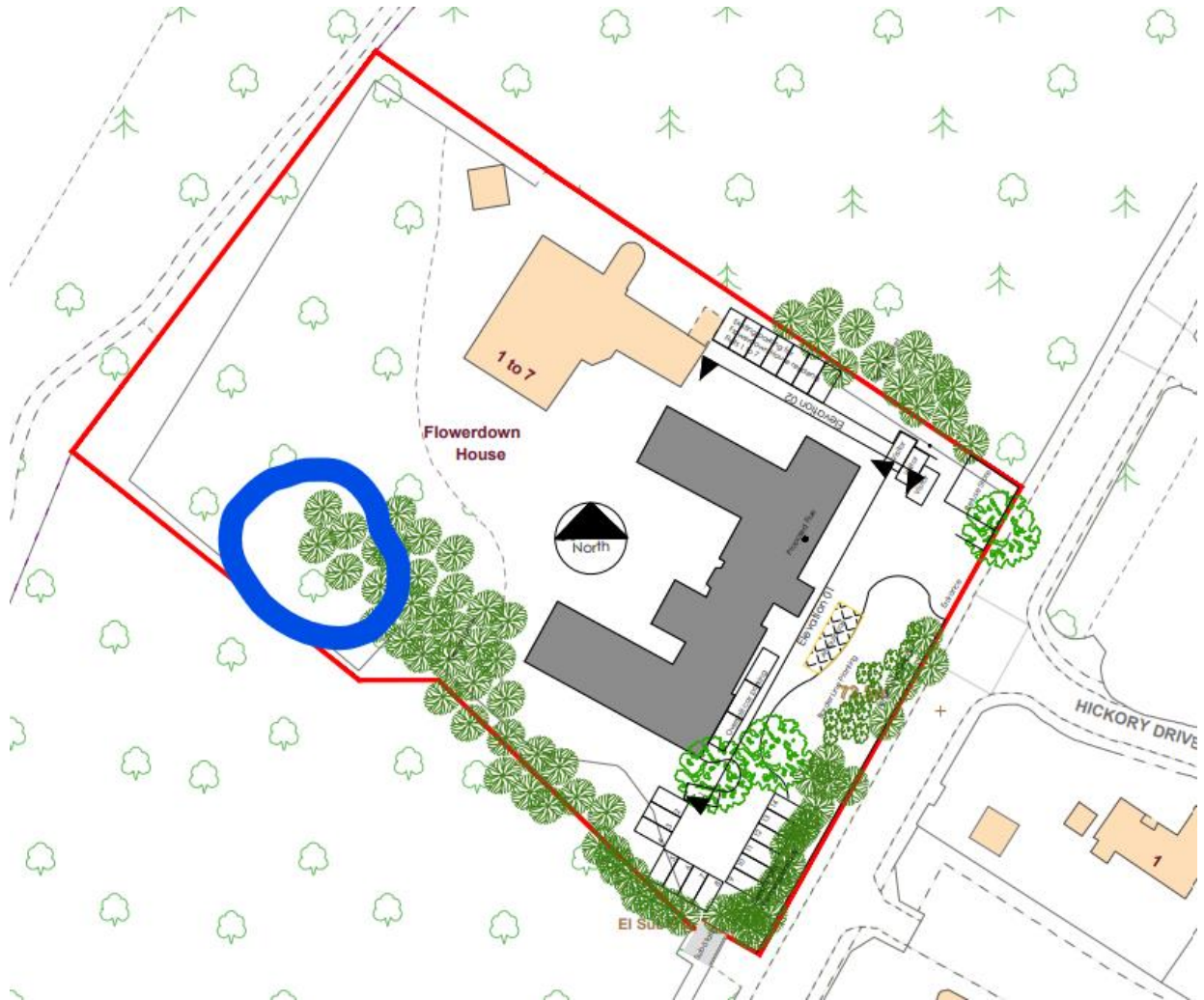

Site plan – Marking the location of the proposed tree



Proposed Location of Bat Box



Proposed Location of Bat Box