

## *ARCHITECTURAL DESIGN*

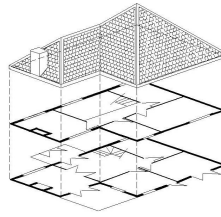

01730 268719

07878 068787

[nmarchitectural@outlook.com](mailto:nmarchitectural@outlook.com)

Saxon End

Bordean

Petersfield

Hampshire

GU32 1EP

Planning Department  
Test Valley Council  
Andover

To whom it may concern,

### **RE: HIGH CROFT, VILLAGE STREET, CHILBOLTON, SO20 6BA**

#### **Alteration of surface finish to existing chimney**

The above property is a typical example of a 1970's bungalow, with low pitch roof and large windows. In keeping with the trend of the time, the original application indicated that the chimney would be clad in stone. However, the stonework was never included by the builder who instead simply erected the chimney in brickwork, stepped back to provide the rake indicated on the drawings.

As a result of rain water accumulating on these steps and then freezing, the brickwork is starting to fracture and spall. As yet, this is simply unsightly, but, if allowed to progress, the water ingress could affect the future integrity of the chimney.

To avoid this my clients propose having the chimney refinished in a specialist render, patterned to mimic buff stonework. This will protect the chimney from further water damage and return its appearance back to that shown on the original approval drawings, all in keeping with the age and vernacular of the property.

Given that the alteration is purely cosmetic and there is no extension to the property, we have not included a biodiversity study, parking plan, flood risk assessment or tree report with this application.

With kind regards

Nicholas Moss